

WORLD EQUESTRIAN CENTER®

INTRODUCING

A SUDDEN IMPULSE

NSBA SHOW AND FUTURITY

April 23rd-May 1st, 2021

Held at the **NEW** World Equestrian Center
198 NW 87TH COURT RD, Ocala FL 34482

Credit: Joni Beinborn

More than **\$360,000** in added prize money

Produced by:
Arena Horse Shows Of Ocala LLC

Managed by:
Peak Equine Productions, LLC.



Quality. Class. Distinction.®

Ocala, FL • wec.net   

WESTERN PLEASURE CLASSES	MONEY ADDED	ENTRY FEE	DATE
3 Year Old Maiden Western Pleasure - 1st Go	\$100,000	\$1,500	4/27
3 Year Old Maiden Western Pleasure - 2nd Go			4/29
3 Year Old Maiden Western Pleasure - Limited Finals			4/30
3 Year Old Maiden Western Pleasure - Open Final			5/1
3 And Over Novice Horse - 1st Go	\$30,000	\$500	4/26
3 And Over Novice Horse - 2nd Go			4/28
3 And Over Novice Horse Western Pleasure - Finals			4/30
3 Year Old Open/Intermediate Western Pleasure	\$10,000	\$250	4/28
3 Year Old Ltd Non-Pro Western Pleasure	\$2,000	\$150	4/24
3 Year Old Nov Horse/Nov Rider Pleasure	\$500	\$50	4/28
3 Year Old Limited Western Pleasure	\$2,000	\$150	4/28
3 Year Old Non-Pro Western Pleasure	\$10,000	\$250	4/30
3 Year Old Intermediate Non-Pro Pleasure	\$2,000	\$150	4/29
Maturity Intermediate Non-Pro Western Pleasure	\$2,000	\$150	4/28
Maturity \$5,000 Limited Horse Pleasure	\$2,000	\$150	4/30
Maturity \$10,000 Limited Horse Pleasure	\$2,000	\$150	4/29
Maturity Limited Open Western Pleasure	\$5,000	\$200	5/1
Maturity Open/Intermediate Western Pleasure	\$5,000	\$200	4/27
Maturity Novice/Novice Western Pleasure	\$1,000	\$75	4/23
Maturity \$10,000 Ltd Horse Non-Pro Pleasure	\$5,000	\$200	4/25
Maturity Non-Pro Pleasure	\$2,000	\$150	5/1
Maturity Limited Non-Pro Western Pleasure	\$2,000	\$150	4/29
Maturity \$5,000 Ltd Horse Non-Pro Pleasure	\$2,000	\$150	4/30
Youth Western Pleasure 14-18	\$10,000	\$75	4/30
Youth Western Pleasure 13+ Under	\$7,500	\$50	5/1
50+ Over Non-Pro Western Pleasure	\$2,000	\$150	4/25
Novice Non-Pro Western Pleasure	\$1,000	\$75	4/28
Green Western Pleasure	\$1,000	\$45	4/23
Select Amateur Western Pleasure	\$500	\$45	4/23
Amateur Western Pleasure	\$500	\$45	4/23
Youth Color Western Pleasure	\$250	\$45	4/23
Junior Western Pleasure	\$500	\$45	4/24
Novice Youth Western Pleasure	\$500	\$45	4/24
Novice Amateur Western Pleasure	\$500	\$45	4/24
Color Breed Non-Pro Western Pleasure	\$500	\$50	4/24
Youth Western Pleasure 13+Under	\$500	\$45	4/28
Youth Western Pleasure 14-18	\$500	\$45	4/28
Color Breed Open Western Pleasure	\$500	\$50	4/28
Senior Western Pleasure	\$500	\$45	4/28

HUNTER UNDER SADDLE CLASSES	MONEY ADDED	ENTRY FEE	DATE
3 Year Old Maiden Hunter under Saddle - 1st Go	\$15,000	\$300	4/26
3 Year Old Maiden Hunter under Saddle - 2nd Go			4/28
3 Year Old Maiden Hunter under Saddle - Limited Finals			4/30
3 Year Old Maiden Hunter under Saddle - Open Finals			5/1
3 Year Old Open Hunter Under Saddle	\$2,000	\$150	4/26
3 Year Old Non-Pro Hunter Under Saddle	\$2,000	\$150	4/27
3 Year Old Novice Horse Hunter Under Saddle	\$2,000	\$150	4/28
3 Year Old Nov Horse/Nov Rider HUS	\$500	\$50	4/25
3 Year Old Limited Open Hunter Under Saddle	\$2,000	\$150	4/29
Maturity Nov Horse/Nov Rider HUS	\$500	\$50	4/27
Maturity Non-Pro Hunter Under Saddle	\$1,000	\$75	4/28
Maturity Open Hunter Under Saddle	\$2,000	\$150	4/27
Maturity \$2,500 Ltd Horse Hunter under Saddle	\$2,000	\$150	4/28
Youth 13+ Under Hunter Under Saddle	\$7,500	\$50	4/30
Youth Hunter Under Saddle 14-18	\$10,000	\$75	5/1
Green Hunter Under Saddle	\$1,000	\$45	4/24
Amateur Hunter Under Saddle	\$500	\$45	4/24
Select Amateur Hunter Under Saddle	\$500	\$45	4/24
Junior Hunter Under Saddle	\$1,000	\$45	4/26
Senior Hunter Under Saddle	\$1,000	\$45	4/26
Novice Youth Hunter Under Saddle	\$500	\$45	4/26
Novice Amateur Hunter Under Saddle	\$500	\$45	4/26
Youth Hunter Under Saddle	\$500	\$45	4/27
50+ Over Non-Pro Hunter Under Saddle	\$500	\$50	4/27

HUNT SEAT EQUITATION CLASSES	MONEY ADDED	ENTRY FEE	DATE
Novice Youth Equitation	\$500	\$45	4/24
Youth Equitation 13 And Under	\$250	\$45	4/28
Youth Equitation 14-18	\$250	\$45	4/28
Novice Amateur Equitation	\$500	\$45	4/28
Select Amateur Equitation	\$500	\$45	4/28
Amateur Equitation	\$500	\$45	4/28

TRAIL CLASSES	MONEY ADDED	ENTRY FEE	DATE
Three Year Old Open Trail	\$2,000	\$150	4/23
Three Year Old Limited Trail	\$2,000	\$150	4/30
4+ Over Maiden Trail	\$15,000	\$300	4/24
4/5 Year Old Non-Pro Trail	\$2,000	\$150	4/25
4/5 Year Old Limited Open Trail	\$2,000	\$150	4/27
4/5 Year Old Open Trail	\$2,000	\$150	4/30
Six and Over Non-Pro Trail	\$1,000	\$75	4/25
Limited Non-Pro Trail	\$2,000	\$150	4/30
Color Green Trail	Jackpot	\$45	4/23
Color Amateur Trail	Jackpot	\$45	4/23
Select Trail	\$1,000	\$45	4/23
Amateur Trail	\$1,000	\$45	4/28
Green Senior Trail	\$1,000	\$45	4/28
Green Junior Trail	\$1,000	\$45	4/25
Novice Youth Trail	\$1,000	\$45	4/28
Youth Trail	\$1,000	\$45	4/25
Novice Select Trail	\$1,000	\$45	4/26
Novice Amateur Trail	\$1,000	\$45	4/26
Junior Trail	\$5,000	\$200	4/26
Green Trail	\$5,000	\$200	4/27
Senior Trail	\$5,000	\$200	4/29

WESTERN RIDING CLASSES	MONEY ADDED	ENTRY FEE	DATE
Green Western Riding	\$1,000	\$45	4/25
Novice Youth Western Riding	\$250	\$45	4/26
Select Amateur Western Riding	\$250	\$45	4/26
Amateur Western Riding	\$250	\$45	4/26
Junior Western Riding	\$250	\$45	4/27
Youth Western Riding	\$250	\$45	4/27
Senior Western Riding	\$250	\$45	4/28
Novice Select Western Riding	\$250	\$45	4/28
Novice Amateur Western Riding	\$250	\$45	4/28

WORKING HUNTER CLASSES	MONEY ADDED	ENTRY FEE	DATE
Hunter Derby	\$5,000	\$250	4/24
Novice Youth Working Hunter	\$1,000	\$45	4/23
Green Working Hunter	\$1,000	\$45	4/23
Progressive Working Hunter	\$1,000	\$45	4/23
Open Working Hunter	\$1,000	\$45	4/26
Youth Working Hunter	\$1,000	\$45	4/26
Novice Amateur Working Hunter	\$1,000	\$45	4/26
Amateur Working Hunter	\$1,000	\$45	4/26
HUNTER HACK CLASSES	MONEY ADDED	ENTRY FEE	DATE
Junior Hunter Hack	\$1,000	\$45	4/25
Senior Hunter Hack	\$1,000	\$45	4/25
Novice Youth Hunter Hack	\$1,000	\$45	4/25
Youth Hunter Hack	\$1,000	\$45	4/25
Novice Amateur Hunter Hack	\$1,000	\$45	4/25
Amateur Hunter Hack	\$1,000	\$45	4/25
EQUITATION OVER FENCES CLASSES	MONEY ADDED	ENTRY FEE	DATE
Novice Youth Equitation Over Fences	\$500	\$45	4/23
Novice Amateur Equitation Over Fences	\$500	\$45	4/23
Youth Equitation Over Fences	\$500	\$45	4/26
Amateur Equitation Over Fences	\$500	\$45	4/26
PLEASURE DRIVING CLASSES	MONEY ADDED	ENTRY FEE	DATE
Amateur Pleasure Driving	\$500	\$45	4/30
Open Pleasure Driving	\$500	\$45	4/30
RANCH RIDING CLASSES	MONEY ADDED	ENTRY FEE	DATE
Youth Ranch Riding	\$5,000	\$45	4/24
Select Amateur Ranch Riding	\$1,000	\$45	4/24
Amateur Ranch Riding	\$1,000	\$45	4/24
Senior Ranch Riding	\$2,000	\$150	4/24
Green Ranch Riding	\$2,000	\$150	4/25
Junior Ranch Riding	\$2,000	\$150	4/25
Novice Amateur Ranch Riding	\$500	\$45	4/26
Novice Youth Ranch Riding	\$500	\$45	4/26

RANCH RAIL CLASSES	MONEY ADDED	ENTRY FEE	DATE
Non-Pro Ranch Rail	\$500	\$45	4/26
Junior Ranch Rail	\$500	\$45	4/26
Senior Ranch Rail	\$500	\$45	4/26

RANCH TRAIL CLASSES	MONEY ADDED	ENTRY FEE	DATE
Green Ranch Trail	\$500	\$45	4/24
Junior Ranch Trail	\$500	\$45	4/24
Novice Youth Ranch Trail	\$500	\$45	4/24
Novice Amateur Ranch Trail	\$500	\$45	4/24
Youth Ranch Trail	\$500	\$45	4/27
Select Amateur Ranch Trail	\$500	\$45	4/27
Amateur Ranch Trail	\$500	\$45	4/27
Senior Ranch Trail	\$500	\$45	4/27

WESTERN HORSEMANSHIP CLASSES	MONEY ADDED	ENTRY FEE	DATE
Novice Youth Horsemanship	\$500	\$45	4/25
Novice Amateur Horsemanship	\$500	\$45	4/25
13 Under Youth Horsemanship	\$250	\$45	4/29
14-18 Youth Horsemanship	\$250	\$45	4/29
Select Amateur Horsemanship	\$250	\$45	4/29
Amateur Horsemanship	\$500	\$45	4/29

SHOWMANSHIP CLASSES	MONEY ADDED	ENTRY FEE	DATE
Novice Youth Showmanship	\$250	\$45	4/23
Novice Amateur Showmanship	\$250	\$45	4/23
Youth 13 And Under Showmanship	\$250	\$45	4/27
Select Amateur Showmanship	\$500	\$45	4/27
Amateur Showmanship	\$500	\$45	4/27
Youth 14-18 Showmanship	\$250	\$45	4/27

PERFORMANCE HALTER CLASSES	MONEY ADDED	ENTRY FEE	DATE
Performance Halter Open Mares	\$250	\$45	4/30
Performance Halter Amateur Mares	\$250	\$45	4/30
Performance Halter Open Geldings	\$250	\$45	4/30
Performance Halter Amateur Geldings	\$250	\$45	4/30
Performance Halter Open Stallions	\$250	\$45	4/30
Performance Halter Amateur Stallions	\$250	\$45	4/30
Youth Performance Mares	\$250	\$45	5/1
Youth Halter Performance Gelding	\$250	\$45	5/1

YOUTH WALK TROT AND LEADLINE CLASSES	PRIZES	DATE
Youth Walk Trot Western Pleasure 9+ Under	Toys	4/23
Walk Trot Youth Trail	Jackpot	4/24
Youth Walk Trot Horsemanship	Toys	4/25
Youth Walk Trot Hunter Under Saddle 9+ Under	Toys	4/26
Youth Walk Trot Hseq 9+ Under	Toys	4/26
Youth Walk Trot 9+ Under	Prizes	5/1
Lead Line 9+ Under (No Other Riding Class)	Prizes	5/1

GENERAL RULES

Registration - All horses must be registered with NSBA

Membership - An NSBA membership is required for each owner and exhibitor entering in NSBA classes. It is the sole responsibility of the owner/exhibitor to be a current member. If a registered owner consists of two or more people, or a company or partnership name, then it is required that a membership be recorded in the exact name of the registration papers. If an exhibitor is one of these registered owners, the exhibitor must hold a separate and individual membership as well.

Entries

- To Enter go to: www.Peak-Equine.com
- Entries will be accepted on-line or by mail between January 1st and April 5th, 2021
- On line Entry Form and Stall Reservation Form will be available on January 1, 2021
- Entry Due by April 1st, 2021
- Payment must be received with entry

Payment

- Payment must be received by April 1st, 2021.
- Class entry fees are list below and/on the entry form.
- All Stalls and entries **MUST** be paid by Credit Card Only
 - payments will be charge 3.0% convenience fee
- Cash or Credit Card information will be taken at the show

Refunds - Refunds will not be given for any reason, except:

- Futurity horses paid in full then dropped before the April 1st deadline will be refunded the remaining sustaining fee. Show management must be notified of the intent to drop the horse before the payment due date to receive the refund.
- If for any reason the event is canceled. All entry money will be refunded.

Substitutions

- If a veterinarian statement is received by show management stating that a horse is no longer able to show, the owner will be allowed to substitute another horse in the class. The substituted horse must be owned by the same person who made the original entry.

NSBA Rules and Regulations

- NSBA rules take precedence for all class and equipment rules
- All horses are subject to drug and/or tail testing
- Guidelines for therapeutic medication follow NSBA rule 107
- No person shall treat any horse in a cruel or inhumane manner, including, but not limited to, the prohibited conduct specified in the NSBA Handbook. Cruelty to horses included in this prohibition, as it indicates a general course of dealing with horses that is unacceptable.
- Every horse shall always be treated humanely and with dignity, respect, and compassion. Abuse is defined as an action, or failure to act, which a reasonable, prudent person, informed and experienced in the customs, accepted training techniques and exhibition procedures, or veterinary standards would determine to be cruel, abusive, inhumane or detrimental to the horses' health.
- All horses entered are required to pay NSBA Drug Fee

Final Decision - Decisions of the judges will be final

Disputes

- Any dispute as to the operation of classes, matters of protocol, procedures in drug testing, show management issues and all other issues shall be decided by the show manager in consultation with show producers. The show manager's decision shall be final and considered acceptable to all exhibitors.

Scoring

Each judges' score card will be counted and totaled as follows:

- The first-place winner under each judge will receive one point, the second-place horse under each judge will receive two points etc., with gated horses receiving one more point than the last placed horse. Points for each horse will be totaled and the horses having the least number of points will be the overall winners.
- In single go round classes with \$5,000 or less added the scores from three judges will be averaged for one overall placing.
- NSBA points will be awarded based on the placings under each individual judge

Payback

- Payback will follow the NSBA schedule of payback percentages to pay places for finals and totals.
- The number of places paid is based on the number of fully paid entries, and not the number of horses shown.
- Jackpot Classes
 - All entry fees will be added to the jackpot
- Added Money Classes
 - The total purse for the class is the total amount added plus a portion of the entry fees collected paid back to all money winners.
 - 55% of all paid entries will be added to the guaranteed money list for each class

Ties

- In the event of a tie, the monies for the placing involved will be totaled and divided equally among those that are tied.
- In the event of a tie in any final placing, a predetermined tie breaker judge must be used to determine the awarding of ribbons, buckles, trophies, saddles and other prizes.

Go-Rounds and Finals

- There will be two go-rounds, plus a final for the Open division and a final for the Limited Division. The top 12 placings in the first go-round and the second round of futurity classes will be eligible for the Open finals. Top 12 limited rider in each go-round will be eligible for the Limited Open finals. Entries placing 12th or above in the first go-round are not eligible to show in the second go-round. Entries placing below 12th may show in the second go-round, if they wish.

Limited Division

- All entries with eligible riders will automatically be entered in the Limited Open or Limited Non-Pro division in the Three-Year-Old Western Pleasure Maiden and Three-Year-Old Maiden Hunter Under Saddle Classes. No Additional payment for the Limited division is required.

Futurity Judges

- Classes with \$5,000-\$10,000 will be judged by four judges with the low score on each exhibitor dropped and 3 remaining judge's scores are averaged for one overall placing.
- In classes \$15,000 or more added will be judged by five judges whether a single or multiple go round class. In each go round and the finals, the high and low score on each exhibitor is dropped and 3 remaining judge's scores are averaged for one overall placing.

FOR MORE INFORMATION, ENTRY FORMS
AND STALL RESERVATIONS GO TO:

PEAK-EQUINE.COM



Stabling

The stalls are very spacious, measuring 12×14 and 12×12, and come equipped with matted floors.

Cost

• Horse and Tack Stalls are \$300 for the circuit

- Stalls reserved after April 1, 2021 are \$350 for the circuit
- Full payment is required to reserve stalls. Credit cards will be deposited upon receipt.
- All stall reservations must be filed under ONE stall agent and paid the same day to be stalled as a group.

Deadline

- Stall reservations made before April 1, 2021 receive priority
- Reservations will be accepted up to April 22, 2021. We will continue to accept reservations until all stalls are sold.

Stall will be assigned based on

- Sponsorship level
- Date received
- Number of stalls reserved

Cancellations

- Stall(s) canceled by April 1, 2021 will receive a full refund minus processing fee
- Cancellations made between April 1-18, 2021 will be charged a 25% fee
- No refund for cancellations after April 18th, 2021

Shavings

- Shavings are \$8.50/bag
- Order on-line. Preorders are preferred for your convenience at move in
- No outside shavings

Subletting

- Selling stalls is discouraged. The World Equestrian Center has over 2,000 stalls
- Notify Show Management of any stalls that are not needed
- Show management may approve refund if vacant stalls are filled by another party

Move in

- Stall move in begins on Tuesday, April 20th, 2021 at 8:00 AM.



Departure

- Horses must be removed from the premises by May 3rd at 12:00 PM (noon) unless special arrangement have been made with show management. Additional costs may be incurred.

Location

Classes will be held in arenas 1 and 2 with arenas 3 and 4 serving primarily as warm up and schooling arena. The over fences classes will be held outside in designated hunter arena weather permitting. Championship Futurity classes will be held in the World Equestrian Center Arena.

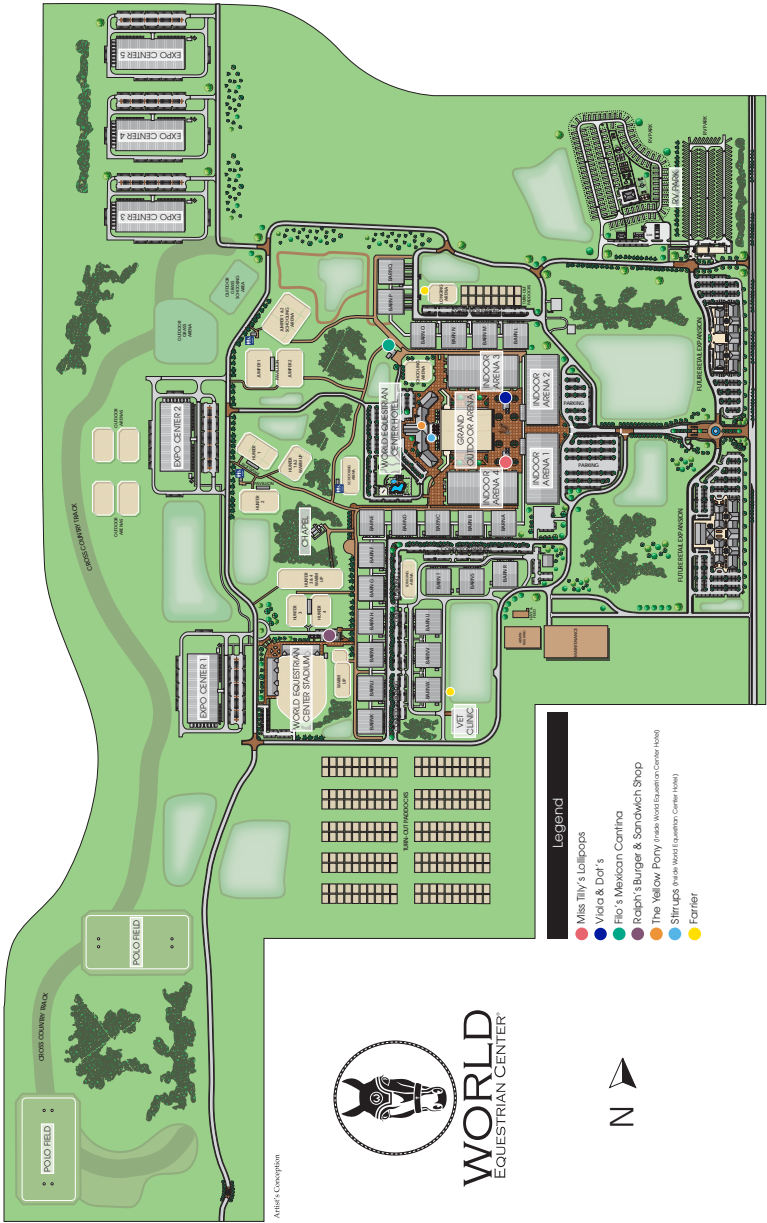

Sponsorship

We offer investment levels for individuals, farms and companies to increase market exposure. We publish a program with patterns, advertise each month in national publications, offer free give-a-ways with sponsor logos to each exhibitor, and recognize our benefactors throughout the event.

- Sponsors receive stalling preference depending on availability and level of sponsorship.
- A free tack stall with every sponsorship of \$10,000 or more is provided.

SPONSORSHIP LEVEL

DIAMOND (\$10,000 Investment) Includes: DESIGNATED AS AN ARENA SPONSOR. Preferred stalling in one of the closest barns to the show arena. Sponsors choice. Stall are assigned by date of payment. Full page color program ad, logo on pre-event advertisement, press release recognition, Digital ads displayed on the Jumbo-tron throughout the day in each arena, hourly promotional announcements per day, choice of barn location for stalls.

PLATINUM (\$5,000 Investment) Includes: DESIGNATED AS FUTURITY SPONSOR, full page color program ad, logo in pre-event advertisement, press release recognition, Digital ads displayed in each arena periodically throughout the day, and 6 promotional announcements per day. Preferred stalls are available after assignment of Diamond Sponsors.

GOLD (\$2,500 Investment) DESIGNATED AS A NSBA CLASS SPONSOR Includes: 1/2 page color program ad, logo in pre-event advertisement, press release recognition, Logo displayed on the digital broads, 4 promotional announcements per day, Preferred stalls after Platinum Sponsors.

SILVER (\$1,500 Investment) DESIGNATED AS A CLASS SPONSOR Includes: 1/2 page color program ad, logo in pre-event advertisement, 3 promotional announcements per day, Next best stalls assigned after Diamond, Platinum and Gold Sponsors.

BRONZE (\$1,000 Investment) DESIGNATED AS A \$1,000 CLASS SPONSOR Includes: 1/4 page color program ad, name listed on pre-event advertisement, 3 promotional announcements per day, Stalls assigned after Silver Sponsors.

CONTRIBUTOR (\$500 Investment) DESIGNATED AS A \$500 CLASS SPONSOR Includes: 1/4 page B/W program ad, 2 promotional announcements per day, best available stalls.

Please reserve your stalls early by filling out the online stall and separate sponsorship forms. Only paid stalls will be considered reserved. Stalls will be assigned first to our sponsors then on a first come, first serve basis.

RV Camping

We have 2 beautiful campgrounds with 278 RV camping sites as well as several restaurants, laundry mat, gas station, and convenience store on site.

Reserve RV Camping site online: <https://worldequestriancenter.com/ocala-fl/>

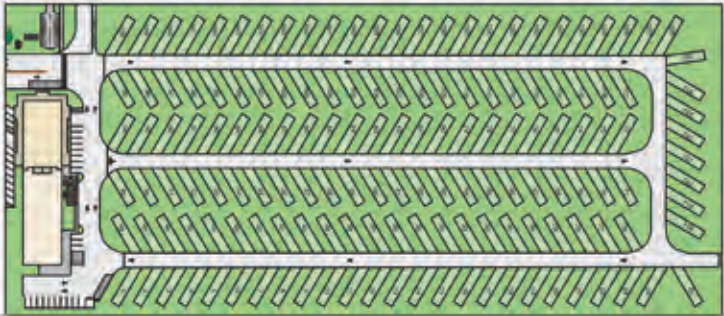

WESTERN PLEASURE FUTURITY ENTRY INFORMATION

\$100,000 Added Three Year Old Maiden Western Pleasure

- Horses that were born in 2018 and have never been shown astride prior to the Sudden Impulse Futurity
- Open and Limited Open Division
 - All entries with eligible riders will automatically be entered in the Limited Open Division. No Additional payment for the Limited division is required.
- Payback of total purse 60% Open and 40% Limited Rider Division
- 55% of Entry Fee add to total purse

• Entry Fee

Nomination Fee	\$750 Due February 15th
Sustaining Fee	\$750 Due April 1st
Total Fee	\$1,500

- Late Fee \$750.00 plus nomination and sustaining fees
- There will be two go-rounds, plus a final for the Open division and a final for the Limited Division.

Horses may not have been shown astride before the Sudden Impulse Futurity

\$30,000 Added Three and Over Novice Horse Western Pleasure

- Open to any horse three years old or older with not more than \$1,000 by December 31, 2020
 - 55% of entry fee add to total purse
 - **Entry Fee: \$500 Due April 1st**
 - Late Fee \$250.00 plus nomination and sustaining fees
 - There will be two go-rounds and a final
-

\$10,000 Added Three Year Old Non-Pro Western Pleasure

- Horses that were born in 2018
 - Open to any Non-Pro exhibitor
 - 55% of Entry Fee add to total purse
 - **Entry Fee: \$250 Due April 1st**
 - Late Fee \$125.00
 - There will be one go-round
-

\$10,000 Added 14-18 Youth Western Pleasure

- Open to any youth between the ages of 14 through 18 on January 1, 2021
 - 55% of entry fee add to total purse
 - **Entry Fee: \$75 Due April 1st**
 - Late Fee \$75.00
 - There will be one go-round. Class may be split depending on the number of entries with the finalist from each split coming back for a final.
-

\$7,500 Added 13 and Under Youth Western Pleasure

- Open to any youth 13 years old or younger on January 1, 2021
- 55% of entry fee add to total purse
- **Entry Fee: \$50 Due April 1st**
- Late Fee \$50.00
- There will be one go-round. Class may be split depending on the number of entries with the finalist from each split coming back for a final.

\$10,000 Added Three Year Old Open/Intermediate Western Pleasure

- Horses that were born in 2018
 - All Riders in the top 35 money earners over the last three years or in the Quarter Million dollar club are ineligible.
 - 55% of entry fee add to total purse
 - **Entry Fee: \$250 Due April 1st**
 - Late Fee \$125.00
 - There will be one go-round. Classes will be held concurrently. Sixty percent payback to Open, 40% to Intermediate. No additional entry fee for the intermediate class
-

\$5,000 Added Maturity Open/Intermediate Western Pleasure

- Horses that were born on or before 2017
 - All Riders in the top 35 money earners over the last three years or in the Quarter Million dollar club are ineligible.
 - 55% of entry fee add to total purse
 - **Entry Fee: \$200 Due April 1st**
 - Late Fee \$100.00
 - There will be one go-round. Classes will be held concurrently. Sixty percent payback to Open, 40% to Intermediate. No additional entry fee for the intermediate class
-

\$5,000 Added Maturity Limited Open Western Pleasure

- Horses that were born on or before 2017
 - Horses with Western Pleasure earnings \$2,500 or less
 - 55% of entry fee add to total purse
 - **Entry Fee: \$200 Due April 1st**
 - Late Fee \$100.00
 - There will be one go-round
-

\$5,000 Added Maturity \$10,000 Limited Horse Non-Pro Pleasure

- Horses that were born on or before 2017
 - Open to any youth or amateur exhibitor
 - Horses with Western Pleasure earnings \$10,000 or less
 - 55% of entry fee add to total purse
 - **Entry Fee: \$200 Due April 1st**
 - Late Fee \$100.00
 - There will be one go-round
-

\$2,000 Added Maturity \$10,000 Limited Western Pleasure

- Horses that were born on or before 2017
- Horses with Western Pleasure earnings \$10,000 or less
- 55% of entry fee add to total purse
- **Entry Fee: \$150 Due April 1st**
- Late Fee \$75.00
- There will be one go-round

\$2,000 Added Maturity Non-Pro Western Pleasure

- Horses that were born on or before 2017
 - 55% of entry fee add to total purse
 - **Entry Fee: \$150 Due April 1st**
 - Late Fee \$100.00
 - There will be one go-round
-

\$2,000 Added Maturity Intermediate Non-Pro Western Pleasure

- Non-Pro Riders in the top 15 money earners or in the Quarter Million dollar club are ineligible
 - 55% of entry fee add to total purse
 - **Entry Fee: \$150 Due April 1st**
 - Late Fee \$75.00
 - There will be one go-round
-

\$2,000 Added Limited Non-Pro Western Pleasure

- Non-Pro Riders with less than \$5,000 in Non-Pro earnings
 - 55% of entry fee add to total purse
 - **Entry Fee: \$150 Due April 1st**
 - Late Fee \$75.00
 - There will be one go-round
-

TRAIL FUTURITY ENTRY INFORMATION

\$15,000 Added Maiden Maturity Trail

- Horses that were born on or before 2017 and have never been shown in a Trial class prior to the Sudden Impulse Futurity
 - 55% of entry fee add to total purse
 - **Entry Fee: \$300 Due April 1st**
 - Late Fee \$150.00
 - There will be one go-round and the top 15 compete in the finals upon completion of the preliminary round.
-

\$2,000 Added 4 and 5 Year Old Open Trail

- Horses that were born in 2016 or 2017
 - 55% of entry fee add to total purse
 - **Entry Fee: \$150 Due April 1st**
 - Late Fee \$100.00
 - There will be one go-round
-

\$2,000 Added 3 Year Old Limited Trail

- Horses that were born in 2018
- Horses with Trail earnings of \$2,500 or less
- Horses may have not
- 55% of entry fee add to total purse
- **Entry Fee: \$150 Due April 1st**
- Late Fee \$100.00
- There will be one go-round

\$2,000 Added Limited Non-Pro Trail

- Horses with Trail earnings not greater than \$2,500 and have earned less than 25 points in Trail
- 55% of entry fee add to total purse
- **Entry Fee: \$150 Due April 1st**
- Late Fee \$100.00
- There will be one go-round

HUNTER UNDER SADDLE FUTURITY INFORMATION

\$15,000 Added 3 Year Old Maiden Hunter Under Saddle

- Horses that were born in 2018 and have never been shown astride prior to the Sudden Impulse Futurity
- Open and Limited Open Division
- All entries with eligible riders will automatically be entered in the Limited Open Division. No Additional payment for the Limited division is required.
- Payback of total purse 60% Open and 40% Limited Rider Division
- 55% of entry fee add to total purse
- **Entry Fee: \$300 Due April 1st**
- Late Fee \$150.00
- There will be two go-rounds and a final

\$10,000 Added 14-18 Youth Hunter Under Saddle

- Open to any youth between the ages of 14 - 18 on January 1, 2021
- 55% of entry fee add to total purse
- **Entry Fee: \$75 Due April 1st**
- Late Fee \$50.00
- There will be one go-round. Class may be split depending on the number of entries with the finalist from each split coming back for a final.

\$7,500 Added 13 and Under Youth Hunter Under Saddle

- Open to any youth 13 years old or younger on January 1, 2021
- 55% of entry fee add to total purse
- **Entry Fee: \$50 Due April 1st**
- Late Fee \$50.00
- There will be one go-round. Class may be split depending on the number of entries with the finalist from each split coming back for a final.

\$2,000 Added 3 Year Old Limited Horse Hunter Under Saddle

- Horses that were born in 2018
- Horses with less than \$2,500 In Hunter Under Saddle earnings
- 55% of entry fee add to total purse
- **Entry Fee: \$150 Due April 1st**
- Late Fee \$100.00

\$2,000 Added 3 Year Old Novice Horse Hunter Under Saddle

- Horses that were born in 2018
- Horses with less than \$1,000 In Hunter Under Saddle earnings
- 55% of entry fee add to total purse
- **Entry Fee: \$150 Due April 1st**
- Late Fee \$100.00

\$2,000 Added Maturity \$2,500 Ltd Horse Hunter under Saddle

- Horses that were born in 2017 or earlier
 - Horses with less than \$2,500 In Hunter Under Saddle earnings
 - 55% of entry fee add to total purse
 - **Entry Fee: \$150 Due April 1st**
 - Late Fee \$100.00 plus nomination and sustaining fees
-

\$2,000 Added 3 Year Old Non-Pro Hunter Under Saddle

- Horses that were born in 2018
 - Open to any youth or amateur exhibitor
 - 55% of entry fee add to total purse
 - **Entry Fee: \$150 Due April 1st**
 - Late Fee \$100.00
-

\$5,000 Added Hunt Field Derby

- 55% of entry fee add to total purse
 - **Entry Fee: \$250 Due April 1st**
 - Late Fee \$125.00
-

RIDER CLASSIFICATION PER NSBA RULES

Open Classes - All riders are eligible for participation in Open Western Pleasure class.

Intermediate Open WP classes

- All riders are eligible for participation in any Intermediate Open WP class except those in the Quarter Million Dollar Club or the top 35 money earners in Western Pleasure in the last three years.

Limited Open WP classes

- All riders are eligible for participation in any Limited Open WP class except those whose lifetime earnings in Open Western Pleasure exceed \$15,000.

\$2,500 Open WP classes

- All riders are eligible for any \$2,500 Open WP class except those whose lifetime earnings in Open Western Pleasure exceed \$2,500.

Open Non-Pro classes

- All Non-Pro riders are eligible for participation in any Non-Pro WP class.

Intermediate Non-Pro classes

- All Non-Pro riders are eligible for participation in any Intermediate Non-Pro class except those in the Quarter Million Dollar Club or the top 15 money earners in the Non-Pro Western Pleasure in the last three years.

Limited Non-Pro classes

- All Non-Pro riders are eligible for any Limited Non-Pro class except those whose lifetime earnings in Non-Pro Western Pleasure exceed \$5,000.

Open Hunter Under Saddle (HUS)

- All HUS riders are eligible for participation in any Open HUS class.

Limited Open HUS classes

- All riders are eligible for participation in Limited Open HUS class except those riders in the Quarter Million Dollar Club or in the top 15 money earners in Hunter Under Saddle in the last three years.

Non-Pro Hunter Under Saddle (HUS)

- All Non-Pro riders are eligible for participation in any Non-Pro HUS class. Youth and Amateur exhibitors are eligible for the non-pro division as defined in the NSBA rule book.

Limited Non-Pro HUS classes

- All Non-Pro HUS riders are eligible for participation in any Limited Non-Pro HUS class except those riders in the Quarter Million Dollar Club or in the top 10 money earners in Non-Pro Hunter Under Saddle in the last three years.

Novice Non-Pro, Amateur & Youth

- In Novice Non-Pro, Novice Amateur or Novice Youth classes, the horse must be ridden by a Non-Pro, Amateur or Youth card holder and ownership must follow NSBA rules. Eligibility for Novice classes are detailed in the NSBA rulebook.

HORSES CATEGORIES

Novice horse must not have won \$1,000 or more in the event/discipline*

Limited horse must not have won more than \$2,500 the event/discipline*

Maturity horses must be Four years old or older.

Maturity Limited horses must be Four years old or older.

- Horse must not have won more than applicable amount of money for the class in which they are competing
 - Maturity \$2,500 Limited Horse – horses may not have won more than \$2,500*
 - Maturity \$5,000 Limited Horse – horses may not have won more than \$5,000*
 - Maturity \$10,000 Limited Horse – horses may not have won more than \$10,000*

Color horse is one who is registered with IBHA, PHBA, PtHA, ABRA, ApHC, APHA, POA. Eligibility of solid bred and/or breeding stock horses follow NSBA rules.

Green horse

- Any horse that has not earned more than 25 points in its respective class (ie Western Pleasure, Hunter Under Saddle etc.) in any NSBA recognized breed association, or more than \$2,500 in earnings in it's respective class as of December 31, 2020.

***All monies are considered as of December 31, 2020 recorded by NSBA, the recognized breed alliance partners, EquiStat and Robin Glenn Pedigrees.**

World Equestrian Center - Ocala
7340 N US HWY 27
Ocala, FL 34482

DON'T
FORGET TO
PICK UP
YOUR FREE

WORLD
EQUESTRIAN CENTER®
MAGAZINE

Browse our publications online at
wec.net/category/magazine

