



WORLD
EQUESTRIAN CENTER®
OCALA, FL



Steel Sculpted Steed
1968
The spirit of her has passed and her body is gone, but her memory lives on in the bronze. Her name, Steel Sculpted Steed, lives on through her magnificent bronze form.

Edge Bankers worked valiantly with the United States Marine Corps in the Korean War. During the brutal Battle of Chosin Reservoir in late March 1953, the steed's 11-month-old foal was killed by a single enemy mortar shell. From the American Supply Depot in the North Korean mountains, the steed's 11-month-old foal was rescued and taken to the United States. The steed's 11-month-old foal was rescued and taken to the United States. The steed's 11-month-old foal was rescued and taken to the United States.

The steed's 11-month-old foal was rescued and taken to the United States. The steed's 11-month-old foal was rescued and taken to the United States. The steed's 11-month-old foal was rescued and taken to the United States.

TRADE SHOWS, MEETINGS AND HOSPITALITY

Quality. Class. Distinction.®

Welcome...



Ocala, Florida is a city located in central Florida's Marion County with a population of approximately 70,000. The pastoral countryside is dotted with rolling hills, majestic oaks and rich, limestone soil. Marion County's municipal scene offers premium Florida real estate, a thriving arts and cultural experience, excellent restaurants and a beautiful historic district. The city is also home to the Silver Springs State Park and Ocala National Forest.

Centrally located in Florida, travelers can enjoy easy access to several major airports, as well as the Florida Turnpike and I-75.

World Equestrian Center – Ocala boasts ample outdoor and indoor, climate-controlled event space for competition and recreation. This multidisciplinary facility provides several venues for numerous events with accommodations, luxury amenities and dining options conveniently located throughout property.

THE EQUESTRIAN HOTEL

- Floors: 5
- Rooms: 248
- Handicapped Accessible: 67
- Check-in: 4pm | Checkout: 12pm

THE RIDING ACADEMY HOTEL

- Floors: 4
- Rooms: 390
- Pet friendly
- Check-in: 4pm | Checkout: 12pm

RV PARK

- 280 RV Slips
- Water, power and sewer hookups provided at each slip
- General store and fuel station
- Shower facilities and laundromat
- Two fenced dog parks

HOME AWAY FROM HOME

- 94 Units
- Three bedroom/two bathroom
- Full kitchen and dining area
- Sleeper sofa
- Washer and dryer

EVENT SPACE

- Exposition Centers 1 & 2 – Contiguous, column-free space, two LED walls and one four-sided LED screen
- Arenas 1-4 – One LED wall and two LED center displays
- Arena 5-6 – Two LED walls and one four-sided LED screen
- World Equestrian Center Stadium – Open-air stadium for 7,000 spectators with one LED wall
- Grand Outdoor Arena – Connected to The Equestrian Hotel, open-air stadium for 1,500 spectators with two LED walls

EVENT FEATURES & SERVICES

- Dedicated loading dock at each exposition center
- Multiple freight doors at each exposition center
- Dedicated event management team
- On-site audiovisual production
- On-site IT team
- Convenient on-site parking
- On-site printing service

RECREATIONAL FACILITIES

- Two outdoor pools and splash pads
- Walking and jogging path
- Calluna Spa and Salon
- Three 24-hour fitness centers
- Sand volleyball court

RESTAURANTS (include indoor and outdoor seating)

- Filo's Mexican Cantina
- Horse to Water Pool & Bar (*seasonal*)
- Miss Tilly's Lollipops
- Ralph's Burger & Sandwich Shop
- Viola & Dot's Italian Kitchen & Pizzeria

Located inside The Riding Academy Hotel:

- Tack Room Gourmet Marketplace

Located inside The Equestrian Hotel:

- Emma's Patisserie
- Stirrups Restaurant
- Yellow Pony Pub & Garden

MOBILE CATERING OPTIONS

- Full-Service Catering Truck
- Wood-Fired Pizza Oven
- Six, Multi-Concept Airstreams



FACILITY MAP

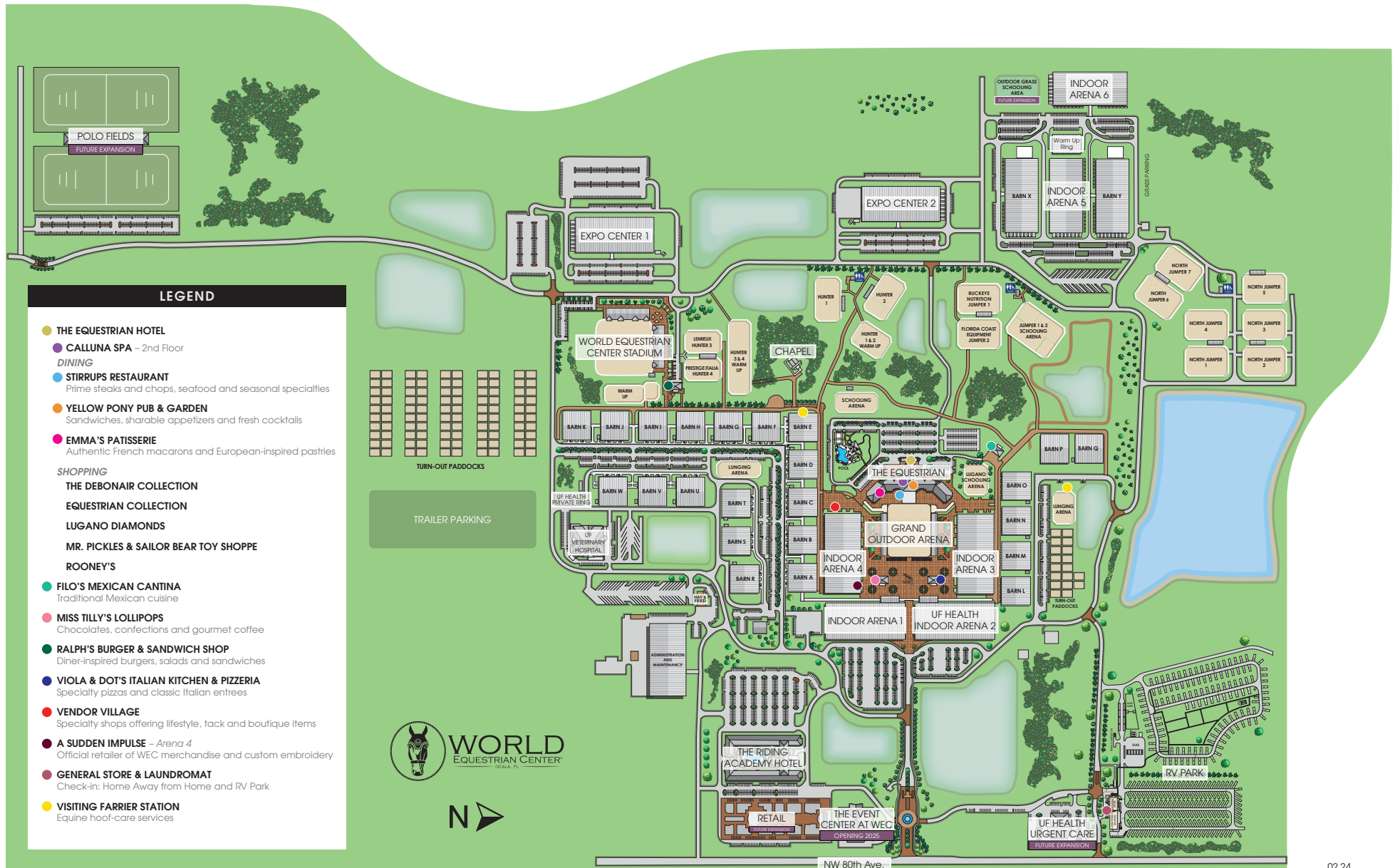

LEGEND

- **THE EQUESTRIAN HOTEL**
- **CALLUNA SPA** – 2nd Floor
DINING
- **STIRRUPS RESTAURANT**
Prime steaks and chops, seafood and seasonal specialties
- **YELLOW PONY PUB & GARDEN**
Sandwiches, sharable appetizers and fresh cocktails
- **EMMA'S PATISSERIE**
Authentic French macarons and European-inspired pastries
- SHOPPING**
- **THE DEBONAIR COLLECTION**
- **EQUESTRIAN COLLECTION**
- **LUGANO DIAMONDS**
- **MR. PICKLES & SAILOR BEAR TOY SHOPPE**
- **ROONEY'S**
- **FILO'S MEXICAN CANTINA**
Traditional Mexican cuisine
- **MISS TILLY'S LOLLIPOPS**
Chocolates, confections and gourmet coffee
- **RALPH'S BURGER & SANDWICH SHOP**
Diner-inspired burgers, salads and sandwiches
- **VIOLA & DOT'S ITALIAN KITCHEN & PIZZERIA**
Specialty pizzas and classic Italian entrees
- **VENDOR VILLAGE**
Specialty shops offering lifestyle, tack and boutique items
- **A SUDDEN IMPULSE** – Arena 4
Official retailer of WEC merchandise and custom embroidery
- **GENERAL STORE & LAUNDROMAT**
Check-in: Home Away from Home and RV Park
- **VISITING FARRIER STATION**
Equine hoof-care services



NW 80th Ave.



DINING

DINING AT THE EQUESTRIAN HOTEL

EMMA'S PATISSERIE

A blissful, freshly baked array of authentic French macarons, European-inspired pastries and gourmet coffees are served within an ambiance of old-world elegance at this very special shop located within The Equestrian Hotel.

HORSE TO WATER (seasonal)

As part of the hotel's outdoor recreation, guests are welcome to visit the Horse to Water Pool & Bar for a meal and some fun. Perfect for the whole family, children can enjoy the animal-inspired splash pad while adults cool off with a cocktail or refresh in the zero-entry pool. The Horse to Water Pool & Bar presents a great opportunity to lounge beneath the warm Florida sun and enjoy quintessential poolside food.

STIRRUPS RESTAURANT

Prime steaks and chops, sustainable Florida seafood and southern-inspired seasonal specialties are served in a refined dining room and terrace overlooking the Grand Outdoor Arena. Stirrups Restaurant, located inside of The Equestrian Hotel, is poised to be Ocala's premier steakhouse.

YELLOW PONY PUB & GARDEN

Yellow Pony Pub & Garden offers an authentic, pub dining experience with live music and a host of shareable appetizers and entrees. Additionally, the bar menu includes an impressive collection of bourbon, whiskey and specialty cocktails.

IN-ROOM DINING AT THE EQUESTRIAN HOTEL

Enjoy fresh food and beverages delivered to your suite, courtesy of the hospitality team. We offer a custom menu selection with made-to-order cuisine to cater to your specific tastes.

OTHER DINING

FILO'S MEXICAN CANTINA

Traditional Mexican flavors coupled with custom-made convenience make Filo's the perfect spot for all-day dining, including breakfast. Filo's serves up street tacos, burritos, quesadillas and much more in a vibrant dining room and open-air patio.

MISS TILLY'S LOLLIPOPS

Indulging is strongly encouraged at this unique sweet shop where specialty ice cream flavors and homemade fudge are the stars. With an array of chocolates, confections and coffees, Miss Tilly's is the perfect place for a tasty treat.

RALPH'S BURGER & SANDWICH SHOP

Home to a classic Americana, diner-inspired menu, Ralph's invites you to enjoy signature burgers, salads and sandwiches topped off with a homemade milkshake. Open for breakfast, lunch and dinner, start your day with a breakfast sandwich or enjoy an evening slice of pie.

VIOLA & DOT'S ITALIAN KITCHEN & PIZZERIA

Design your own pizza, salad or pasta masterpiece with an assortment of delicious meats and toppings. Viola & Dot's features pizzas and calzones crafted with homemade dough, classic Italian entrees and decadent sweet desserts.

THE TACK ROOM AT THE RIDING ACADEMY HOTEL

Gourmet marketplace serving breakfast, Starbucks® coffee and light fare for lunch and dinner. Enjoy creative cocktails from the bar with poolside walkup window, located on the first floor of The Riding Academy Hotel.



Scan the QR Code to go directly to our dining web page or visit: wec.net/ocala-fl/visit/dining/



WHERE TO STAY

THE EQUESTRIAN HOTEL

The world-class hotel boasts 248 well-appointed guest rooms and suites in addition to a state-of-the-art fitness center, salon and spa, outdoor swimming pool and multiple walking trails.

THE RIDING ACADEMY HOTEL

The Riding Academy Hotel offers 390 pet-friendly studios and suites on-site at World Equestrian Center – Ocala, conveniently located adjacent to the future Event Center at WEC and just a golf cart ride away from shopping, dining and equestrian exhibition at the property center.

WHAT TO EXPLORE

RETAIL

Discover over 30 retailers on-site, as well as a host of seasonal vendors, at World Equestrian Center carrying a wide range of products from home goods to apparel and performance gear. At The Equestrian Hotel, guests and visitors alike can browse high-end boutiques offering worldly gifts, luxury décor, high-end clothing and even rare toys. Future development will boast large, outdoor shopping plaza located adjacent to the World Equestrian Center – Ocala main entrance.



Scan the QR Code to view our
Retail & Dining Guide

DINING

With seven full-service, year-round restaurants and more in the plans, you can find everything from true southern fine dining experiences to ringside ice cream delights. The world-class culinary team is always available to groups for bespoke catering to make the most of your event.

CALLUNA SPA

Located on the second floor, the Calluna Spa is World Equestrian Center – Ocala's luxurious salon and spa. This retreat offers numerous amenities for relaxation, as well as a customizable spa menu. Massages, hair stylings, facials, manicures, pedicures and body treatments represent just some of the many services available at the Calluna Spa.

- Four massage rooms
- Couples massage room
- Full-service salon

CHAPEL

The serene, on-site chapel, located in an oak-canopy garden, offers daily opportunities for prayer, peace and reflection.

- Seats up to 100 guests
- Surrounded by beautiful, lush gardens
- Accommodates small weddings and intimate ceremonies

OTHER AMENITIES

- Golf cart rental
- Sand volleyball court





ACCESS

Centrally located in Florida, travelers can enjoy easy access to several major airports, as well as the Florida Turnpike and I-75.

Ocala International Airport (OCF) 4mi – **Private aviation only

Gainesville Regional Airport (GNV) 46mi

Orlando International Airport (MCO) 92mi

Tampa International Airport (TPA) 101mi

Hike, bike and paddle in the downtime while enjoying sunny Ocala's abundant outdoor recreation. The area is revered for its proximity to legendary horse farms, as well as access to crystal-clear springs, state parks and national forests.

ATTRACTIONS

Explore Marion County's local art, culture and recreation at Silver Springs State Park, The Canyons Zip Line and Adventure Park, Fort King National Historic Landmark, Appleton Museum of Art and The Reilly Arts Center.





FACILITY SPECS

Specifications, Features & Amenities	Arena 1	Arena 2	Arena 3	Arena 4	Arena 5	Arena 6 Opening 2024
Dimensions	530' x 170'	530' x 170'	530' x 170'	530' x 170'	474' x 160'	540' x 200'
Square Footage	90,630	90,630	90,630	90,630	75,840	108,000
Permanent Seats	1,326	1,326	1,326	1,326	3,400	1,300*
Ceiling Height	Low-18' High-35'	Low-18' High-35'	Low-18' High-35'	Low-18' High-35'	Low-14' High-45'	Low-14** High-45**
Load-In/Load-Out	(3) 20' x 20' Freight Doors	(3) 20' x 20' Freight Doors	(3) 20' x 20' Freight Doors	(3) 20' x 20' Freight Doors	(6) 20' x 20' Freight Doors (5) 16' x 18' Freight Doors	(6) 20' x 20' Freight Doors* (5) 16' x 18' Freight Doors*
Floor Finish	GGT Footing	GGT Footing	GGT Footing	GGT Footing	Sand/Clay	GGT Footing
Floor Ports						
Climate Controlled	✓	✓	✓	✓	✓	✓
Column Free	✓	✓	✓	✓	✓	✓
Announcer/Judge's Booth	✓	✓	✓	✓	✓	✓
Mezzanine Suites	✓	✓	✓	✓		
Electricity Phase						
Internet High-Speed Wi-Fi	✓	✓	✓	✓	✓	✓
LED Walls	(1) 38' x 22' Resolution 2240x1288	(1) 38' x 22' Resolution 2240x1288	(1) 38' x 22' Resolution 2240x1288	(1) 38' x 22' Resolution 2240x1288	(2) 38' x 22' Resolution 2944x1662	(1) 38' x 22** Resolution 2240x1288
LED Center Displays	(2) 25' x 15' Resolution 1920 x 1152	(2) 25' x 15' Resolution 1920 x 1152	(2) 25' x 15' Resolution 1920 x 1152	(2) 25' x 15' Resolution 1920 x 1152	(1) 4-sided 16' x 9' Resolution 1152 x 648	(2) 25' x 15** Resolution 1920 x 1152
Lighting Programmable LED						
Food Service/Catering	Catering Service	Catering Service	Catering Service	Catering Service	(2) Concession Stands Catering Service	Catering Service
Foyer for Event Registration	✓	✓	✓	✓	✓	✓
Show Office(s)	(2) Level 2	(2) Level 2	(2) Level 2	(2) Level 2	(1) 31' x 12' x 10' (1) 15' x 12' x 10'	(1)
On-Site Parking	✓	✓	✓	✓	✓	✓
Restrooms	✓	✓	✓	✓	✓	✓

*Subject to change

FACILITY SPECS



Specifications, Features & Amenities	Expo 1	Expo 2	WEC Stadium	Grand Outdoor Arena
Dimensions	540' x 245'	540' x 245'	370' x 370'	380' x 300'
Square Footage	132,300	132,300	136,900	114,000
Permanent Seats	N/A	N/A	6,500	1,500
Ceiling Height	Low-14' High-45'	Low-14' High-45'	N/A	N/A
Load-In/Load-Out	(1) Dedicated Dock Slip (4) 20' x 20' Freight Doors (5) 16' x 18' Freight Doors	(1) Dedicated Dock Slip (13) 20' x 20' Freight Doors (5) 16' x 18' Freight Doors	N/A	N/A
Floor Finish	Carpet	Concrete	GGT Footing	GGT Footing
Floor Ports	22 per hall	22 per hall		
Climate Controlled	✓	✓		
Column Free	✓	✓		
Announcer/Judge's Booth			✓	✓
Mezzanine Suites				
Electricity Phase	Phase 1 & 3 Floor Parts	Phase 1 & 3 Floor Parts		
Internet High-Speed Wi-Fi	✓	✓	✓	✓
LED Walls	(2) 38' x 22' Resolution 2944x1662	(2) 38' x 22' Resolution 2944x1662	(1) 38' x 22' Resolution 2240x1288	(2) 38' x 22' Resolution 2240x1288
LED Center Displays	(1) 4-sided 16' x 9' Resolution 1152 x 648	(1) 4-sided 16' x 9' Resolution 1152 x 648		
Lighting Programmable LED	✓	✓		
Food Service/Catering	(2) Concession Stands Catering Service	(2) Concession Stands Catering Service	(4) Concession Stands Catering Service	Catering Service
Foyer for Event Registration	✓	✓		
Show Office(s)	(1) 31' x 12' x 10' (1) 15' x 12' x 10'	(1) 31' x 12' x 10' (1) 15' x 12' x 10'	(3) 35' x 16'	
On-Site Parking	✓	✓	✓	✓
Restrooms	✓	✓	✓	✓



INDOOR ARENA 1

SPECIFICATIONS	
Dimensions	530' x 170'
Square Footage	90,630
Load-In/Load-Out Capacity	(3) 20' x 20' Freight Doors
Ceiling Height	Low – 18' High – 35'
Permanent Seats	1,326
Arena Floor Finish	GGT Footing
Mezzanine Suite Floor Finish	Polished Concrete
Infrastructure & Technology	(1) LED End Wall Display 38' x 22' Resolution: 2240 x 1288 (2) LED Center Displays 25' x 15' Resolution: 1920 x 1152 LED Lighting High-Speed Wi-Fi
Judge's Room	17' 7" x 13' 8"
Announcer's Room	18' 2" x 13' 8"
Food Service	Catering
Other Amenities	Connected barns via covered walkway On-Site Parking

Equine Events • Canine Events
Meetings and Social Events

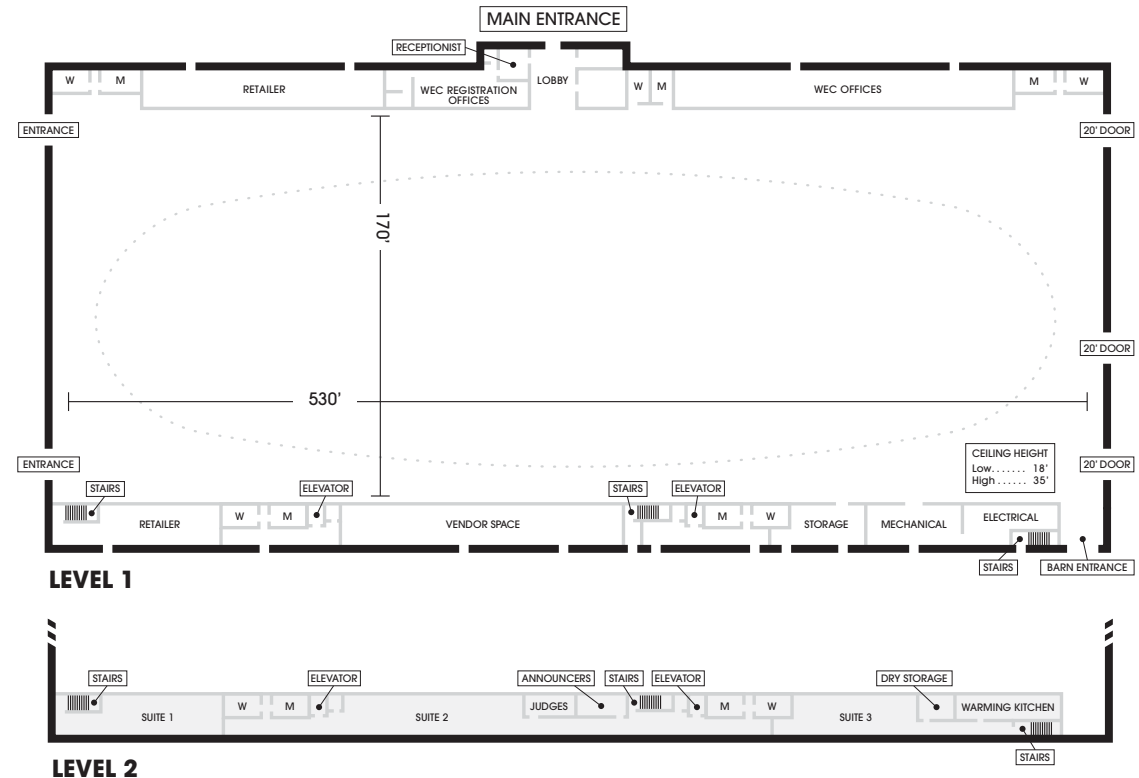

Mezzanine	Suite 1*	Suite 2	Suite 3
Dimensions	61.5' x 21.3'	98.9' x 21.3'	64.3' x 21.3'
Square Feet	1,309	2,106	1,369
Banquet	N/A	112	80
Reception	30	150	100
Theater	N/A	210	140
Classroom	N/A	80	54

*Suite furnished with couches, chairs and/or tables

INDOOR ARENA 2



SPECIFICATIONS	
Dimensions	530' x 170'
Square Footage	90,630
Load-In/Load-Out Capacity	(3) 20' x 20' Freight Doors
Ceiling Height	Low – 18' High – 35'
Permanent Seats	1,326
Arena Floor Finish	GGT Footing
Mezzanine Suite Floor Finish	Polished Concrete
Infrastructure & Technology	(1) LED End Wall Display 38' x 22' Resolution: 2240 x 1288 (2) LED Center Displays 25' x 15' Resolution: 1920 x 1152 LED Lighting High-Speed Wi-Fi
Judge's Room	136' x 20'
Announcer's Room	17' 10" x 13' 8"
Food Service	Catering
Other Amenities	Connected barns via covered walkway On-Site Parking

Equine Events • Canine Events
Meetings and Social Events

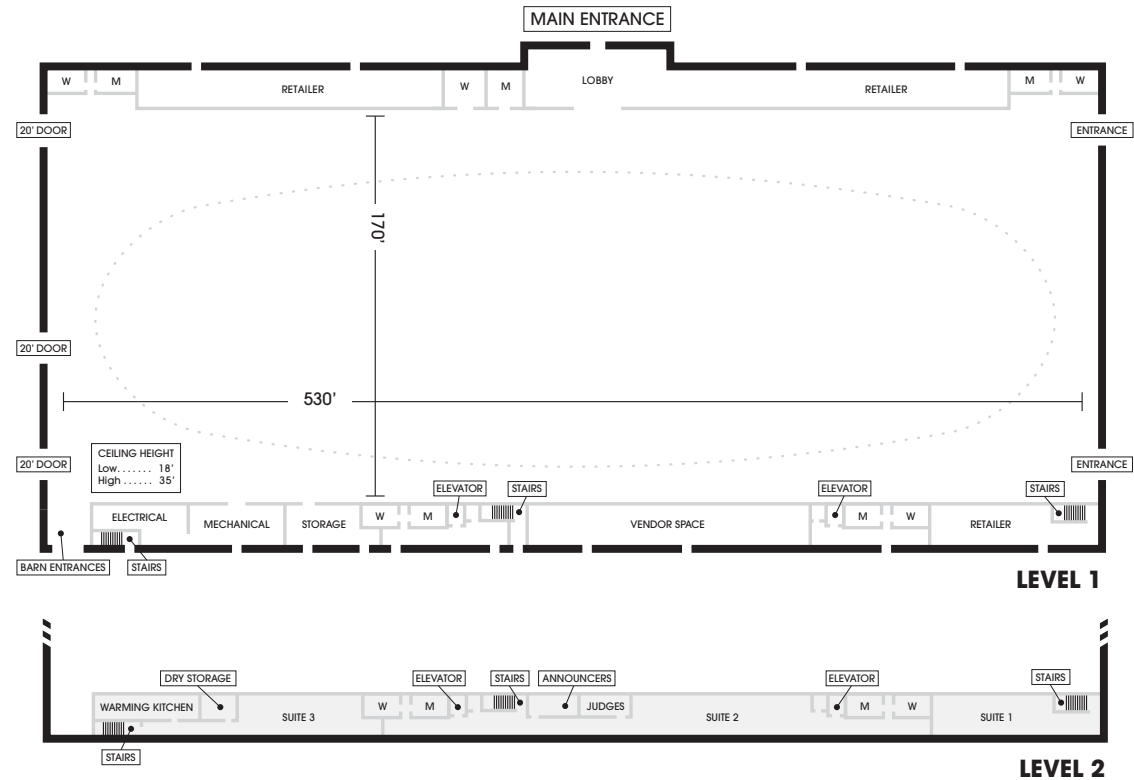

Mezzanine	Suite 1 *	Suite 2	Suite 3
Dimensions	61.5' x 21.9'	99' x 21.9'	64.9' x 21.9'
Square Feet	1,423	2,168	1,421
Banquet	N/A	152	96
Reception	30	175	120
Theater	N/A	240	160
Classroom	N/A	90	60

*Suite furnished with couches, chairs and/or tables



INDOOR ARENA 3

SPECIFICATIONS	
Dimensions	530' x 170'
Square Footage	90,630
Load-In/Load-Out Capacity	(3) 20' x 20' Freight Doors
Ceiling Height	Low – 18' High – 35'
Permanent Seats	1,326
Arena Floor Finish	GGT Footing
Mezzanine Suite Floor Finish	Polished Concrete
Infrastructure & Technology	(1) LED End Wall Display 38' x 22' Resolution: 2240 x 1288 (2) LED Center Displays 25' x 15' Resolution: 1920 x 1152 LED Lighting High-Speed Wi-Fi
Judge's Room	17' 10" x 13' 8"
Announcer's Room	18' 4" x 13' 8"
Food Service	Catering
Other Amenities	Connected barns via covered walkway On-Site Parking

Equine Events • Canine Events
Meetings and Social Events

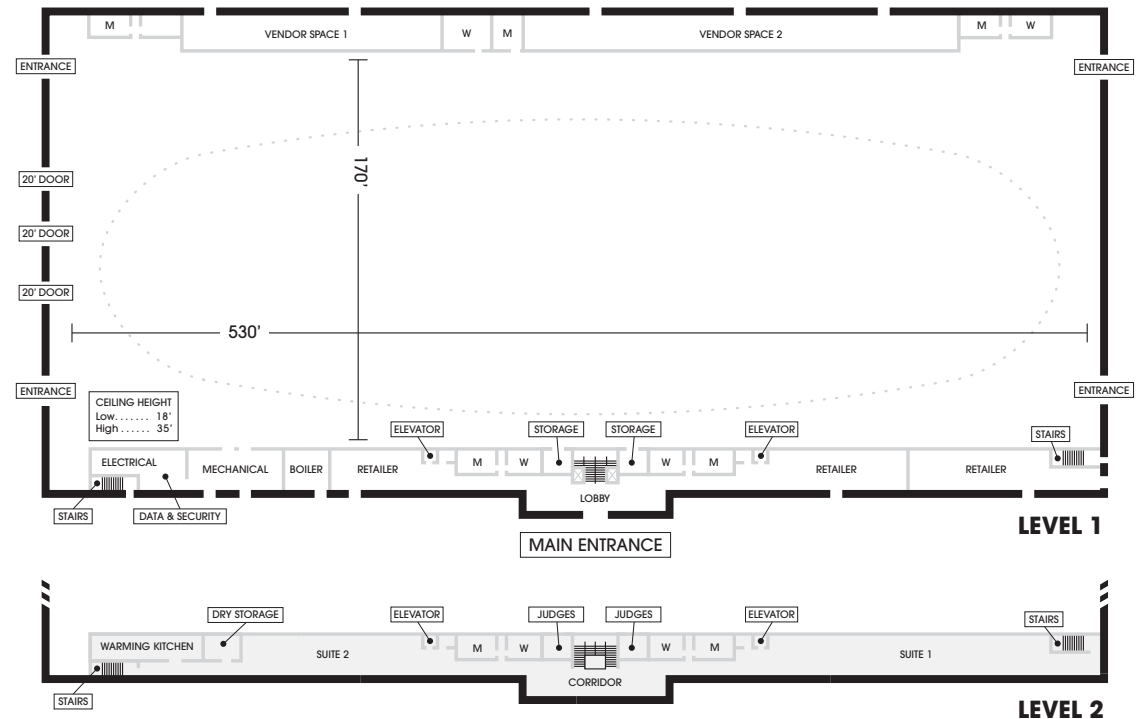

Mezzanine	Suite 1*	Suite 2
Dimensions	147.9' x 21.8'	99.2' x 21.3'
Square Feet	2,162	3,224
Banquet	96	224
Reception	113	250
Theater	N/A	360
Classroom	N/A	135

*Suite furnished with couches, chairs and/or tables

INDOOR ARENA 4



SPECIFICATIONS	
Dimensions	530' x 170'
Square Footage	90,630
Load-In/Load-Out Capacity	(3) 20' x 20' Freight Doors
Ceiling Height	Low – 18' High – 35'
Permanent Seats	1,326
Arena Floor Finish	GGT Footing
Mezzanine Suite Floor Finish	Polished Concrete
Infrastructure & Technology	(1) LED End Wall Display 38' x 22' Resolution: 2240 x 1288 (2) LED Center Displays 25' x 15' Resolution: 1920 x 1152 LED Lighting High-Speed Wi-Fi
Judge's Room	17' 10" x 13' 8"
Announcer's Room	18' 4" x 13' 8"
Food Service	Catering
Other Amenities	Connected barns via covered walkway On-Site Parking

Equine Events • Canine Events
Meetings and Social Events

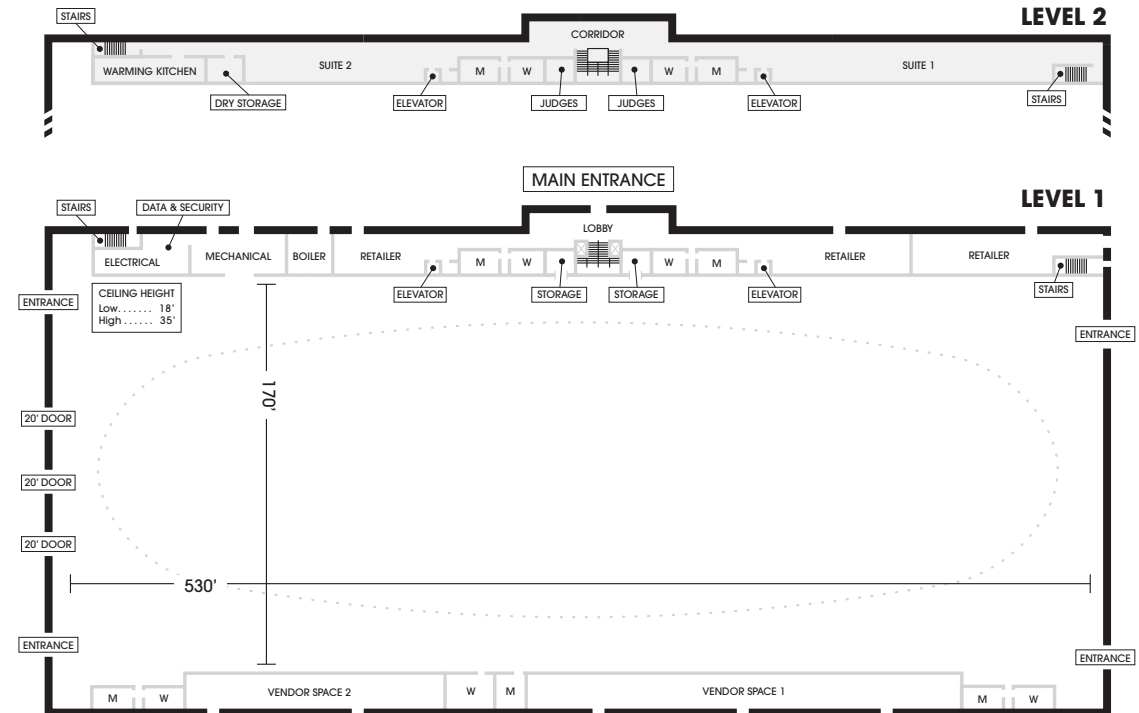

Mezzanine	Suite 1*	Suite 2
Dimensions	149.7' x 21.8'	99.3' x 21.8'
Square Feet	3,263	2,164
Banquet	96	168
Reception	120	190
Theater	160	N/A
Classroom	60	N/A

*Suite furnished with couches, chairs and/or tables



INDOOR ARENA 5

SPECIFICATIONS	
Dimensions	474' x 160'
Square Footage	75,840
Load-In/Load-Out Capacity	(6) 20' x 20' Freight Doors (5) 16' x 18' Freight Doors
Ceiling Height	Low – 14' High – 45'
Permanent Seats	3,400
Arena Floor Finish	Sand/Clay
Infrastructure & Technology	(1) LED End Wall Display 38' x 22' Resolution: 2240 x 1288 (2) LED Center Displays 25' x 15' Resolution: 1920 x 1152 LED Lighting High-Speed Wi-Fi
Foyer	75' x 23'
Show Office 1	31' x 12' x 10'
Show Office 2	15' x 12' x 10'
Announcer/Judge's Room	20' x 40'
Food Service	(2) Built-In Concession Stands Catering Services
Other Amenities	Covered Outdoor Practice Arena On-Site Parking – 655 Handicapped Accessible – 23 Trailer Parking – 27 Grass Parking – 73

Equine Events • Canine Events • Concerts
Sporting Events

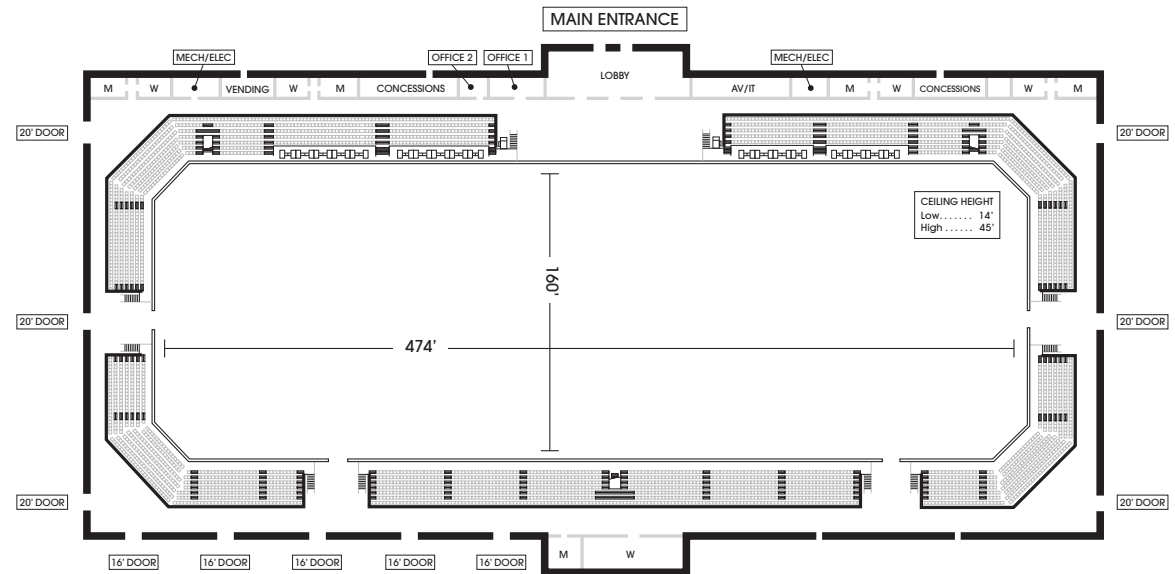

INDOOR ARENA 6



Equine Events • Canine Events • Concerts
Sporting Events

SPECIFICATIONS	
Dimensions	540' x 200'
Square Footage	108,000
Load-In/Load-Out Capacity	(6) 20' x 20' Freight Doors* (5) 16' x 18' Freight Doors*
Ceiling Height	Low – 14' High – 45'*
Permanent Seats	1,300*
Arena Floor Finish	GGT Footing
Infrastructure & Technology	(1) LED End Wall Display* 38' x 22' Resolution: 2240 x 1288 (2) LED Center Displays* 25' x 15' Resolution: 1920 x 1152 LED Lighting High-Speed Wi-Fi
Foyer	75' x 23'*
Show Office	31' x 12' x 10'*
Announcer/Judge's Room	17' 10" x 13' 8"*
Food Service	Catering Services
Other Amenities	On-Site Parking Handicapped Accessible Trailer Parking Grass Parking *Subject to change

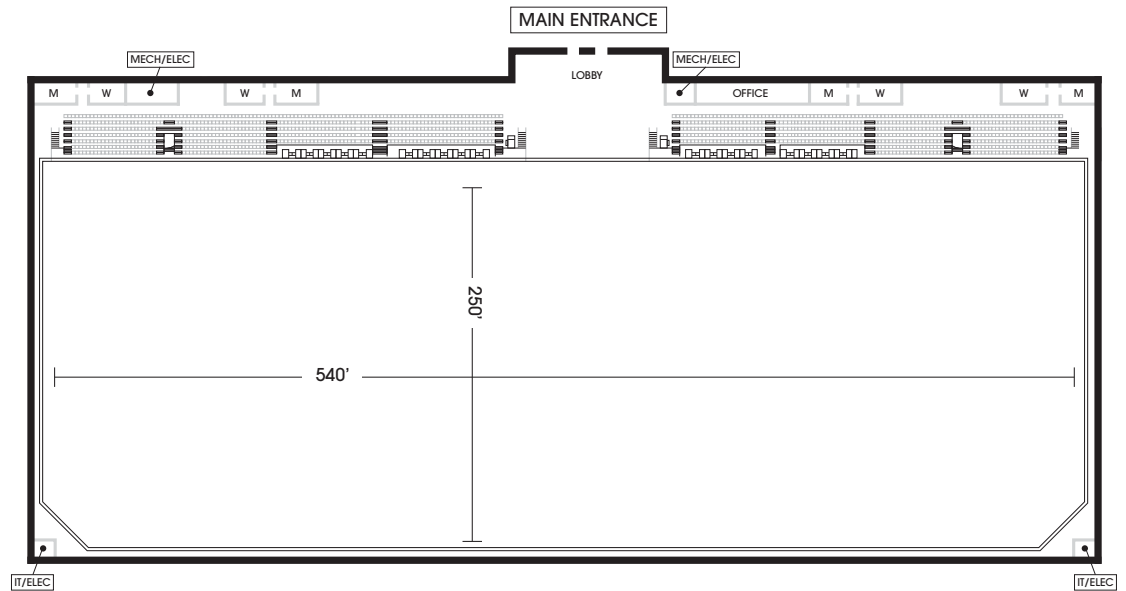



INDOOR EXPO 1

SPECIFICATIONS	
Dimensions	540' x 245'
Square Footage	132,300
Foyer	74' x 50'
Floor Finish	Carpet
Show Office 1	31' x 12' x 10'
Show Office 2	15' x 12' x 10'
Load-In/Load-Out Capacity	(1) Dedicated Dock Slip (4) 20' x 20' Freight Doors (5) 16' x 18' Freight Doors
Ceiling Height	Low – 14' High – 45"
Floor Ports	22 per hall
Electricity	Phase 1 & 3 Floor Ports
Infrastructure & Technology	(2) LED End Wall Displays 38' x 22' Resolution: 2944 x 1662 (1) 4-sided LED Center Display 16' x 9' Resolution: 1152 x 648 LED Lighting Wired Internet (copper or fiber optic) High-Speed Wi-Fi
Food Service	(2) Built-In Concession Stands Catering Services
Features & Amenities	On-Site Parking – 456 Handicapped Accessible – 12 Adjacent Lot – 400 Column-free Attached Banquet Kitchen

Tradeshows • Social Events • Concerts • Car Shows
Canine Events • Conferences • Sporting Events

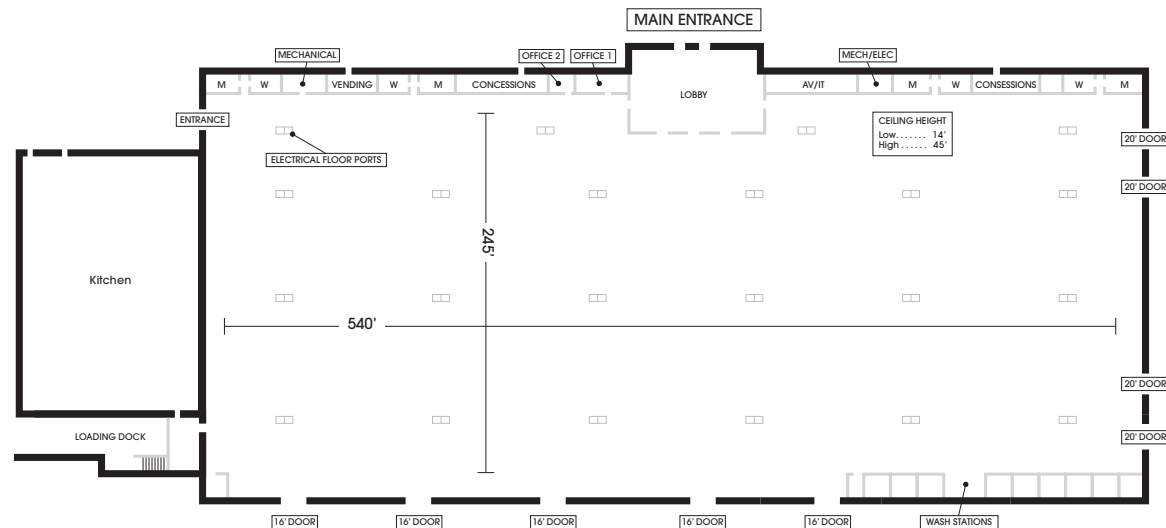

Expo 1	
Banquet	4,500
Theater	6,000
Exhibits	500

INDOOR EXPO 2



SPECIFICATIONS	
Dimensions	540' x 245'
Square Footage	132,300
Foyer	74' x 50'
Floor Finish	Polished Concrete
Show Office 1	31' x 12' x 10'
Show Office 2	15' x 12' x 10'
Load-In/Load-Out Capacity	(1) Dedicated Dock Slip (13) 20' x 20' Freight Doors (5) 16' x 18' Freight Doors
Ceiling Height	Low – 14' High – 45"
Floor Ports	22 per hall
Electricity	Phase 1 & 3 Floor Ports
Infrastructure & Technology	(2) LED End Wall Displays 38' x 22' Resolution: 2944 x 1662 (1) 4-sided LED Center Display 16' x 9' Resolution: 1152 x 648 LED Lighting Wired Internet (copper or fiber optic) High-Speed Wi-Fi
Food Service	(2) Built-In Concession Stands Catering Services
Features & Amenities	On-Site Parking – 256 Handicapped Accessible – 8 Column-free (9) Dedicated wash stations

Tradeshows • Social Events • Concerts • Car Shows
Canine Events • Conferences • Sporting Events

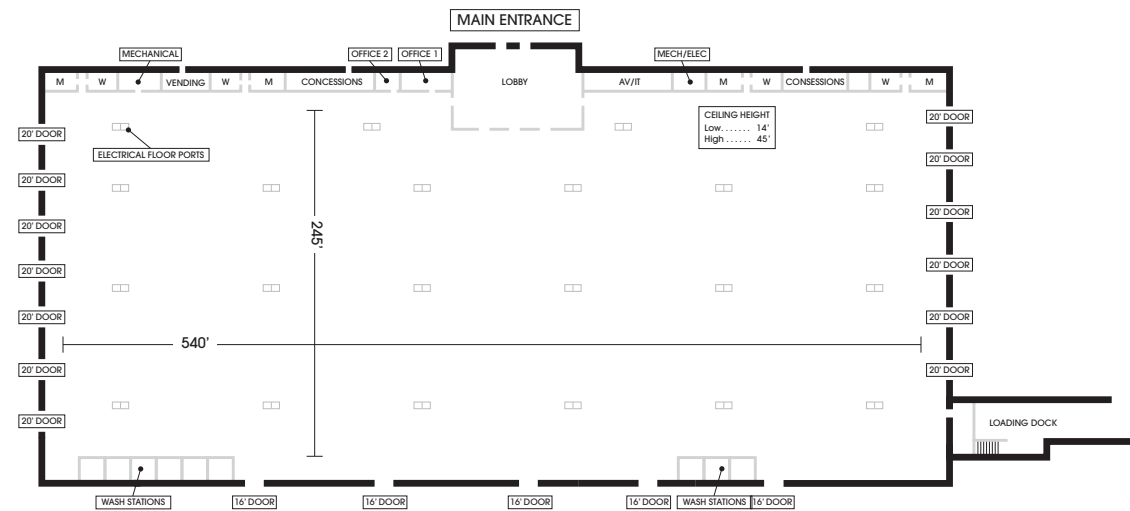

Expo 2	
Banquet	4,500
Theater	6,000
Exhibits	500

WORLD EQUESTRIAN CENTER STADIUM



SPECIFICATIONS	
Dimensions	370' x 370'
Square Footage	136,900
Load-In/Load-Out Capacity	16' Entrance Gate
Permanent Seats	6,500
Floor Finish	GGT Footing
Announcer's Room	20' x 24'
Press Box	10' x 24' North 10' x 24' South
Infrastructure & Technology	(1) LED Wall Display 38' x 22' Resolution: 2240 x 1288 Stadium Lights High-Speed Wi-Fi
Show Office – North 1	35' x 16'
Show Office – North 2	35' x 16'
Show Office – South 1	35' x 16'
Food Service	Concession Stands Catering Services
Other Amenities	On-Site Parking – 39 Handicap-accessible – 26 Adjacent Lot – 362 Grass Parking – 400 Cars Warm-up Arena Covered Pavilion

Equine Events • Canine Events
Concerts • Competitions

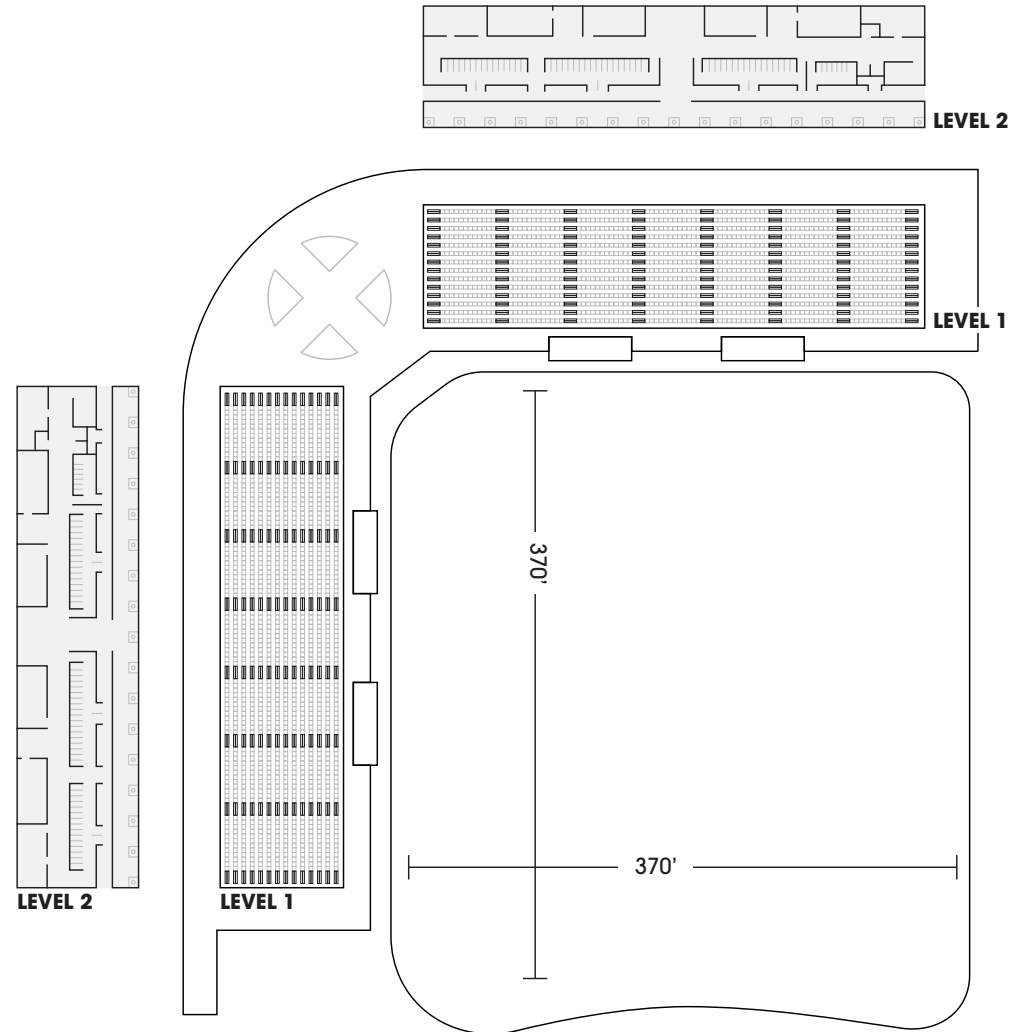



GRAND OUTDOOR ARENA

Equine Events • Canine Events
Concerts • Competitions

SPECIFICATIONS	
Dimensions	380' x 300'
Square Footage	114,000
Load-In/Load-Out Capacity	Two Ramps
Permanent Seats	1,500
Floor Finish	GGT Footing
Announcer's Room	20' x 24'
Infrastructure & Technology	(2) LED Wall Display 38' x 22' Resolution: 2240 x 1288 Stadium Lights High-Speed Wi-Fi
Food Service	Concession Stands
Other Amenities	On-Site Parking – 562 Handicap-accessible – 16 Grass Parking – 400 Cars Lugano Warm-up Arena Canopy Seating Outdoor Dining

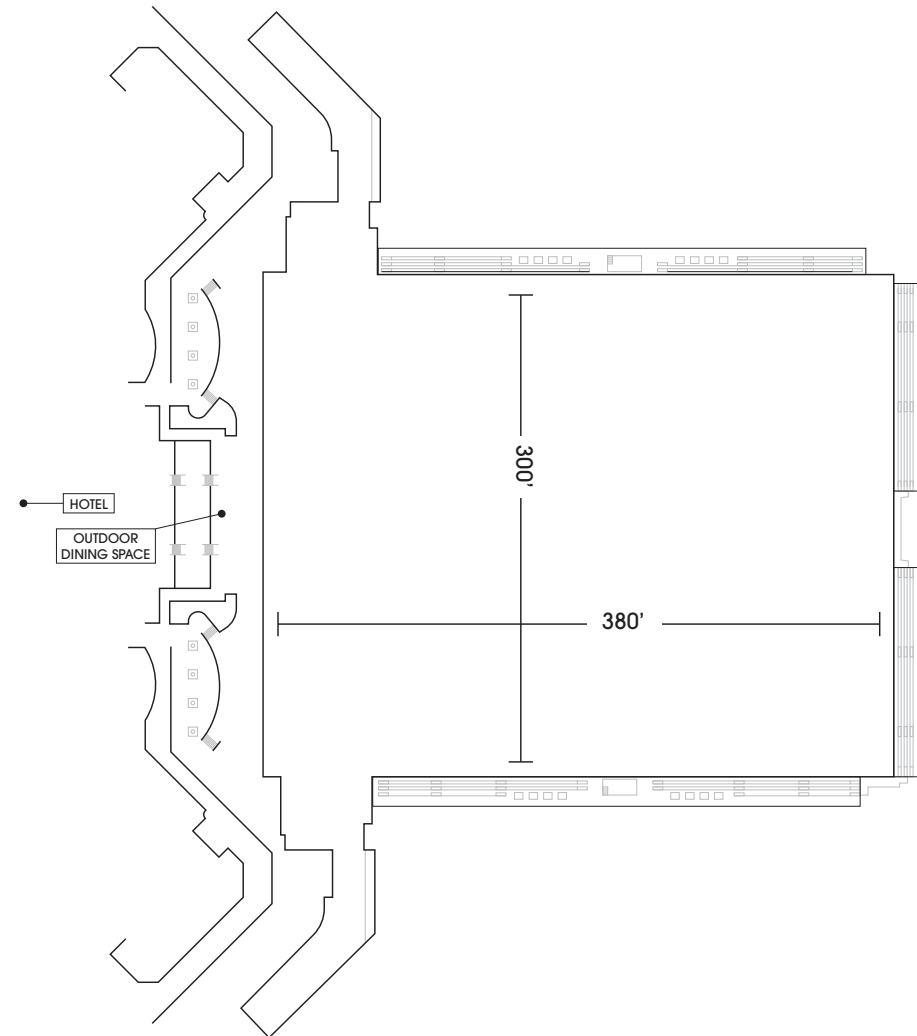



As America's largest equestrian center, World Equestrian Center – Ocala is a one-of-a-kind event destination. The 378-acres property offers a range of world-class venues for year-round meetings and events of all needs and sizes.

Contact our team to learn more about bringing your next event to World Equestrian Center – Ocala.

352.414.7850 | ocalasales@wec.net
ocala.wec.net/tradeshows



© ANDREW RYBACK 2022