

Opening Date: September 15, 2024

Closing Date: October 8, 2024



## **WORLD EQUESTRIAN CENTER OCTOBER DRESSAGE**

Competition Dates October 19-20, 2024

USEF/USDF #340529 Level 3 Competition

Competition Address: World Equestrian Center – Ocala, 1390 NW 80<sup>th</sup> Avenue, Ocala, FL 34482

### **OFFICIAL QUALIFYING COMPETITION**

2024 Great American/USDF Regional Championships

USEF Qualifying Competition for the

2025 FEI North American Youth Championships; 2025 USEF Pony Rider Dressage National Championship; 2025 USEF Children Dressage National Championships; 2025 Adequan/USEF Junior Rider Dressage National Championships; 2025 Horsecare Ireland/USEF Young Rider Dressage National Championships 2025 Adequan/USEF Young Adult Brentina Cup Dressage National Championships; 2025 Neue Schule/USEF Intermediare I Dressage National Championship; 2025 Neue Schule/USEF Grand Prix Dressage National Championship; 2025 Adequan/USEF Para National Championships

### **SHOW OFFICIALS**

#### **Show Manager**

Noreen O'Sullivan  
noreen.osullivan@wec.net  
561-714-9026

#### **Secretary**

Ann Hart  
ashbrookfarm@hotmail.com  
561-685-3918

#### **Office**

Evin Rattner

#### **USEF Technical Delegate**

Elizabeth Morisani

#### **Judges**

Joan Darnell (S), Janet Foy (S),  
Dolly Hannon (S), Elizabeth Kane (S)

**Treating Vet:** Larry Wexler (352) 812-1411

**Farrier:** Scott Lampert (612) 282-5529

Online entries: [entry.foxvillage.com](http://entry.foxvillage.com)

**No mail in entries will be accepted.**

#### **AWARDS:**

Six ribbons for each class. Prize given if three or more in division.



## **ENTRY INFORMATION**

All entries MUST submit applicable USEF and USDF documents for rider, owner, trainer and horse, proof of EIV and EHV vaccinations dated within 6 months of the show, negative EIA within 12 months of the show, 14-day health certificate, a drug fee, and non-refundable office fee. Please include USEF Show Pass and/or USDF non-member fee if applicable. All entries must have three signatures including emergency information. Checks payable to Arena Horse Shows of Ocala or fill out credit card information on the entry form. All major credit cards are accepted with a 3% convenience fee. Only online entries accepted [www.eqentries.com](http://www.eqentries.com). No mailed entries accepted. Emailed or online entries are only accepted with credit card as payment. Post entries will be accepted to fill scratches with a \$50 post entry fee. Completed entries will be processed in the order they are received. Refunds will be given for cancellations received in writing or email on or before closing date, less office fee.

Weather/Acts of God/Accidents or Emergency Policy: Management reserves the right to cancel any classes due to hazardous weather, Acts of God, Accidents or Emergencies. Every effort will be made to reschedule with priority given to CDI or USEF Program classes. **NO REFUNDS FOR ANY REASON AFTER CLOSING DATE. No refunds for cancellations due to hazardous weather, Acts of God, Accidents or Emergencies.**

No Shows: All "No Shows" that have not contacted the show office will be considered a scratch for the rest of the show and time slots may be filled. Exhibitors enter with this understanding and agreement. Any unused USEF or USDF fees will be refunded after any indebtedness is settled.

TIMES: Times will be on the website, [www.foxvillagedressage.com](http://www.foxvillagedressage.com) the Tuesday prior to the competition and posted at the show by noon on Friday. The email address to send music will be given when ride times are sent. Music must be in MP3 or WAV formats at no more than 256Kbps. Once music is received, sound check times will be given.

STABLING: Permanent stalls (12' X 12') with full doors, rubber mats, fan and electrical receptacle. National are \$250 for duration of show. No initial bedding. Please note your stabling group on your entry. No refunds on stabling after the closing date. Earlier arrival and later departures must get permission from management and cost \$50/night. **All Shavings must be purchased through World Equestrian Center – Ocala. No outside shavings permitted. Feed and bedding can be purchased online after stalls are assigned. Stall assignments will go out no later than two days before the show starts. A link to the feed and bedding will be sent out with the stall assignments.**

ACCOMMODATIONS: Find at [www.worldequestriancenter.com/ocala-fl/visit/stay/](http://www.worldequestriancenter.com/ocala-fl/visit/stay/)  
Camper Hookups are available and include a full hookup, ie water, sewer, electric. To reserve, contact the General Store at WEC (352) 414-7871.

DIRECTIONS: GPS Address For Competitors For Arena 6/Dressage : 8747 W Hwy 40, Ocala, FL 34482.

From I-75: Take Exit 352, to FL-40W for 6 miles to World Equestrian Center Entrance. Turn right onto NW 87th Ct Rd. Continue past Expo Centers 1 & 2. Stabling is in Barns X & Y. Dressage Show Office located will be inside Indoor Arena 6. Follow posted signs regarding Trailer Parking and Ship In Area.

ARENAS: Arenas: Outdoor and Indoor arenas. Qualifying Classes to have priority for Indoor arenas. Freestyles classes may be hosted in afternoon or evening, based on schedule, and may be hosted outdoor as well. Arenas have all weather sand mix footing on limestone base. Warm-up arenas have comparable footing. All tests will be ridden in an 20 x 60 arena. **NO LUNGEING** in warmup arenas – use Designated Lunging Arenas only. **Coaching may ONLY be done from the outside of the arenas.** Competition arenas will be open for schooling on Thursday (before show weekend) until posted close time in show office.

ENTERTAINMENT: There are six restaurants on the grounds. Food is available on the grounds beginning 7am each day.

OTHER: Farrier and Veterinarian on call and contact info will be posted. All dogs must be leashed. Management reserves the right to combine, divide, or cancel classes.

GOLF CARTS/MOPEDS: Must be at least 16 year of age, with valid driver's license to operate a golf cart, moped, etc. Golf carts can be rented at <https://www.wecgolfcarts.com>

DRONES: The unauthorized use of Drones on the Competition Grounds or Stabling Area is Strictly Prohibited, and any such use by any person, including owner, rider/competitor, trainer, handler or any associated person will cause all entries to be forfeited.

EVERY CLASS OFFERED HEREIN WHICH IS COVERED BY THE RULES AND SPECIFICATIONS OF THE CURRENT USEF RULEBOOK WILL BE CONDUCTED AND JUDGED IN ACCORDANCE THEREWITH.

Reminder: All USEF Life and Senior Active members, as well as participants who have regular contact with minor athletes, are required to comply with the U.S. Center for SafeSport training requirement, to be eligible to participate in the competition. All participants must adhere to the U.S. Center for SafeSport Code, USEF Safe Sport Policy, and the Minor Athlete Abuse Prevention Policies. More information about these can be found at [www.usef.org](http://www.usef.org).

NUMBERS NOTE: Per DR121.19 "All competitors must complete check-in at the show office and receive a show number, before schooling or riding on the grounds. Failure to check in at the show office prior to schooling will result in the issuance of a Warning Card. Competition-assigned numbers, or the same number in a personal numbering format, must be worn and visible at all times what a horse is being hand-walked, exercised or ridden, under penalty of elimination."

Show Management reserves the right to vary or add officials and refuse any entry for a cause; to disqualify any exhibitor and/or his or her horse for cause; to cause an exhibitor to forfeit his or her ribbons and winnings for cause; to return any entry and/or stall fee before or during the show for cause; all without being liable for damage or compensation. Show management reserves the right to make any changes deemed necessary for the safe and efficient conduct of this competition.

## ENTRY FEES:

ITEM	Cost
Office Charge Per Entry:	\$65 per horse/rider
USEFFee (D&M \$15, USEF \$8):	combination \$23 per horse
GAIG/USDF Qualifying Fee:	\$20 per eligible class
Incomplete Entry Fee ( <b>ANY</b> MISSING DOCUMENTS):	\$25 per entry
Non-competing Horse Fee:	\$125 for entire show
Late Entry Fee (Entries received after closing date):	\$65 per entry
USDF Non-Member Fee:	\$35 for each NM Owner, Rider
USDF Affidavit Fee:	\$5
USDF HID Fee:	\$35 per horse
Return Check and/or Disputed Credit Card Fee:	\$50
Class change Fee, if granted by show Secretary:	\$25 per class
Fax/Emailed Entry Fee:	\$25 per entry
National Horse Stall (See note below about shavings):	\$250 Friday to Sunday
National Tack Stall:	\$250 Friday to Sunday
Ship-in Fee per day:	\$50 per day
Paddock Rental(per week rate only):	\$375 per week(paddocks are a far walk from Dressage Complex)

Musical Freestyles: Music must be presented to announcer in CD and/or digital files(MP3 and/or WAV) at least two hours before scheduled ride. Sound checks provided for no fee, either on the day prior to competition or prior to scheduled ride. The schedule for sound checks will be posted at the show, available on ship in/schooling day. Per USEF DR129.9: "Except for USEF/USDF Championship classes and for FEI Pony Riders, FEI Junior and FEI Young Rider Freestyles, in order to enter a freestyle class at any level, a horse/rider combination must have received a minimum score of 63% for Training through Fourth levels and 60% for FEI levels in the highest test of the declared freestyle level or any test of a higher level at a Federation /USDF Licensed Dressage Competition or FEI recognized Dressage Competition or "open" Dressage class (i.e. open to all breeds) at a Federation Licensed Competition held prior to the competition where the horse/rider combination is entered to ride a freestyle class. To enter an FEI Para Dressage Freestyle class, a horse/rider combination must have received a minimum score of 60% in any FEI Para Dressage test (Para Novice Test, Para Intermediate Test or Para Grand Prix Test) at the rider's classified Grade. This score may be earned at a USEF/USDF licensed Dressage Competition or FEI recognized Dressage Competition or "open" Dressage class (i.e. open to all breeds) at a Federation Licensed Competition held prior to the competition where the horse/rider combination is entered to ride a freestyle class. A photocopy of the test verifying eligibility, or copy of the USDF score verification, must be submitted with the entry for a freestyle class. All FEI Pony Rider Tests are equivalent to Second Level; all FEI Junior Tests are equivalent to Third Level; all FEI Young Rider Tests are equivalent to PSG; and the USEF Brentina Cup (Young Adult) Test and FEI Young Rider Grand Prix 16-25 Tests are equivalent to Intermediate II. For purposes of freestyle qualification, all are considered equivalent to the highest test of that level and may be used to enter a freestyle at that level or a level below. Young Horse and FEI Children Tests cannot be used for freestyle qualification at any level."

	Fri #	Sat #	Sun #	Class Name Any class (*) GAIG/USDF regional qualifying. All Classes Placed by Division	Divisions Offered	Class Fee	Q Fee
		201	301	USDF Intro A	JR-YR / AA / Open	\$75	
		202	302	USDF Intro B	JR-YR / AA / Open	\$75	
		203	303	USDF Intro C	JR-YR / AA / Open	\$75	
		204	304	USEF Training Level Test One - O, AA, J/Y	JR-YR / AA / Open	\$75	
		205	305	USEF Training Level Test Two - O, AA, J/Y	JR-YR / AA / Open	\$75	
		206	306	USEF Training Level Test Three* - O, AA, J/Y	JR-YR / AA / Open	\$75	\$95
		207	307	USEF First Level Test One - O, AA, J/Y	JR-YR / AA / Open	\$75	
		208	308	USEF First Level Test Two - O, AA, J/Y	JR-YR / AA / Open	\$75	
		209	309	USEF First Level Test Three* - O, AA, J/Y	JR-YR / AA / Open	\$75	\$95
		210	310	USEF Second Level Test One - O, AA, J/Y	JR-YR / AA / Open	\$75	
		211	311	USEF Second Level Test Two - O, AA, J/Y	JR-YR / AA / Open	\$75	
		212	312	USEF Second Level Test Three* - O, AA, J/Y	JR-YR / AA / Open	\$75	\$95
		213	313	USEF Third Level Test One - O, AA, J/Y	JR-YR / AA / Open	\$75	
		214	314	USEF Third Level Test Two -O, AA, J/Y	JR-YR / AA / Open	\$75	
		215	315	USEF Third Level Test Three* -O, AA, J/Y	JR-YR / AA / Open	\$75	\$95
		216	316	USEF Fourth Level Test One - O, AA, J/Y	JR-YR / AA / Open	\$75	
		217	317	USEF Fourth Level Test Two - O, AA, J/Y	JR-YR / AA / Open	\$75	
		218	318	USEF Fourth Level Test Three* - O, AA, J/Y	JR-YR / AA / Open	\$75	\$95
		219	319	FEI Prix St Georges* - O, AA, J/Y	JR-YR / AA / Open	\$85	\$105
		220	320	FEI Intermediate I* - O, AA, J/Y	JR-YR / AA / Open	\$85	\$105
		221	321	FEI Intermediate II* - O, AA, J/Y	JR-YR / AA / Open	\$85	\$105
		222	322	FEI Grand Prix* - O, AA, J/Y	JR-YR / AA / Open	\$85	\$105
		223	323	FEI Grand Prix Special – O, AA, J/Y	JR-YR / AA / Open	\$85	
		224	324	USDF Freestyle TOC* (specify test – USDF TR-4th) Training level is not eligible for qualifying	Open	\$85	\$105
		225	325	FEI Freestyle TOC* (specify test)	Open	\$85	\$105
		226	326	FEI or Equivalent TOC* (state test no freestyles, Yng Horse or Para)	Open	\$85	\$105
		227	327	USEF TOC * (state test – no freestyles, Young Horse, or rider tests)	Open	\$85	\$105
		228	328	Quadrille Freestyle TOC(Specify Test/Special Award)		\$85	
				<b>Young Horse</b>			
		231		USEF 4 YR Old Horse Test (Practice)		\$85	
		232	332	FEI Preliminary YH Test for 5-Year-Old (Practice)		\$85	
		233		FEI YH Test for 5-Year-Old – Final (Practice)		\$85	
		234	334	FEI Preliminary YH Test for 6-Year-Old (Practice)		\$85	
		235		FEI YH Test for 6-Year-Old – Final (Practice)		\$85	
		236	336	FEI Preliminary YH Test for 7-Year-Old (Practice)		\$85	
		237		FEI YH Test for 7-Year-Old – Final (Practice)		\$85	
		238		USEF Developing Prix St Georges (Practice)		\$85	
		239		USEF Developing Grand Prix (Practice)		\$85	
				<b>Materiale Division</b>			
		240	340	Three-Year-Old Fillies		\$75	
		241	341	Three-Year-Old Colts/Geldings		\$75	
		242	342	Four and Five-Year-Old Mares		\$75	
		243	343	Four and Five-Year-Old Stallions/Geldings		\$75	

				Pony Classes All Placed by Divisions			
		247	347	USEF Training Level Test One Pony - O, AA, J/Y	JR-YR / AA / Open	\$70	
		248	348	USEF Training Level Test Two Pony - O, AA, J/Y	JR-YR / AA / Open	\$70	
		249	349	USEF Training Level Test Three Pony * - O, AA, J/Y	JR-YR / AA / Open	\$70	\$90
		250	350	USEF First Level Test One Pony - O, AA, J/Y	JR-YR / AA / Open	\$70	
		251	351	USEF First Level Test Two Pony - O, AA, J/Y	JR-YR / AA / Open	\$70	
		252	352	USEF First Level Test Three Pony * - O, AA, J/Y	JR-YR / AA / Open	\$70	\$90
		253	353	USEF Second Level Test One Pony - O, AA, J/Y	JR-YR / AA / Open	\$70	
		254	354	USEF Second Level Test Two Pony - O, AA, J/Y	JR-YR / AA / Open	\$70	
		255	355	USEF Second Level Test Three Pony * - O, AA, J/Y	JR-YR / AA / Open	\$70	\$90
		256	356	USEF Third Level Test One Pony - O, AA, J/Y	JR-YR / AA / Open	\$70	
		257	357	USEF Third Level Test Two Pony - O, AA, J/Y	JR-YR / AA / Open	\$70	
		258	358	USEF Third Level Test Three Pony * - O, AA, J/Y	JR-YR / AA / Open	\$70	\$90

				USEF Qualifying Classes			
				USEF YH Test for 4-Year-Old (Markel/USEF Qualifying)			
				FEI YH Test for 5-Year-Old - Final (Markel/USEF Qualifying /WBC)			
				FEI YH Test for 6-Year-Old - Final (Markel/USEF Qualifying /WBC)			
				FEI YH Test for 7 Year Old – Final (Markel/USEF Qualifying/WBC)			
				USEF Developing PSG (Markel/USEF Qualifying)			
				USEF Developing GP (Markel/USEF Qualifying)			
		265		FEI Para Grand Prix Test A TOC (USEF Qualifying)	Open	\$95	
			366	FEI Para Grand Prix Test B TOC (USEF Qualifying)	Open	\$95	
			367	FEI Para Grand Prix Freestyle TOC (USEF Qualifying)	Open	\$95	
		268		FEI Junior Team (NAYC/USEF Qualify)	JR	\$95	\$115
			369	FEI Junior Individual (NAYC/USEF Qualify)	JR	\$95	
			370	FEI Junior Freestyle (NAYC Qualify)	JR	\$95	
		271		FEI Young Rider Team (NAYC/USEF Qualify)	JR/YR	\$95	\$115
			372	FEI Young Rider Individual (NAYC/USEF Qualify)	JR/YR	\$95	
			373	FEI Young Rider Freestyle (NAYC Qualify)	JR/YR	\$95	
		274		FEI Pony Team (USEF Qualify)	JR	\$95	
			375	FEI Pony Individual (USEF Qualify)	JR	\$95	
		276		FEI Children Team (Markel/USEF Qualify)	JR	\$95	
			377	FEI Children Individual (Markel/USEF Qualify)	JR	\$95	
		278		FEI Intermediate II* (NAYC/USEF Qualify)		\$95	\$115
			379	FEI Grand Prix 16-25 (NAYC/USEF Qualify)		\$95	
		280		FEI Prix St Georges* (USEF Qualify)	Open	\$95	\$115
			381	FEI Intermediate I* (USEF Qualify)	Open	\$95	\$115
		282		FEI Grand Prix* (USEF Qualify)	Open	\$95	\$115
			382	FEI Grand Prix Special (USEF Qualify)	Open	\$95	
			382F	FEI Freestyle TOC (USEF Qualify)	Open	\$95	\$115
				<b>USEF Qualifying Para Intermediate I &amp; Children Prelim</b>			
		283		FEI Para Intermediate A TOC		\$95	
			384	FEI Para Intermediate B TOC		\$95	
			385	FEI Para Intermediate Freestyle TOC		\$95	
			386	FEI Children Preliminary TOC (USEF/NAYC Qualify)	JR	\$95	

**Motorized Vehicle Statement:**

Minors who do not have a valid driver's license which allows them to operate a motorized vehicle in the state in which they reside will not be permitted to operate a motorized vehicle of any kind, including, but not limited to, golf carts, motorcycles, scooters, or farm utility vehicles, on the competition grounds of licensed competitions. Minors who have a valid temporary license may operate the above-described motorized vehicles as long as they are accompanied by an adult with a valid driver's license. The parent/legal guardian or individual who signs the entry blank as a parent or guardian of a minor operating a motorized vehicle in violation of this rule are solely responsible for any damages, claims, losses or actions resulting from that operation. Violations of this rule will cause for penalties against those responsible for the child committing the offense. Wheelchairs and other mobility assistance devices for individuals with disabilities are exempt from this rule. The unsafe use of personal electronic transport devices, as determined by the competition officials and management in their sole discretion, that do not require a driver's license to operate, including but not limited to segways, hoverboards, and single wheeled scooters is prohibited on competition grounds. Operating such devices in areas where people gather may be deemed "unsafe use" if there is a risk of harm to others. If the operator of the device is a minor, the parent/legal guardian or individual who signs the entry blank as a parent or guardian of a minor operating the device in violation of this rule is accountable and may be subject to penalties. Wheelchairs and other mobility assistance devices for individuals with disabilities are exempt from this rule.

**Membership Statement:**

Life, senior active and junior active members shall be eligible to participate in all classes at Regular Competitions, Eventing Competitions at the Modified Level or above and Combined Driving Competitions at the Advanced Level, Dressage, Reining and Vaulting Competitions and Endurance Rides. A non-member may participate as a handler, rider, driver, owner, lessee, or agent at Regular Competitions, Eventing Competitions, Dressage Competitions, Reining Competitions and Combined Driving Competitions upon payment of a Show Pass fee. Participants in the following classes are exempted from the Requirements of this rule: 1) leadline; 2) exhibitions; 3) games and races; 4) classes for 4-H members; 5) walk trot and academy classes (academy classes are classes limited to horses used regularly in a lesson program); 6) USDF introductory level tests, pas de deux and quadrille classes; 7) assistant handlers in Dressage Sport Horse Breeding classes.

**Protective Headgear:**

Protective headgear is defined as a riding helmet, which meets or exceeds current ASTM (American Society for Testing and Materials)/SEI (Safety Equipment Institute) standards for equestrian use and carries the SEI tag. From the time horses are officially admitted to the competition grounds by competition management, anyone mounted on a horse at any time on the competition grounds, including non-competing riders, riders on non-competing horses, mounted participants in exhibition classes, and those competing in all classes and tests, including Para Dressage tests, must wear protective headgear as defined by this rule and otherwise in compliance with GR801. The harness must be secured and properly fitted. Any rider violating this rule at any time must immediately be prohibited from further riding until the headgear is properly in place. Protective headgear may be the same as or a coordinating color with the coat, and may include contrast coloring, accent, and crystal decoration. See DR136 for dress code rules for exhibitions.

**Sharps Container:**

Competition management shall place a minimum of one sharps container per each competition, whether or not stabling is provided. Additionally, at least one sharps container per fifty occupied stalls for the disposal of needles and other disposable sharp instruments in convenient locations in barns housing competition horses. It is competition management's responsibility to replace such containers when full and dispose of them properly. Competition management may fine any individuals including trainers, owners, exhibitors, or their agents up to \$100 for improper disposal of needles or other sharp disposable instruments. Competition management will place a notice of this requirement either in its prize list or on a specific handout given to trainers on check in at the competition. If local law has different requirements, local law will prevail. Competitions failing to comply with placing the required number of containers on the show grounds will be considered in violation of the rules and may be subject to penalty as determined by the CEO or his designee and/or the Hearing Committee.

**Safe Sport Reminder:**

All USEF Life and Senior Active members, as well as participants who have regular contact with minor athletes, are required to comply with the U.S. Center for SafeSport training requirement to be eligible to participate in the competition. All participants must adhere to the U.S. Center for SafeSport Code, USEF Safe Sport Policy, and the Minor Athlete Abuse Prevention Policies. More information about these can be found at [www.usef.org](http://www.usef.org).

**Equine Vaccination Rule:**

At Federation licensed competitions horses, more than 7 months of age, entering the grounds must be accompanied by documentation of Equine Influenza Virus and Equine Herpes Virus (Rhinopneumonitis) vaccinations within six months prior to entering the stables. Horses not in compliance with this rule may be required to leave the competition grounds upon request by Competition Management.

**Pony Measurements:**

Please make an appointment in the show office.



# Directions to World Equestrian Center

GPS Address For Competitors For Arena 6/ &  
Dressage Rings : 8747 W Hwy 40, Ocala FL 34482

From I-75: Take Exit 352, to FL-40W for 6 miles to World Equestrian Center Entrance. Turn right onto NW 87th Ct Rd. Continue past Expo Centers 1 & 2. Stabling is in Barns X & Y. Dressage Show Office located will be inside Indoor Arena 6. Follow posted signs regarding Trailer Parking

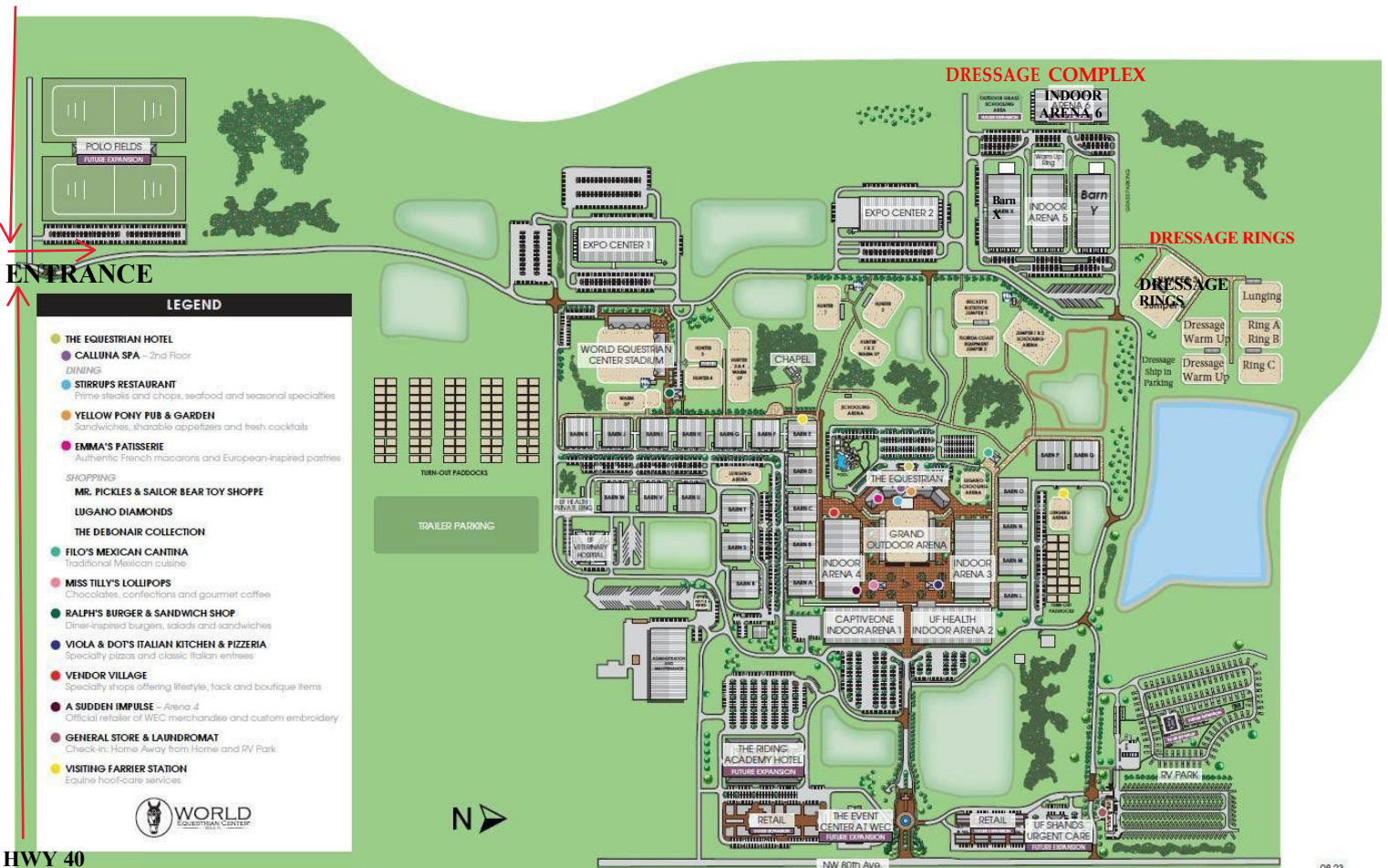

**USDF Membership Benefits:** USDF is dedicated to education, the recognition of achievement, and promotion of dressage. For details on member benefits, including educational programs, awards, and other opportunities, refer to the *USDF Member Guide* or the USDF website at [www.usdf.org](http://www.usdf.org).

**This  
competition  
is recognized  
by USDF  
for 2024**

**Membership Requirements for USEF-licensed/USDF-recognized Competitions:** Owners and riders, including foreign riders and owners who are not residents of the US, wishing to participate in a USEF-licensed/USDF-recognized competition as a rider or owner/lessee, must have either a USDF Group Membership (GM), Participating Membership (PM), or have a USDF Non-Member (NM) identification number and pay the USDF Non-Member (NM) fee. (Note: USDF Business Members can own horses but cannot compete as riders with their USDF Business Membership.)

Horses competing at USEF-licensed/USDF-recognized competitions must have either a USDF Horse Identification (HID) number or a USDF Lifetime Horse Registration (LHR). Proper credentials or verification certificates must be presented to the competition secretary.

Riders and owners wishing to participate in a USEF-licensed/USDF-recognized competition, and not able to present the competition secretary with verification of a USDF membership or NM identification, and USDF LHR or USDF HID, must complete a USDF Competition Affidavit Form and pay the \$5 affidavit filing fee. A copy of a completed affidavit form from another competition may also be used for verification purposes for up to 60 days. (Exception: Affidavits cannot be used at Great American Insurance Group/USDF Regional Dressage Championships.)

#### **Exceptions:**

- Horses competing only in Individual Breed Classes (IBCs) at DSHB competitions, sires and dams of horses in DSHB group classes, where those sires or dams are not actually competing in the same competition, horses competing only in breed restricted dressage or DSHB classes at Regular Competitions (e.g. all Arabian, all Friesian, all Morgan classes), or in USDF Introductory Level tests, pas de deux or quadrille, are exempt from this requirement. Also exempt are horses ridden in leadline, exhibitions, games and races, classes for 4-H members, walk-trot, academy, and opportunity classes.
- Riders and owners/lessees competing only in classes which are exempt from the USDF HID requirements are also exempt from the USDF NM identification number and NM fee requirements. Also exempt are handlers of horses competing in DSHB In-Hand or Group classes.

#### **Memberships Defined**

**Participating Membership (PM):** A membership issued to an individual directly by USDF. The membership year is December 1 through November 30. PMs are available for 1-year (\$90), 5-years (\$360), or life (\$1,800). A USDF Youth Participating Membership (YPM) is available for individuals who have not reached their 21<sup>st</sup> birthday by December 1 of the current membership year (\$72). A PM allows the member to compete at USEF-licensed/USDF-recognized competitions and to participate as a rider and/or owner/lessee for all Adequan®/USDF Year-End Awards and the Great American Insurance Group/USDF Regional Dressage Championship program.

**Group Membership (GM):** A membership issued to an individual by USDF when the member name and dues are submitted to USDF through an affiliate Group Member Organization (GMO). The GM year begins December 1 and ends November 30. A GM allows the member to compete at USEF-licensed/USDF-recognized competitions and participate in the USDF Rider Awards Program and the USDF Regional Schooling Show Awards Program.

**Business Membership (BM):** A membership that runs December 1 through November 30 and is issued to a business or organization directly by USDF. The USDF BM (\$240) offers a wider variety of advertising benefits. BMs satisfy requirements of horse ownership only.

**Non-Member (NM) Identification Number:** For each USDF NM owner/lessee and USDF NM rider there will be a USDF NM fee of \$35 per competition that must be collected by the show secretary and submitted to USDF, along with the USDF Report of Fees document and the \$5 affidavit fee and Competition Affidavit Form if the person cannot provide a copy of their USDF NM card. Owners/lessees or riders exempt from the NM number requirements are also exempt from paying the USDF NM fee. If there are multiple owners of a horse and all are NMs, only one of the owners must pay the NM fee. If the horse has at least one owner who is a current USDF PM, GM, or BM there is no NM fee assessed. Competition management will be invoiced for all applicable USDF NM fees not received with the USDF post-competition paperwork, along with a report listing all USDF NMs. Competition management is then required to submit the NM fees within 30 days to the USDF. An individual with a USDF NM identification number is not eligible for any USDF membership benefits. Once a USDF NM number has been assigned, a USDF NM card can be obtained from the USDF website.

**Horse Identification (HID) Number:** A one-time tracking number for horses (\$35). Scores earned by a horse with an HID number will be recorded but will NOT be counted towards Adequan®/USDF Year-End Awards. A horse with an HID number is not eligible to compete in Great American Insurance Group/USDF Regional qualifying or championship classes. An HID number can be upgraded to a Lifetime Horse Registration (LHR) for a fee of \$80. If a horse has a USDF LHR it does not need an HID number. An HID number is a one-time fee that does not need to be renewed.

**Lifetime Horse Registration (LHR):** A horse with an LHR (\$115) is eligible for Adequan®/USDF Year-End Awards, and eligible to compete in Great American Insurance Group/USDF Regional qualifying and championship classes, assuming requirements for the owner and rider are met. If a horse has an LHR it does not need an HID number. An LHR does not need to be renewed.

#### **How to Join USDF**

Applications for USDF Participating Membership (PM), Business Membership (BM), Horse Identification (HID) number, and Lifetime Horse Registration (LHR) may be found in the following locations:

- On the USDF website: [www.usdf.org](http://www.usdf.org). You can submit the application online or download the form.
- In the show office at USEF-licensed/USDF-recognized competitions classified by USEF as Dressage Competitions, and Regular Competitions which are open to all breeds.
- By calling or writing the USDF office at (859) 971-2277, 4051 Iron Works Parkway, Lexington, KY 40511

The effective date of membership is the date the form and correct fees are received in the USDF office or, if applying at a competition, the date accepted by the competition secretary, provided the application is signed and dated by the competition secretary, member, and/or horse owner on that same day.





## 2025 Great American Insurance Group/USDF Regional Dressage Championships

A single Regional Dressage Championship program organized by the United States Dressage Federation (USDF), and recognized by the United States Equestrian Federation, Inc. (USEF), will be held in each of the nine USDF regions. In addition, Alaska and Hawaii may each hold state championships if an official request from a Group Member Organization (GMO) is received by April 1 of the prior year. The Regional Championship Program Rules can be found on the USDF website at [www.usdf.org](http://www.usdf.org). Please refer to the 2025 USDF Member Guide for the comprehensive list of rules and requirements for this program.

### Membership/Registration Requirements for Qualifying and Championships

*All memberships and registrations/recordings must be correct and current at the time qualifying scores are earned and at the time of the championships.*

Rider:

- Must have a USDF Participating\* Membership (PM).
- Must have a USEF membership (Active or Life).

Horse:

- Must have a USDF Lifetime Horse Registration (LHR).
- Must have a USEF (Annual or Lifetime) Horse Recording.
- USDF horse registration and USEF horse recording must be in the name(s) of the current owner(s) or lessee(s).  
A horse is not required to have breed registry papers.
- Horses must be entered in qualifying and championship classes under their official recorded names and ownership as specified in USEF GR1102.3, and transfers of ownership or lease registrations must be completed in compliance with USEF rules GR1105 and GR1108 prior to the competition in order for the horse to compete under the name of the new owner or lessee. (USEF DR127.2)

Owner:

- Must have a USDF Participating or Business Membership and a USEF membership (Active or Life Membership or Annual or Life Recorded Farm/Business). If the horse has more than one owner, at least one owner must have both active USEF membership and active USDF Participating or Business Membership and must be the owner of record with USEF and USDF. For a business or farm to be the valid owner under this requirement, it must be listed as an owner of the horse with both USEF and USDF.

\* PMs are USDF members who join USDF directly. USDF Group Members (GM) are ineligible.

**Minimum Qualifying Scores:** One set of nationally-standardized qualifying scores has been established for all USEF/USDF Regional Championships, for Training Level through Grand Prix, in three divisions: open, adult amateur and junior/young rider.

The minimum percentages are as follows:

	OPEN	AA	JR/YR
Training Level (Test 3)	68%	63%	63%
First Level (Test 3)	66%	62%	62%
Second Level (Test 3)	64%	61%	61%
Third Level (Test 3)	62%	60%	60%
Fourth Level (Test 3)	62%	60%	60%
Prix St. Georges	62%	60%	60%
Intermediate I	62%	60%	60%
Intermediate II	62%	60%	60%
Grand Prix	60%	60%	60%
<b>FREESTYLE</b>	<b>OPEN/Jr/YR</b>	<b>AA</b>	
First Level	65%	65%	
Second Level	65%	65%	
Third Level	65%	65%	
Fourth Level	65%	65%	
Intermediate I	65%	65%	
Grand Prix	65%	65%	

USEF Competition Name: World Equestrian Center October Dressage

USEF#: 340529

Competition Division(s) and Rating(s):

Dressage Level 3

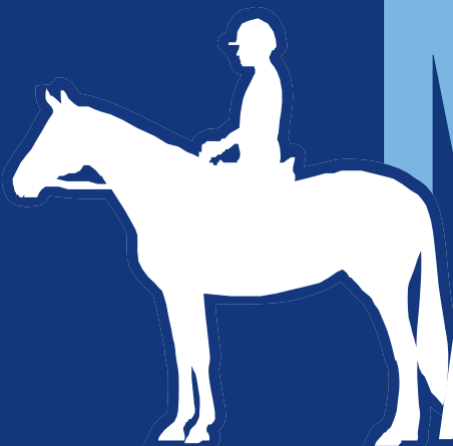

# MAAPP

## MINOR ATHLETE ABUSE PREVENTION

### LEARN ABOUT MAAP POLICIES



Safe Sport Training



Local Travel



One-On-One Interactions



Social Media & Electronic Communications



Read about these & more at [usef.org/MAAPP](https://usef.org/MAAPP)

### REPORT MAAP POLICY VIOLATIONS



[usef.org/safe-sport/reporting](https://usef.org/safe-sport/reporting)

859-225-6915 or Text Anonymously 855-682-8733







# FEDERATION ENTRY AGREEMENT

By entering a Federation-licensed Competition and signing this entry blank as the Owner, Lessee, Trainer, Manager, Agent, Coach, Driver, Rider, Handler, Vaulteur or Longeur and on behalf of myself and my principals, representatives, employees and agents, I agree that I am subject to the Bylaws and Rules of the United States Equestrian Federation, Inc. (the "Federation") and the local rules of \_\_\_\_\_ (Competition). I agree to be bound by the Bylaws and Rules of the Federation and of the competition. I will accept as final the decision of the Hearing Committee on any question arising under the Rules, and agree to release and hold harmless the competition, the Federation, their officials, directors and employees for any action taken under the Rules. I represent that I am eligible to enter and/or participate under the Rules, and every horse I am entering is eligible as entered. I also agree that as a condition of and in consideration of acceptance of entry, the Federation and/or the Competition may use or assign photographs, videos, audios, cable - casts, broadcasts, internet, film, new media or other likenesses of me and my horse taken during the course of the competition for the promotion, coverage or benefit of the competition, sport, or the Federation. Those likenesses shall not be used to advertise a product and they may not be used in such a way as to jeopardize amateur status. I hereby expressly and irrevocably waive and release any rights in connection with such use, including any claim to compensation, invasion of privacy, right of publicity, or to misappropriation. The construction and application of Federation rules are governed by the laws of the State of New York, and any action instituted against the Federation must be filed in New York State. See GR908.4.

If not currently a USEF Active Competing member or Subscriber, I acknowledge that I will be enrolled for no cost as a USEF Fan and my USEF Fan Account will continue to annually automatically renew in USEF's sole discretion. Additionally, I acknowledge that the benefits of a USEF Fan are subject to change without notice. USEF may in its sole discretion, at any time, terminate my USEF Fan status.

**BY SIGNING BELOW, I AGREE** that I have read, understand, and agree to be bound by all applicable Federation Bylaws, rules, and policies including the USEF Safe Sport Policy and Minor Athlete Abuse Prevention Policies (MAAPP) as published at www.usef.org, as amended from time to time, as well as all terms and provisions of this Prize List. If I am signing and submitting this Agreement electronically, I acknowledge that my electronic signature shall have the same validity, force and effect as if I affixed my signature by my own hand.

**RIDER/DRIVER/HANDLER/VAULTER/LONGEUR** (mandatory)

Signature: \_\_\_\_\_

Print Name: \_\_\_\_\_

**TRAINER** (mandatory)

Signature: \_\_\_\_\_

Print Name: \_\_\_\_\_

**OWNER/AGENT** (mandatory)

Signature: \_\_\_\_\_

Print Name: \_\_\_\_\_

**COACH** (if applicable)

Signature: \_\_\_\_\_

Print Name: \_\_\_\_\_

Parent/Guardian Signature: (Required if Rider/Driver/Handler/Vaulteur/Longeur is a minor) \_\_\_\_\_

Print Parent//Guardian Name: \_\_\_\_\_ Emergency Contact Phone No. \_\_\_\_\_

Is Rider/Driver/Vaulteur a U.S. Citizen:  Yes  No



# WAIVER AND RELEASE OF LIABILITY, ASSUMPTION OF RISK AND INDEMNITY AGREEMENT

For and in consideration of United States Equestrian Federation, Inc. dba US Equestrian ("USEF") allowing me, the undersigned, to participate in any capacity (including as a rider, driver, handler, vaulter, longeur, lessee, owner, agent, coach, official, trainer or volunteer) in a USEF sanctioned, licensed or approved event or activity, including but not limited to equestrian clinics, practices, shows, competitions and related or incidental activities and \_\_\_\_\_ ("USEF Event" or "USEF Events"); I, for myself, and on behalf of my spouse, children, heirs and next of kin, and any legal and personal representatives, executors, administrators, successors, and assigns, hereby agree to and make the following contractual representations pursuant to this Agreement (the "Agreement"):

A. RULES AND REGULATIONS: I hereby agree that I have read, understand, and agree to be bound by all applicable Federation Bylaws, rules, and policies including the USEF Safe Sport Policy and Minor Athlete Abuse Prevention Policies (MAAPP) as published at www.usef.org, as amended from time to time.

B. ACKNOWLEDGMENT OF RISK: I knowingly, willingly, and voluntarily acknowledge the inherent risks associated with the sport of equestrian and know that horseback riding and related equestrian activities are inherently dangerous, and that participation in any USEF Event involves risks and dangers including, without limitation, the potential for serious bodily injury (including broken bones, head or neck injuries), sickness and disease (including communicable diseases), trauma, pain & suffering, permanent disability, paralysis and death; loss of or damage to personal property (including my mount & equipment) arising out of the unpredictable behavior of horses; exposure to extreme conditions and circumstances; accidents involving other participants, event staff, volunteers or spectators; contact or collision with other participants and horses, natural or manmade objects; adverse weather conditions; facilities issues and premises conditions; failure of protective equipment (including helmets); inadequate safety measures; participants of varying skill levels; situations beyond the immediate control of the USEF Event organizers and competition management; and other undefined, not readily foreseeable and presently unknown risks and dangers ("Risks").

### WARNING:

**Under Florida law, an equine activity sponsor or equine professional is not liable for an injury to, or the death of, a participant in equine activities resulting from the inherent risks of equine activities.**

C. ASSUMPTION OF RISK: I understand that the aforementioned Risks may be caused in whole or in part or result directly or indirectly from the negligence of my own actions or inactions, the actions or inactions of others participating in the USEF Events, or the negligent acts or omissions of the Released Parties defined below, and I hereby voluntarily and knowingly assume all such Risks and responsibility for any damages, liabilities, losses, or expenses that I incur as a result of my participation in any USEF Events. I also agree to be responsible for any injury or damage caused by me, my horse, my employees or contractors under my direction and control at any USEF Event.

D. WAIVER AND RELEASE OF LIABILITY, HOLD HARMLESS AND INDEMNITY: In conjunction with my participation in any USEF Event, I hereby release, waive and covenant not to sue, and further agree to indemnify, defend and hold harmless the following parties: USEF, USEF Recognized Affiliate Associations, the United States Olympic & Paralympic Committee (USOPC), USEF clubs, members, Event participants (including athletes/riders, coaches, trainers, judges/officials, and other personnel), the Event owner, licensee, and competition managers; the promoters, sponsors, or advertisers of any USEF Event; any charity or other beneficiary which may benefit from the USEF Event; the owners, managers, or lessors of any facilities or premises where a USEF Event may be held; and all directors, officers, employees, agents, contractors, and volunteers of any of the aforementioned parties (**Individually and Collectively, the "Released Parties" or "Event Organizers"**), with respect to any liability, claim(s), demand(s), cause(s) of action, damage(s), loss, or expense (including court costs and reasonable attorney fees) of any kind or nature ("**Liability**") which may arise out of, result from, or relate in any way to my participation in the USEF Events, including claims for Liability caused in whole or in part by the negligent acts or omissions of the Released Parties.

E. COMPLETE AGREEMENT AND SEVERABILITY CLAUSE: This Agreement represents the complete understanding between the parties regarding these issues and no oral representations, statements or inducements have been made apart from this Agreement. If any provision of this Agreement is held to be unlawful, void, or for any reason unenforceable, then that provision shall be deemed severable from this Agreement and shall not affect the validity and enforceability of any remaining provisions.

**I HAVE CAREFULLY READ THIS DOCUMENT IN ITS ENTIRETY, UNDERSTAND ALL OF ITS TERMS AND CONDITIONS, AND KNOW IT CONTAINS AN ASSUMPTION OF RISK, RELEASE AND WAIVER FROM LIABILITY, AS WELL AS A HOLD HARMLESS AND INDEMNIFICATION OBLIGATIONS.**

By signing below, that I have read, understand, and agree to be bound by all applicable Federation Bylaws, rules, and policies including the USEF Safe Sport Policy and Minor Athlete Abuse Prevention Policies (MAAPP) as published at www.usef.org, as amended from time to time, as well as all terms and provisions of this Prize List. If, despite this Agreement, I, or anyone on my behalf or the minor's behalf, makes a claim for Liability against any of the Released Parties, I will indemnify, defend and hold harmless each of the Released Parties from any such Liabilities as the result of such claim.

**The parties agree that this agreement may be electronically signed. The parties agree that the electronic signatures appearing on this agreement are the same as handwritten signatures for the purposes of validity, enforceability, and admissibility.**

RIDER/DRIVER/HANDLER/VAULTER/LONGEUR  OWNER  TRAINER  OFFICIAL  STAFF  VOLUNTEER  COACH (IF APPLICABLE)

Signature: \_\_\_\_\_ Date: \_\_\_\_\_ Print Name: \_\_\_\_\_

Parent/Guardian Signature: (Required if Rider/Driver/Handler/Vaulter/Longeur is a minor) \_\_\_\_\_ Date: \_\_\_\_\_

Print Parent//Guardian Name: \_\_\_\_\_ Emergency Contact Phone No. \_\_\_\_\_