

SERIES 2025

# SUMMER

WORLD EQUESTRIAN CENTER® | OCALA





**Summer Series Opener 6/4 - 6/8**

*Regional Hunter/Level 6 Jumper*

**Summer Series I 6/10 - 6/15**

*CSI2\*/Premier Hunter/Level 6 Jumper*

**Summer Series II 6/17 - 6/22**

*CSI3\*/Premier Hunter/Level 6 Jumper*

**Summer Series III 6/24 - 6/29**

*CSI4\*, 2\*/Premier Hunter/Level 6 Jumper*

**Summer Series IV 7/1 - 7/6**

*CSI2\*/National Hunter/Level 6 Jumper*

**Summer Series V 7/8 - 7/13**

*CSI3\*/Premier Hunter/Level 6 Jumper*

**Summer Series VI 7/15 - 7/20**

*CSI3\*/Premier Hunter/Level 6 Jumper*

**Summer Series VII 7/22 - 7/27**

*CSI2\*/Premier Hunter/Level 6 Jumper*

**Summer Series VIII 7/29 - 8/3**

*CSI2\*/Premier Hunter/Level 6 Jumper*

**Summer Series IX 8/5 - 8/10**

*CSI3\*/National Hunter/Level 6 Jumper*



Quality. Class. Distinction.

Wilmington | Ocala • [wec.net](http://wec.net)





## COMPETITION STAFF

<b>Competition Management:</b>	Arena Horse Shows of Ocala, LLC
<b>Director of Equestrian Operations:</b>	Tom Hern
<b>Show Manager:</b>	Jon Garner
<b>Equestrian Operations:</b>	Greg Wheat
<b>Equine Operations Manager:</b>	Steve Morrison
<b>Operations Assistant:</b>	Shelley Page
<b>Show Office Manager:</b>	Kelly McCabe
<b>Vendor Relations:</b>	Rachel Rothenberg
<b>Sponsor Relations:</b>	Jim Wolf, Karla Cambell
<b>Media Relations:</b>	Leah Tong, Brianna Miller
<b>Show Office:</b>	Julie Madison, Michael Montriell, Felicia Bradley, Roni Tumminia
<b>Stabling Office/ Feed &amp; Bedding:</b>	Mackenzie Weller <a href="mailto:Ocalastalls@wec.net">Ocalastalls@wec.net</a>  352.414.3650
<b>Awards &amp; Hospitality:</b>	Jennifer Glass, Becky Warner
<b>Show Veterinarian:</b>	Dr. Larry Wexler   352.812.1411
<b>Show Farrier:</b>	Farriers, Inc.   352.812.2812

## SHOW APPROVALS

United States Equestrian Federation (USEF)  
United States Hunter Jumper Association (USHJA)  
NAL  
WIHS  
National Horse Show  
NCEA  
World Equestrian Center  
FEI  
National Medal Series

## EMERGENCY INFORMATION

**Nearest Hospital** - 9 miles  
Ocala Regional Medical Center  
1431 SW 1st Ave., Ocala, FL 34471  
352.401.1101

**Nearest Level 1 Trauma Center** - 37 miles  
University of Florida Shands Hospital  
1515 SW Archer Rd., Gainesville, FL 32608  
352.733.0111

## ENTRIES & STALL RESERVATIONS

USEF/USHJA Membership, Amateur and Measurement Cards will be electronically verified with the USEF. Provided you have submitted a COMPLETE entry blank, including all required numbers and signatures, you will not be required to show us your membership cards, measurement cards, or recording cards. If you applied online, you will be given an instant number. Include it on your entry. Incomplete entry forms will be charged a fee of \$50 (considered late entry) and will be required to show proof of membership, etc. before number will be released. Competitors are responsible for their own errors and those of their agents in the preparation of their entry forms. Please ensure your entry form has been properly filled out.

### Online Entries:

**Reserve stalls and create entries through**  
**[HorseShowing.com](http://HorseShowing.com)**

**Closing Dates:** The Monday the week before the start of the competition week to avoid late fees.

**Stalls/paddocks:** Subject to availability. Reserve online through [HorseShowing.com](http://HorseShowing.com).

### Please Mail Checks To:

World Equestrian Center - Ocala  
Attn: Kelly McCabe-Cyphert  
PO Box 771437  
Ocala, FL 34477

### Contact/Shipping Information:

World Equestrian Center - Ocala  
WEC General Store  
8105 NW 21st Street  
Ocala, FL 34482  
352.414.7900

## 2025 SUMMER SERIES FEATURED CLASSES

### CIRCUIT HIGHLIGHTS

# \$2,650,000

in Prize Money & Awards

#### Week II, June 17 - 22

The South Standlee/USHJA National Hunter Derby Championship, featuring three derbies: open, junior and amateur, each boasting \$12,500 in prize money

#### Week V, July 8 - 13

\$40,000 International Hunter Derby

### FEI HIGHLIGHTS

# \$1,773,000

Total Prize Money

Week I CSI2\*: \$140,000

Week II CSI3\*: \$195,000

Week III CSI4\*: \$313,000 | CSI2\*: \$130,000

Week IV CSI2\*: \$130,000

Week V CSI3\*: \$195,000

Week VI CSI3\*: \$195,000

Week VII CSI2\*: \$130,000

Week VIII CSI2\*: \$130,000

Week IX CSI3\*: \$195,000





## 2025 SUMMER SERIES FEATURED CLASSES

### NATIONAL HIGHLIGHTS

**\$390,000**

Total Prize Money

**\$50,000 WEC Grand Prix**

Weeks 1, 2, 4-9

**\$24,000 WEC Welcome Prix**

Weeks 1, 2, 4-9

**\$10,000 Futures Prix**

Weeks 1-9

**\$40,000 International Hunter Derby**

Week 5

**\$12,500 Standlee/USHJA**

**Open, Amateur & Junior National  
Hunter Derby Regional Championships**

Week 2

**\$12,500 WEC 3'6"-3'9" Hunter Derby**

Weeks 1-3, 5-8

**\$10,000 USHJA 3' Open National Hunter Derby**

Weeks 1-3, 5-8

**\$10,000 USHJA 3' Junior/Amateur National Hunter Derby**

Weeks 1-3, 5-8

**\$2,500 WEC Non-Pro Hunter Derby**

Weeks 1-3, 5-8

**\$2,000 USHJA Pony Hunter Derby**

Weeks 1-3, 5-8

**\$7,500 USHJA WEC 3'6"-3'9" Hunter Derby**

Weeks 4, 9

**\$5,000 Open National Hunter Derby**

Weeks 4, 9

**\$5,000 Junior/Amateur National Hunter Derby**

Weeks 4, 9

**\$1,500 WEC Non-Pro Hunter Derby**

Weeks 4, 9

**\$1,000 USHJA Pony Hunter Derby**

Weeks 4, 9



# 2025 WORLD EQUESTRIAN CENTER SUMMER SERIES

## OFFICIALS

Show Dates	Jumper Judges	Hunter Judges	Announcers	Stewards	Course Designers
Summer Series Opener 06/3-6/8	Matt Siemion Pat Muskus Lucie McKinney	Skip Thornbury Winn Alden Ronnie Beard	Todd Rossi Amanda Csoltko Brandan Fellows Paul Delbrook Kenn Marash Terry Mason	Tom Hamilton David Sanderson	Andy Christiansen
Summer Series I 6/10-6/15	Lucie McKinney Annette Longnecker	Robert McNeel Rob Bielfeld Amy Nunnally Dale Pederson Jeanne Marie Miller	Todd Rossi Amanda Csoltko Brandan Fellows Paul Delbrook Kenn Marash Terry Mason	David Sanderson Tom Hamilton	Andy Christiansen Brody Robertson Tucker Williams Dean Rheinheimer
Summer Series II 6/17-6/22	Lucie McKinney Bridget Nolan	O. King Hackley III Kris Nixon Carole O'Brien Fifi Schmidt Lauren Schweppe Irving Evans	Michael Howell Todd Rossi Brandan Fellows Paul Delbrook Kenn Marash Terry Mason	Nannet Read David Sanderson Tom Hamilton Joni Moloney	Gui Jorge Catsy Cruz Tommy Brawley Dean Rheinheimer
Summer Series III 6/24-6/29	Lucie McKinney Bridget Nolan	Mary Babick Knowlton Richard Slocum Mindy Coleman William Sparks Kat Demas	Michael Howell Todd Rossi Brandan Fellows Paul Delbrook Kenn Marash Terry Mason	Nannet Read David Sanderson Tom Hamilton Lisa Taconi Wendy Silverwood Joni Moloney Mikey Rodriguez	Alan Wade Gui Jorge Brody Robertson Dean Rheinheimer Tucker Williams
Summer Series IV 7/1-7/6	Lucie McKinney Bridget Nolan	Chuck Mayer Mike Rosser Andrea Wells Tammy Provost Kathleen Rice	Michael Howell Todd Rossi Brandan Fellows Paul Delbrook Kenn Marash Terry Mason	Nannet Read Tom Hamilton Lisa Taconi Wendy Silverwood Joni Moloney	Manuel Esparza Tucker Williams Peter Grant Dean Rheinheimer
Summer Series V 7/8-7/13	Lucie McKinney Bridget Nolan	Creigh Duncan Keith Hastings Jimmy Lee Traci Weston Amy Eidson	Michael Howell Todd Rossi Brandan Fellows Paul Delbrook Kenn Marash Terry Mason	Nannet Read Tom Hamilton Joni Moloney	Peter Grant Chris Barnard Dean Rheinheimer Tucker Williams

# 2025 WORLD EQUESTRIAN CENTER SUMMER SERIES

## OFFICIALS

Show Dates	Jumper Judges	Hunter Judges	Announcers	Stewards	Course Designers
Summer Series VI 7/15-7/20	Lucie McKinney Bridget Nolan	Peter Stoekel Heide Casciaro Clair Kellner Gregory Franklin	Michael Howell Todd Rossi Brandan Fellows Paul Delbrook Kenn Marash Terry Mason	Tom Hamilton Joni Moloney	Anderson Lima Peter Grant Tucker Williams Dean Rheinheimer
Summer Series VII 7/22-7/27	Lucie McKinney Bridget Nolan	Jean McKinney Mark Jungherr Maria Takacs Mindy Coleman Andrea Wells	Michael Howell Todd Rossi Brandan Fellows Paul Delbrook Kenn Marash Terry Mason	Nannet Read Tom Hamilton Danielle Ackley Joni Moloney	Steve Stephens Catsy Cruz Dean Rheinheime Tucker Williams
Summer Series VIII 7/29-8/3	Lucie McKinney Bridget Nolan	Timmy Kees Diana Carney Tony Sgarata Melissa Murphy Todd Karn	Michael Howell Todd Rossi Brandan Fellows Paul Delbrook Kenn Marash Terry Mason	Nannet Read Tom Hamilton Wendy Silverwood Joni Moloney	Catsy Cruz Chris Barnard Andy Christiansen Dean Rheinheimer
Summer Series VI 8/5-8/10	Lucie McKinney Bridget Nolan	Streett Moore Scott Hofstetter Scott Williamson Jamie Stryker Monica Hunt	Michael Howell Todd Rossi Brandan Fellows Paul Delbrook Kenn Marash Terry Mason	Nannet Read Lisa Taconi Tom Hamilton Travis Page Joni Moloney	Leopoldo Palacios Andy Christiansen Dean Rheinheimer Tucker Williams

## DIRECTIONS TO THE WORLD EQUESTRIAN CENTER

### FROM I-75 SOUTH

- Take exit 352
- Turn left onto State Road 40
- In approximately 4 miles, turn right onto NW 80th Ave.
- Parking will be on your left, 2 miles ahead.

### FROM I-75 NORTH

- Take exit 354
- Turn right onto NW Blichton Road
- In approximately 4 miles, turn right onto NW 80th Ave.
- Parking will be on your left, 2 miles ahead.

### FROM ORLANDO

- Take FL-408 Eastbound (Toll Road)
- Take Florida's Turnpike to I-75 North
- Turn left onto State Road 40
- In approximately 4 miles, turn right onto NW 80th Ave.
- Parking will be on your left, 2 miles ahead.



# 2025 WORLD EQUESTRIAN CENTER SUMMER SERIES

## HORSE SHOW RULES

Every class offered herein which is covered by the rules and specifications of the current federation rule book and current FEI rules will be conducted and judged in accordance therewith.

### 2025 USEF MEMBERSHIP STATEMENT

Life, senior active and junior active members shall be eligible to participate in all classes at Regular Competitions, Eventing Competitions at the Modified Level or above, Combined Driving Competitions at the Advanced Level, Dressage Competitions, Endurance Rides and Vaulting Competitions: (See GR828.4 of the Federation rules). Life, senior active and junior active members shall be eligible to participate in all classes at Regular Competitions, Eventing Competitions at the Modified Level or above and Combined Driving Competitions at the Advanced Level, Dressage, Reining and Vaulting Competitions and Endurance Rides. A non-member may participate as a handler, rider, driver, owner, lessee, or agent, at Regular Competitions, Eventing Competitions, Dressage Competitions, Reining Competitions and Combined Driving Competitions upon payment of a Show Pass fee. Participants in the following classes are exempted from the Requirements of this rule: 1) leadline; 2) exhibitions; 3) games and races; 4) classes for 4-H members; 5) walk trot (exception: Friesian performance FR231) and academy classes (academy classes are classes limited to horses used regularly in a lesson program); 6) USDF introductory level tests, pas de deux and quadrille classes; 7) NRHA Endorsed Reining Competitions. 8) Opportunity classes, 9) citizens of other nations who have proof, in English, of current membership in good standing of their own National Federation, 10) USEA beginner novice division; and 11) assistant handlers in Dressage Sport Horse Breeding classes.

### FEDERATION ENTRY AGREEMENT

By entering a Federation-licensed Competition and signing this entry blank as the Owner, Lessee, Trainer, Manager, Agent, Coach, Driver, Rider, Handler, Vaultor or Longeur and on behalf of myself and my principals, representatives, employees and agents, I agree that I am subject to the Bylaws and Rules of The United States Equestrian Federation, Inc. (the "Federation") and the local rules of competitions listed herein. I agree to be bound by the Bylaws and Rules of the Federation and of the competition. I will accept as final the decision of the Hearing Committee on any question arising under the Rules, and agree to release and hold harmless the competition, the Federation, their officials, directors, and employees for any action taken under the Rules. I represent that I am eligible to enter and/or participate under the Rules, and every horse I am entering is eligible as entered. I also agree that as a condition of and in consideration of acceptance of entry, the Federation and/or the Competition may use or assign photographs, videos, audios, cable - casts, broadcasts, internet, film, new media or other likenesses of me and my horse taken during the course of the competition for the promotion, coverage or benefit of the competition, sport, or the Federation. Those likenesses shall not be used to advertise a product and they may not be used in such a way as to jeopardize amateur status. I hereby expressly and irrevocably waive and release any rights in connection with such use, including any claim to compensation, invasion of privacy, right of publicity, or to misappropriation. The construction and application of Federation rules are governed by the laws of the State of New York, and any action instituted against the Federation must be filed in New York State. See GR908.4.

If not currently a USEF Active Competing member or Subscriber, I acknowledge that I will be enrolled for no cost as a USEF Fan and my USEF Fan Account will continue to annually automatically renew in the USEF's sole discretion. Additionally, I acknowledge that the benefits of a USEF Fan are subject to change without notice. USEF may in its sole discretion, at any time, terminate my USEF Fan status. I acknowledge that I may opt out at any time by going to My USEF Dashboard or calling (859)810-8733.



# 2025 WORLD EQUESTRIAN CENTER SUMMER SERIES

## HORSE SHOW RULES

### STATEMENT AS TO FEDERATION FEE

(GR407.1-3) For every horse participating in any competition licensed by the Federation, a \$23 Federation Fee will be collected (\$15 shall be an Equine Drugs & Medication Fee to provide for research, inspection, and enforcement of rules regarding used of medications and drugs & \$8 USEF Fee). Each horse entered will also be required to pay a \$10 USHJA Fee and a USHJA Showpass \$30 fee will be collected for any person who is not a current USHJA member. USEF Membership is required.

The Horse Show Management reserves the right in itself to interpret all questions and conditions in regard to or arising out of an incident without claims for damages or recourse of any kind. All questions not covered in these Rules and Regulations shall be decided by the Horse Show management, their decision to be final.

The Horse Show Management reserves the right to limit entries, refuse, accept conditionally, or to cancel any entries, disqualify any riders or exhibitors, prohibit exhibition of entries, and cancel award prizes, without claim for damages; to change any course, to add a dotted line, to cancel or combine any classes, or to reschedule classes, after due notice to exhibitors; to change rings, or judges; to change specifications in jumper classes in order to facilitate the time schedule or as competition warrants, or to make any changes management deems is in the best interest of the show and its exhibitors.

Every horse entered for competition will be under the control of the Horse Show Management, but Management will, in no case, be responsible for any loss or damage that may occur, and it shall be a condition of entry that each exhibitor shall hold the Horse Show, its members, directors and employees, contractors, sponsoring entities and facility harmless for any loss or accident to horse, horses or equipment which may occur from sickness, fire or otherwise.

### SAFE SPORT STATEMENT

Reminder: All USEF Life and Senior Active members, as well as participants who have regular contact with minor athletes, are required to comply with the U.S. Center for SafeSport training requirement to be eligible to participate in the competition. All Participants must adhere to the U.S. Center for SafeSport Code, USEF Safe Sport Policy, and the Minor Athlete Abuse Prevention Policies. More information about these can be found at [www.usef.org](http://www.usef.org).

### NECROPSY

I understand that any horse/pony "fatality" defined as a death by any means including euthanasia, at any time from when entries arrive at the Venue until departure from the Venue, or a death by any means including euthanasia at any time occurring as a result of any fatal injury or illness sustained during any WEC Event shall result in a necropsy. For any necropsy the Owner of the horse/pony shall perform a gross mortem examination, and the Owner hereby agrees to share all findings, results and medical reports with WEC. In the event an Owner does not perform a gross post-mortem examination of the horse/pony, the Owner hereby authorized WEC to perform the gross postmortem examination at its sole cost and expense and agrees to share the results with Owner.

In the event an Owner's horse/pony dies from a disease that affects (an) other horse(s)/pony(ies) at the Venue the Owner of the deceased horse/pony agrees to indemnify any other third party Owner of a horse/pony affected and further agrees to indemnify and hold WEC harmless from any claim, demand, or liability arising out of or in any way related to the deceased horse/pony.

## CONDITIONS

**Office Hours:** Office opens Wednesday-Sunday 1 hour before showing. Office closes at 5pm daily or 30 minutes after the last class finishes, whichever comes first. Adds for the next day must be completed by 4pm.

**24 hour Security:** 352.414.7960

**Important USEF rules in effect:** As of January 1, 2019, every USEF adult member (18 years of age or older) with a Competing Membership must complete USEF's Safe Sport Training. You will do this when logged into your USEF account, preferably when you renew your membership. Failure to complete the Safe Sport training will disqualify you from competing in any capacity until it is completed. Junior riders that have reached their 18th birthday must complete Safe Sport training.

**Photography:** Andrew Ryback Photography is the official photographer of the 2025 Summer Series at World Equestrian Center - Ocala. By entering the premises of World Equestrian Center (WEC), you enter an area where photography, audio and video recording may occur. By entering the property, you consent to photography, audio and/or video recording, and the release, publication, exhibition or reproduction to be used for news, web, social media, advertising and other promotional purposes by WEC and its affiliates and representatives. In entering the WEC grounds, you release WEC, its officers and employees, and each and all persons involved from any liability connected with the taking, recording, digitizing, or publication and use of interviews, photographs, images, video and/or audio recordings. All rights to royalties, claims of payment in connection with any use of media materials listed above, are waived, regardless of whether a fee or admission is charged or sponsorship applied. You have been fully informed of your, consent, waiver of liability, and release before entering WEC grounds.

**Mandatory Microchipping went into effect on December 1, 2018.** You will not be allowed to compete with any horse that has not been microchipped. The microchip must be uploaded to your USEF account. All horses that require a USHJA Registration will also require a microchip.

**Stabling:** All stalls (12'x12' and 12'x14') are permanent concrete stalls with doors, stable comfort mattress systems, and fans. Stalls may not be occupied by more than one horse at a time. To sublet stalls, you must notify the Stabling Office beforehand, as a sublet fee will apply. Failure to provide notification will result in being charged a stall fee.

A \$25 manure removal fee will be applied per stall. However, this fee will be waived if you purchase a minimum of three bags of shavings per stall from the WEC Ocala Feed and Bedding Store.

**Circuit Stall/Paddock Reservations:** Stalls are \$2,700. circuit and must be secured with payment in full. Stalls will no be confirmed without payment. Stalls/paddocks can be ordered through [horseshowing.com](https://horseshowing.com) until sold out. Stalls

will be reserved once payment is received.

Same price cash or credit.

Reservations will be accepted starting April 7, 2025 with a 50 percent deposit required or full payment through [horse-showing.com](https://horse-showing.com). Full payments must be paid online by May 19, 2025 or reservations will be canceled.

Circuit items are refundable until May 19th, 2025, less \$90 processing fee.

Stalls/paddocks are property of World Equestrian Center. Circuit rentals may not be transferred to a third party without the express written consent of management. All horses on grounds will be charged for a stall or ship-in fee.

No reservations will be accepted through email. Reservations will be complete upon processing of payment and approval of World Equestrian Center. We are unable to accept location requests. Tack stall and paddock requests will be accommodated based on the ratio of horse stalls ordered.

**Weekly Stall/Paddock Reservations:** Stalls/paddocks are property of World Equestrian Center. Stalls are \$300/week and must be secured with a form of payment (credit card or check) in the Horse Show Office. Locking tack rooms are \$325. Stalls and Paddocks can be reserved at [HorseShowing.com](https://HorseShowing.com). No reservations will be accepted through email. Reservations will be complete upon processing of payment and approval of World Equestrian Center. Paddocks are \$375/week and subject to availability and stall count. No reservations will be accepted through email. Please understand that we are unable to accept location requests at this time. Tack stall and paddock requests will be accommodated based on the ratio of horse stalls ordered. Weekly stalls can be canceled up to 21 days before the start of the horse show. No cancellations will be accepted after unless a veterinary letter is provided.

Horses are not allowed in locking tack rooms. A \$50 cleaning fee per stall and/or tack room will occur for any left behind personal belongings and trash. Shavings are to be purchased on-site. Any off-site shavings will result in an additional \$25 manure disposal fee per stall. A \$100 fee per stall and/or tack room will occur for any nails or screws in stalls/tack rooms. A \$50 charge for cardboard shavings.

**Paddock Restrictions:** Horses may not be turned out in paddocks between dusk and dawn.

**Feed and Bedding:** must be ordered through <https://world-equestriancenter.jotform.com/form/223222771406146> at least 24 hours in advance to guarantee delivery prior to arrival. No outside shavings deliveries permitted.

**Trainer Splits:** Weekly tack stalls/grooming stalls, feed & bedding can now be split in the Horse Show Office. Splits have to be done each week by Friday at 4pm! If not done by Friday, the trainer will be responsible for the entire invoice. Any Feed/Bedding orders made after 4pm Friday will have to be paid for in full at the time of ordering.



## CONDITIONS

**Ship In Fee:** \$150/week. Park in designated area only. All horses must be entered in the show and be issued a WEC back number. Any horse not paying the horse show for a stall will be charged a ship in fee.

**Entry Closing:** Online entries must be submitted two weeks prior to the start of the competition week. Submit online entries through [HorseShowing.com](https://www.horshowing.com). All horses must have a WEC issued back number to be worn at all times that the horse is actively working. Late fee is \$50 after the closing date for online entries. Late fee starting Tuesday of the show week is \$100.

**Checking In and Checking Out:** All horses must leave a check or credit card on file. All accounts must be settled every week, in full, upon the conclusion of the final class on Sunday. Those that do not check out or leave an open check with the office will be charged a \$50 late check out fee for each day past Sunday.

Email [ocalacheckout@wec.net](mailto:ocalacheckout@wec.net) to request a link to pay your bill online. Include horse name/back number in email.

**All Horses on Property:** As of December 1, 2023, all horses must be issued a back number from the Horse Show Office and it must be worn at all times when out of the stall or trailer.

**IMPORTANT INFORMATION CONCERNING SPLITTING/COMBINING \$ ADD/SCRATCH POLICY IN ALL "A" RATED HUNTER SECTIONS:** Should entries warrant, all "A" rated hunter sections will be split or combined following USEF rules and will be done so at the close of the horse show office on the evening preceding the first class in each section, therefore entries MUST be completed for "A" rated hunter divisions accordingly to be considered. Any post-adds received and accepted after this time will not be considered in respect to the splitting/combining numbers. There will be no exceptions to this policy. Same day scratches and/or "no-shows" at the gate in all "a" rated hunter sections will forfeit their entry fee unless a Vet Scratch Certificate from the official horse show veterinarian is received prior to the first class of the section in question. Should same day scratches or no-shows result in insufficient entries to keep sections split, sections will be combined.

**Adding Classes:** Can be done directly through [HorseShowing.com](https://www.horshowing.com) or in Horse Show Office until 4pm the day before the class is scheduled. Please be sure to enter classes in a timely manner. Scheduling cannot accommodate same day adds. In the event an add after 5pm the day prior is approved by management, a \$25 late add fee will incur.

**\*\*\*RDNE (Rode Did Not Enter):** Entries that show in a class that were not properly entered either online, by inclusion on your original entry form, or a properly filled out add slip/online add PRIOR to the class involved will be charged a \$50 RDNE Fee.

**Scratching Classes:** Scratches can be done directly in your [HorseShowing.com](https://www.horshowing.com) account any time until the start of the class except "A" rated hunters cannot scratch same day. Informing the starter that you do not intend to participate WILL NOT scratch the class. A horse on the grounds scratching all classes will become a non-showing horse regardless of the reason and will incur all fees associated with a non-showing horse. After showing in the first class of any "A" rated section requiring a section entry fee, no refunds will be given for scratching any classes within the section for any reason.

**Non-Showing Horses:** All horses on the grounds are required to have a signed entry form in the office, whether they are showing or not. This entry form must include signatures and a complete description of the horse. All horses must present health papers upon arrival to the Show Office.

**Payment Method:** Show Fees may be paid by cash, check drawn on an American bank, or any major credit card (3% fee).

**Returned Checks/Declined Credit Cards/Credit Card Chargebacks:** Checks returned by the bank, declined credit cards or chargebacks on credit card transactions for any reason are regarded as a serious offense and will be handled as follows: A 10% penalty will be assessed for every returned check or credit card chargeback (minimum of \$50). Accounts will be given ten days to be paid in full with cash or cash equivalent or they will be reported to USEF for collection/disciplinary action.

### 2024 SUMMER SERIES CIRCUIT PRIZE MONEY PAID OUT

WK I -	\$76,276
WK II -	\$110,317
WK III -	\$75,059
WK IV -	\$75,184
WK V -	\$91,716
WK VI -	\$86,242
WK VII -	\$75,152
WK VIII -	\$79,725
WK IX -	\$75,123

## CONDITIONS

**Prize Money/Awards:** An IRS W9 needs to be completed showing the proper prize money recipient and their SS or Fed ID #. Care must be taken to be sure the information matches that of the IRS. Prize money will be deducted from your account upon closeout in the office provided you have submitted the required W9 or W8 for Foreign exhibitors. Balances will be paid by check and mailed to the named recipient on the W9 within 30 days after the conclusion of the show. The IRS W9 form is available in the show office/through [HorseShowing.com](http://HorseShowing.com) account. All Hunter purses shall be divided as follows unless otherwise specified: 1st-30%, 2nd-22%, 3rd-15%, 4th-12%, 5th-11%, 6th-10%. All Hunter Classic purses shall be divided as follows unless otherwise specified: 1st-25%, 2nd-19%, 3rd-15%, 4th-10%, 5th-9%, 6th-8%, 7th-7%, 8th-7%. Ribbons will be awarded to eighth place in all hunter classes. \$75,000 in hunter prize money is guaranteed to be paid out each week. Total hunter prize money offered for Premier weeks: \$134,450.

**Awards Ceremonies:** Riders are required to ride for awards in all Classics/Grand Prix, unless notice of ceremony cancellation has been given. Failure of a rider to be present may result in forfeiture of all prizes won in the class. Competition management reserves the right to require participation in any tie-breaking procedure (if required) may include, but is not limited to; forfeiture of prize money and/or elimination from the competition. The decision of management is final.

**Refunds:** Entries canceled prior to the closing date will be refunded in full. Stalls and processing fee are not refundable for any reason after the closing date. All scratches must be submitted in writing to be considered for a refund. All accounts become final after the close of the show, changes will not be considered after this date, no exceptions. Please look over your statement carefully before checking out. If the show must be stopped due to a storm, accident, or other emergency, the show management has the right to deny a refund of any or all fees. Refunds will be issued at the end of the series.

**Processing/EMT/Night Watch:** Each horse will pay a \$130 per show Processing Fee. The Processing Fee is a non-refundable fee which will also entitle each horse to properly add/scratch regular classes at no additional cost.

**Arrival and Departure:** Horses may arrive after 3pm on Monday and depart no later than 7am Monday. Early arrival and late departure must be arranged directly with the stabling manager. Early arrivals and late departures will incur an \$50 per stall/per day fee.

**Health Requirements:** Florida regulations require that all equines be covered by official interstate health certificates, issued by a licensed veterinarian, showing that the animals are free from any symptoms of any infectious or communicable disease. The certificate shall include the name and address of the owner, destination in Florida, number of horses examined, the name, registration number(s), if any, tattoo, in any, sex, age, rectal temperature, color, and makings of each animal listed. Health certificates will become void after 30 days from issue. Health certificates must show animals to be negative to an equine infections anemia test within the past 12 months. Date of the test and approved laboratory must be shown on health certificate. At Federation licensed competitions, horses entering the grounds must be accompanied by documentation of equine Influenza Virus and Equine Herpes Virus (Rhinopneumonitis) vaccinations within six months prior to entering the stables. Horses not in compliance with this rule may be required to leave the competition grounds upon request by Competition Management. Documentation should consist of one of the following methods mentioned below.

1. The frequency of vaccine administration should be per the vaccine manufacturers' or veterinarian's recommendations. It is recommended that vaccines are administered by or under the direction of a veterinarian. 2. In the case of vaccines administered by a veterinarian, the exhibitor, upon request by Competition Management, must provide documentation from the veterinarian on documenting that the horse in question received the vaccinations; name of the vaccines and date of vaccine administration. 3. In the case of vaccines administered by a person other than a veterinarian, the exhibitor, upon request by Competition Management, must provide a receipt of the vaccine purchase which is signed by the owner, or agent with care, custody, and control of the horse; name, serial number and expiration date of the vaccine, and date of vaccine administration. 4. In the case of a horse that is unable to receive either of the vaccinations due to a history of adverse reactions, the exhibitor, upon request by Competition Management, must provide a letter from the veterinarian on official letterhead stating that the horse in question cannot be vaccinated due to medical concerns and a log of temperatures taken twice daily for the seven days prior to entering the competition grounds. These horses must also have their temperature taken and logged twice daily while on the competition grounds. The log of temperatures should be provided to the Competition Management, steward, or technical delegate when requested. 5. Competition Management may not amend or enhance vaccination requirement without prior approval of the Veterinary Committee. To streamline the verification and tracking of horse health records, WEC – Ocala is partnering with Equi-Trace® EventPass, the official verified Horse Health Records provider of US Equestrian (USEF). See page 13 for details.

**Courtesy Circle:** In some instances it may become necessary to restrict the area of the courtesy circle by a mandatory line. If implemented, it will be clearly marked on the course chart and a corresponding barrier will be erected on the course. A public announcement will also be made.



## CONDITIONS

**Dogs - Leash Law:** Dogs and other pets must be on a leash at all times while on the show grounds. Fines for dogs found without a leash will result in a \$100 fine. No dog pens are allowed outside of the barns or in shared aisles. No dogs in stalls overnight.

**Motorized Vehicles:** Minors who do not have a valid driver's license which allows them to operate a motorized vehicle in the state in which they reside will not be permitted to operate a motorized vehicle of any kind, including, but not limited to, golf carts, motorcycles, scooters, or farm utility vehicles, on the competition grounds of licensed competition. Minors who have a valid temporary license may operate the above described motorized vehicles as long as they are accompanied by an adult with a valid driver's license. The parent/legal guardian or individual who signs the entry blank as a parent or guardian of a minor operating a motorized vehicle in violation of this rule are solely responsible for any damages, claims, losses or actions resulting from that operation. Violations of this rule will be cause for penalties against those responsible for the child committing the offense. Wheelchairs and other mobility assistance devices for individuals with disabilities are exempt from this rule. The unsafe use of personal electronic transport devices, as determined by the competition officials and management in their sole discretion, that do not require a driver's license to operate, including but not limited to segways, hoverboards, and single wheeled scooters is prohibited on competition grounds. Operating such devices in areas where people gather may be deemed "unsafe use" if there is a risk of harm to others. If the operator of the device is a minor, the parent/legal guardian or individual who signs the entry blank as a parent or guardian of a minor operating the device in violation of this rule is accountable and may be subject to penalties. Wheelchairs and other mobility assistance devices for individuals with disabilities are exempt from this rule.

**Parking Violations:** Fines of up to \$100 may be assessed, and vehicles may be booted. All fines can be paid at the Horse Show Office.

**Medical Waste:** Sharps must be placed in proper receptacles located in each barn. Failure to do this will result in a \$100 fine or other penalties deemed necessary by the Show Management.

**Protective Headgear:** It is compulsory for all persons at Federation licensed hunter/jumper competitions when mounted anywhere on the competition grounds, to wear properly fastened protective headgear which meets or exceeds ASTM (American Society for Testing and Materials)/SEI (Safety Equipment Institute) standards for equestrian used and carries the SEI tag. It must be properly fitted with harness secured. It is the responsibility of the rider, or the parent, guardian or trainer of the junior exhibitor to see to it that the headgear worn complies with appropriate safety

standards and is properly fitted and in good condition.

**Poling:** Manual poling and the use of bamboo offsets are prohibited at all times on the grounds of the World Equestrian Center. In the event of a violation of this rule, the involved horse and its trainer of record as indicated on the entry form will be suspended from further competition at the show in which the violation occurred. In addition, no refunds will be given for any unused fees.

**Emergency Information:** All Horses must have an emergency information card attached to their stall.

**Horse Show Championships:** In all Hunter Championships, the titles shall be awarded to two of the four horses which have acquired the most points over fences. In addition to these points, only these four horses shall receive full points for ribbons won in the Under Saddle classes and half points for ribbons won in Model. Points awarded for all divisions as follows: 10-6-4-2-1-1/2 except Jumper bonus classes. Ties in USEF Hunter Championships shall be decided as specified in the USEF Rule Book. Others shall remain tied and shall flip/draw for the awards. Ties in Jumper divisions to be decided by the bonus class placing, if still tied they shall remain tied and entries shall flip/draw for the awards.

**Horse/Pony Measurements:** Measurements will take place Wednesday through Saturday at 10am at the Vet station in Barn E. Please make arrangements in the Horse Show Office.

## RINGS:

**WEC Grand Arena:** 320' x 400'

**Stadium:** 390' x 390'

**Jumper 1:** 200' x 300'

**Jumper 2:** 200' x 300'

**Jumper Annex:** 250' x 350'

**North 3:** 180' x 300'

**North 4:** 180' x 300'

**North 5:** 200' x 300'

**North 6:** 200' x 300'

**North 7:** 200' x 300'

**Indoor 1:** 173' x 533'

**Indoor 2:** 175' x 533'

**Indoor 3:** 173' x 533'

**Indoor 4:** 173' x 533'

**Hunter 1:** 175' x 300'

**Hunter 2:** 175' x 300'

**Hunter 3:** 175' x 300'

**Hunter 4:** 175' x 300'

footing is GGT mix

**Indoor 5:** 160' x 473'

**Indoor 6:** 175' x 575'

footing is GGT mix



# EventPass

Powered By EquiTrace®



## Get Ready for Summer Circuit

**World Equestrian Center is now using EventPass for all horse show health documents.**

**1**

### Create a Free Account

Sign Up at [equitrace.app](https://equitrace.app) and choose **EventPass Lite**

**2**

### Add Your Horses

Upload from a USEF account or enter them manually

**3**

### Upload Your Health Documents

EventPass verifies vaccines, Coggins and Health Statements

**4**

### Create Your EventPass

Once documents are approved, select your show week and horses attending. Complete your health declaration online.

**5**

### Scan your pass on arrival

Download the mobile app and scan at the gate or office



Visit [equitrace.app/eventpass-wec](https://equitrace.app/eventpass-wec)  
for more information about EventPass



Scan To Get Started



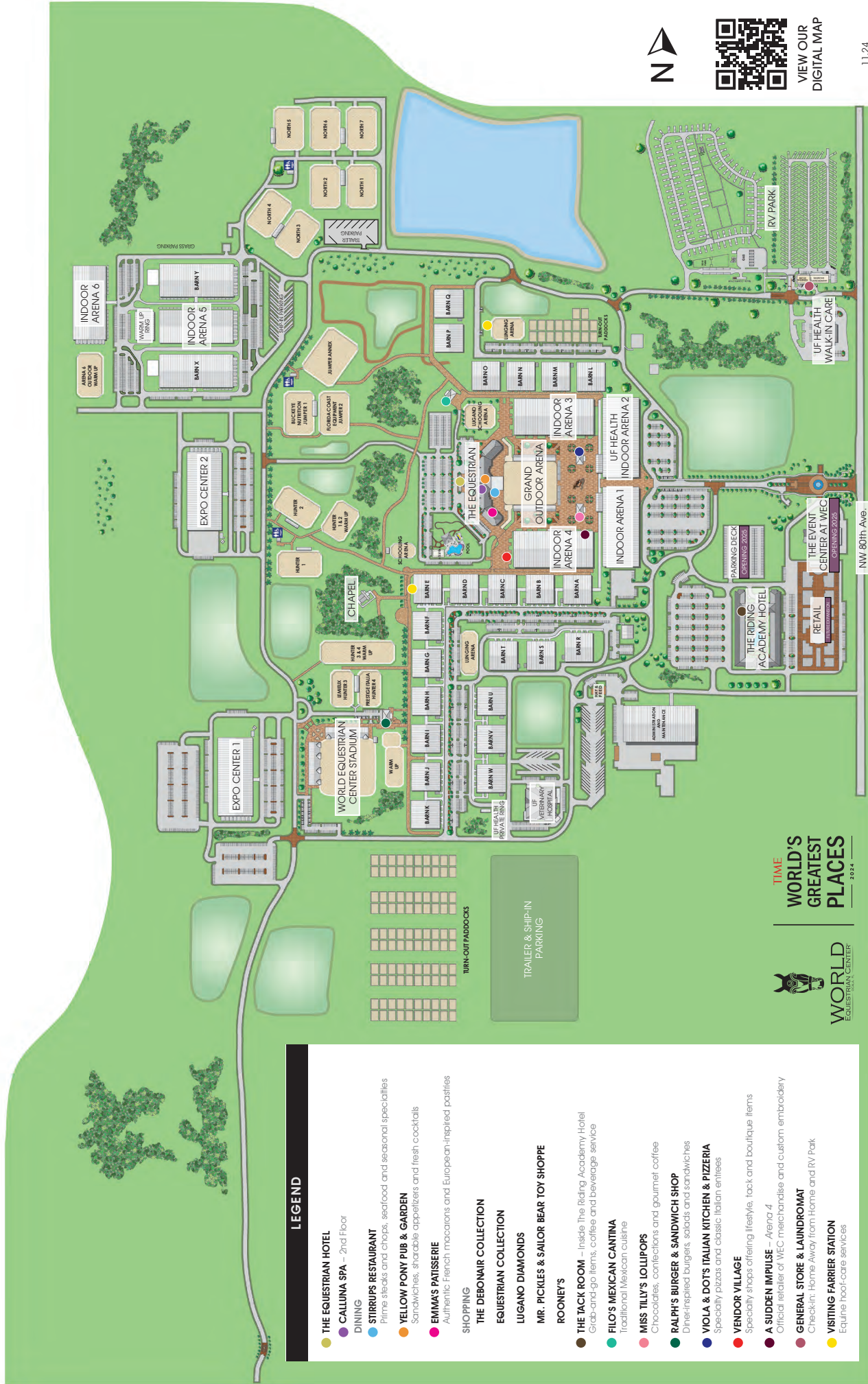

### LEGEND

- THE EQUESTRIAN HOTEL**
- CALLUNA SPA** - 2nd Floor
- DINING**
- STIRRUPS RESTAURANT**
  - Prime steaks and chops, seafood and seasonal specialties
- YELLOW PONY PUB & GARDEN**
  - Sandwiches, shagable appetizers and fresh cocktails
- EMMA'S PATISSERIE**
  - Authentic French macarons and European-inspired pastries
- SHOPPING**
- THE DEBONAIR COLLECTION**
- EQUESTRIAN COLLECTION**
- LUGANO DIAMONDS**
- MR. PICKLES & SAILOR BEAR TOY SHOPPE**
- ROONEY'S**
- THE TACK ROOM** - Inside The Riding Academy Hotel
  - Grab-and-go items, coffee and beverage service
- FILLO'S MEXICAN CANTINA**
  - Traditional Mexican cuisine
- MISS TILLY'S LOLIPOPS**
  - Chocolates, confections and gourmet coffee
- RALPH'S BURGER & SANDWICH SHOP**
  - Diner-inspired burgers, salads and sandwiches
- VIOLA & DOT'S ITALIAN KITCHEN & PIZZERIA**
  - Specialty pizzas and classic Italian entrees
- VENDOR VILLAGE**
  - Specialty shops offering lifestyle, tack and boutique items
- A SUDDEN IMPULSE** - Arena 4
  - Official retailer of WEC merchandise and custom embroidery
- GENERAL STORE & LAUNDROMAT**
  - Checkin: Home Away from Home and RV Park
- VISITING FARRIER STATION**
  - Equine hoof-care services



VIEW OUR  
DIGITAL MAP

## PREMIER RATED HUNTER DIVISIONS, WEEKS I-III, V-VIII

All hunter classes that require a jog will be run with an open numerical score announced at the end of each round.

**Hunter Courses:** Courses will consist of at least eight fences with changes of direction. Fences will simulate obstacles found in the hunt field, such as brush, post and rails, walls, in and outs, gates, etc.. No bank or water jumps. Course diagrams will be posted no later than 30 minutes before the class. In some cases, the area of the courtesy circle may be restricted by a dotted line. Under Saddle classes to be shown at a walk, trot and canter both ways of the ring. No martingales permitted. In High Performance, A/O and Junior classes, entries may be asked to hand gallop collectively one way of the ring, at the Judge's discretion. No more than eight shall be asked to hand gallop at one time. Minimum entry requirements: Management reserves the right to combine Sections with less than six entries. No split Section will be held with less than four entries. Handy Hunter Courses and jumps to simulate those found in trappy hunt country, and may include natural obstacles, a trot fence and a fence to lead over. Jogging - The traditional manner of jogging for soundness in hunter classes is waived, and horses and ponies will job for soundness under saddle by trotting a circle on a loose rein at the end of each over-fences performance.

H - Indicates Handy Hunter Class

CL - Denotes first round score for Classic. Be sure you are entered in the Classic the night before denoted class for first round score

\* Indicated Conformation Class

### GREEN CONFORMATION HUNTER

Individual classes may not be entered except for Model. To be judged 70% on performance and 30% on conformation.

Fences 3'6"		Section Fee: \$325 (Model an additional \$30)
7	Model	
8, 9, 10, 11H	\$400 Green Conformation Hunter O/F	12 - \$150 U/S

### HIGH PERFORMANCE CONFORMATION HUNTER

Individual classes may not be entered except for Model. To be judged 70% on performance and 30% on conformation.

Fences 3'9"	Open to any horse. No Cross entry restrictions.	Section Fee: \$350 (Model an additional \$30)
1	Model	
2, 3, 4, 5H	\$500 High Performance Conformation Hunter O/F	6 - \$150 U/S

### GREEN HUNTER

Fences 3' and 3'3"	Individual classes may not be entered.	Section Fee: \$275
33, 34, 35, 36	\$350 Green Hunter 3' O/F	37 - \$150 U/S
28, 29, 30, 31	\$350 Green Hunter 3'3" O/F	32 - \$150 U/S
Fences 3'6" and 3'9"	Individual classes may not be entered.	Section Fee: \$325
23, 24, 25, 26H	\$600 Green Hunter 3'6" O/F	27 - \$200 U/S
18, 19, 20, 21H	\$600 Green Hunter 3'9" O/F	22 - \$200 U/S



## USHJA GREEN HUNTER INCENTIVE STAKE

Horses must be enrolled in the USHJA Green Incentive Program and pay the annual enrollment fee to participate in the Green Stake classes. Additionally, horses must be registered with USHJA and recorded with USEF to participate. Horses must be enrolled in the Green Incentive Program prior to competing in a Green Stake class.

\$50 will be added to the prize money awarded per entrant.

430, 431	\$1,000 USHJA Green Hunter Incentive Stake 3'-3'3"	Entry Fee: \$100 + \$20 USHJA fee
	Classes 30 & 35 will be used for results and placings.	(Total \$120)
432	\$1,000 USHJA Green Hunter Incentive Stake 3'6"-3'9"	Entry Fee: \$100 + \$20 USHJA fee
	Classes 20 & 55 will be used for results and placings.	(Total \$120)

## HIGH PERFORMANCE HUNTER

Fences 4'	Open to any horse. No cross entry restrictions.	Section Fee: \$375/Entry Fee: \$85/class
13, 14, 15, 16H	\$700 High Performance Hunter O/F	17 - \$300 U/S

## YOUNG HUNTER

Young Hunters must be age verified with USEF. Individual classes may not be entered.		Section Fee: \$275
48, 49, 50, 51	\$350 Young Hunter 2'9" - 5 Years and Under	52 - \$150 U/S
53, 54, 55, 56	\$350 Young Hunter 3'0" - 6 Years and Under	57 - \$150 U/S
58, 59, 60, 61	\$350 Young Hunter 3'3" - 5 Years and Under	62 - \$150 U/S

## PERFORMANCE HUNTER 3'3"

Fences 3'3"	Open to any horse. No cross entry restrictions.	Entry Fee: \$60/Class
43, 44, 45, 46H	\$350 Performance Hunter 3'3" O/F	47 - \$150 U/S

## PERFORMANCE HUNTER 3'6"

Fences 3'6"	Open to any horse. No cross entry restrictions.	Entry Fee: \$65/Class
38, 39, 40, 41H	\$400 Performance Hunter 3'6" O/F	472- \$150 U/S

## AMATEUR OWNER HUNTER

Horses to be ridden by an Amateur Owner or an Amateur member of the owner's family. Horse/Rider combination cannot show in both Adult Amateur and Amateur Owner Hunter divisions at the same show.

Fences 3'6"	Individual classes may not be entered.	Section Fee: \$350
80, 81CL, 82, 83H	\$600 A/O Hunter 3'6" 18-35 O/F	84 - \$350 U/S
85, 86CL, 87, 88H	\$600 A/O Hunter 3'6" 36/O O/F	89 - \$350 U/S
416	\$3,500 Amateur Owner Hunter Classic 3'6"	Entry Fee: \$350
Fences 3'3"	Individual classes may not be entered.	Section Fee: \$325
90, 91CL, 92, 93H	\$400 A/O Hunter 3'3" 18-35 O/F	94 - \$200 U/S
95, 96CL, 97, 98H	\$400 A/O Hunter 3'3" 36/O O/F	99 - \$200 U/S
415	\$2,500 Amateur Owner Hunter Classic 3'3"	Entry Fee: \$250

## JUNIOR WORKING HUNTER

Open to horses of any age and ridden by a junior exhibitor. Horse/Rider combination cannot show in both Children's and Junior Hunter divisions at the same show.

Fences 3'6"	Individual classes may not be entered.	Section Fee: \$350
100, 101CL, 102, 103H	\$600 Small Junior Hunter 3'6" 15 & under O/F	104 - \$350 U/S
105, 106CL, 107, 108H	\$600 Small Junior Hunter 3'6" 16-17 O/F	109 - \$350 U/S
110, 111CL, 112, 113H	\$600 Large Junior Hunter 3'6" 15 & under O/F	114 - \$350 U/S
115, 116CL, 117, 118H	\$600 Large Junior Hunter 3'6" 16-17 O/F	119 - \$350 U/S
412	\$3,500 Small Junior Hunter Classic 3'6"	Entry Fee: \$350
413	\$3,500 Large Junior Hunter Classic 3'6"	Entry Fee: \$350
Fences 3'3"	Individual classes may not be entered.	Section Fee: \$325
120, 121CL, 122, 123H	\$400 Junior Hunter 3'3" 15 & under O/F	124 - \$200 U/S
125, 126CL, 127, 128H	\$400 Junior Hunter 3'3" 16-17 O/F	129 - \$200 U/S
414	\$2,500 Junior Hunter Classic 3'3"	Entry Fee: \$250

## GREEN PONY HUNTER

Fences 2'3"(Small)/2'6"(Medium)/2'9"(Large)	Individual classes may not be entered.	Section Fee: \$250
The first class over fences shall count 75% performance and 25% conformation.		
*150, 151CL, 152, 153	\$250 Small Green Pony Hunter O/F	154 - \$100 U/S
*156, 157CL, 158, 159	\$250 Medium Green Pony Hunter O/F	160 - \$100 U/S
*162, 163CL, 164, 165	\$250 Large Green Pony Hunter O/F	156 - \$100 U/S
421	\$1,500 Green Pony Hunter Classic	Entry Fee: \$150

## PONY HUNTER

Open to ponies not exceeding 14.2. All ponies must have a current measurement card. To be ridden by a junior exhibitor. Manners and suitability of a pony for the rider shall be emphasized in all classes. Extreme speed shall be penalized.

Fences 2'3"(Small)/2'6"(Medium)/2'9"(Large)	Individual classes may not be entered.	Section Fee: \$300
The first class over fences shall count 75% performance and 25% conformation.		
*170, 171CL, 172, 173H	\$375 Small Pony Hunter O/F	174 - \$150 U/S
*176, 177CL, 178, 179H	\$375 Medium Pony Hunter O/F	180 - \$150 U/S
*182, 183CL, 184, 185H	\$375 Small Pony Hunter O/F	186 - \$150 U/S
418	\$2,500 Pony Hunter Classic	Entry Fee: \$250

## CHILDREN'S HUNTER PONY

Open to ponies ridden by a junior exhibitor. All ponies must have a current measurement. No jog.

Fences 2'(Sm/Med)/2'6"(Large)		Entry Fee: \$60/class
210, 211CL, 212, 213	\$100 Children's Hunter Pony Small/Medium	214 - \$50 U/S
215, 216CL, 217, 218	\$100 Children's Hunter Pony Large	219 - \$50 U/S
424	\$1,000 Children's Hunter Pony Classic	Entry Fee: \$100

## USHJA LOW CHILDREN'S HUNTER PONY

Open to ponies ridden by a junior exhibitor. Stallions prohibited. Riders may not cross enter into any class at the same competition where fences exceed 3'3"(exception: all equitation classes). Low Children's Hunter pony/rider combinations may not cross enter into any classes or section where fences exceed 2'9".

Fences 2'		Entry Fee: \$60/class
315, 316, 317, 318	\$100 Low Children's Hunter Horse O/F	319 - \$50 U/S



## CHILDREN'S HUNTER

Fences 3', spreads not to exceed fence height. No jog.			Entry Fee: \$65/class
200, 201CL, 202, 203	\$300 Children's Hunter 14 & under	204 - \$200 U/S	
205, 206CL, 207, 208	\$300 Children's Hunter 15-17	209 - \$200 U/S	
422	\$1,500 NAL/WIHS Children's Hunter Classic 14 & u	Entry Fee: \$150	
423	\$1,500 NAL/WIHS Children's Hunter Classic 15-17	Entry Fee: \$150	

## ADULT AMATEUR HUNTER

Fences 3', spreads not to exceed fence height. No jog.			Entry Fee: \$65/class
220, 221CL, 222, 223	\$300 Adult Hunter 18-35	224 - \$200 U/S	
225, 226CL, 227, 228	\$300 Adult Hunter 36-54	229 - \$200 U/S	
230, 231CL, 232, 233	\$300 Adult Hunter 55+	234 - \$200 U/S	
425	\$1,500 NAL/WIHS Adult Hunter 18-35	Entry Fee: \$150	
426	\$1,500 NAL/WIHS Adult Hunter Classic 36 & over	Entry Fee: \$150	

## USHJA LOW CHILDREN'S HUNTER HORSE

Open to horses ridden by a junior exhibitor. Riders may not cross enter into any class at the same competition where fences exceed 3'3" (exception: all equitation classes). Riders who compete in the 3' Children's Hunter Horse, regular Pony Sections and/or Junior Hunters 3'3" may show one horse in the Low Children's Hunter. Low Children's Hunter horse/rider combinations may not cross enter into any classes or section where fences exceed 2'9".

Fences 2'6"			Entry Fee: \$60/class
310, 311CL, 312, 313	\$100 Low Children's Hunter Horse O/F	314 - \$50 U/S	
427	\$1,500 Low Children's Hunter Horse Classic	Entry Fee: \$150	

## USHJA LOW ADULT AMATEUR HORSE

Open to horses ridden by an amateur exhibitor. Riders may not cross enter into any class at the same competition where fences exceed 3'3" (exception: all equitation classes). Riders who compete in the 3' Adult Hunter and/or 3'3" Amateur Owner Hunters may show horses they own and one that they do not own in the Low Adult Hunters. Low Adult Hunter horse/rider combinations may not cross enter into any classes or section where fences exceed 2'9".

Fences 2'6"			Entry Fee: \$60/class
315, 316CL, 317, 318	\$100 Low Adult Hunter 18-49 O/F	319 - \$50 U/S	
330, 331CL, 332, 334	\$100 Low Adult Hunter 50+ O/F	334 - \$50 U/S	
428	\$1,500 Low Adult Amateur Hunter Classic 18-35	Entry Fee: \$150	
429	\$1,500 Low Adult Amateur Hunter Classic 36+	Entry Fee: \$150	

## THOROUGHBRED HUNTER

Open to all Thoroughbred (Jockey Club Registered or equivalent) horses, proof must be provided.

Fences 3'			Entry Fee: \$55/class
235, 236, 237, 238	Thoroughbred Hunter O/F	239 - U/S	

# NATIONAL RATED HUNTER DIVISIONS, WEEKS IV & IX

All hunter classes that require a jog will be run with an open numerical score announced at the end of each round.

**Hunter Courses:** Courses will consist of at least eight fences with changes of direction. Fences will simulate obstacles found in the hunt field, such as brush, post and rails, walls, in and outs, gates, etc.. No bank or water jumps. Course diagrams will be posted no later than 30 minutes before the class. In some cases, the area of the courtesy circle may be restricted by a dotted line. Under Saddle classes to be shown at a walk, trot and canter both ways of the ring. No martingales permitted. In High Performance, A/O and Junior classes, entries may be asked to hand gallop collectively one way of the ring, at the Judge's discretion. No more than eight shall be asked to hand gallop at one time. Minimum entry requirements: Management reserves the right to combine Sections with less than six entries. No split Section will be held with less than four entries. Handy Hunter Courses and jumps to simulate those found in trappy hunt country, and may include natural obstacles, a trot fence and a fence to lead over. Jogging - The traditional manner of jogging for soundness in hunter classes is waived, and horses and ponies will job for soundness under saddle by trotting a circle on a loose rein at the end of each over-fences performance.

H - Indicates Handy Hunter Class

CL - Denotes first round score for Classic. Be sure you are entered in the Classic the night before denoted class for first round score

\* Indicated Conformation Class

## GREEN CONFORMATION HUNTER

Individual classes may not be entered except for Model. To be judged 70% on performance and 30% on conformation.

Fences 3'6"	Model	Section Fee: \$325 (Model an additional \$30)
7		
8, 9, 10, 11H	\$400 Green Conformation Hunter O/F	12 - \$150 U/S

## HIGH PERFORMANCE CONFORMATION HUNTER

Individual classes may not be entered except for Model. To be judged 70% on performance and 30% on conformation.

Fences 3'9"	Open to any horse. No Cross entry restrictions.	Section Fee: \$325 (Model an additional \$30)
1	Model	
2, 3, 4, 5H	\$400 High Performance Conformation Hunter O/F	6 - \$150 U/S

## GREEN HUNTER

Fences 3' and 3'3"	Individual classes may not be entered.	Section Fee: \$250
33, 34, 35, 36	\$300 Green Hunter 3' O/F	37 - \$75 U/S
28, 29, 30, 31	\$300 Green Hunter 3'3" O/F	32 - \$75 U/S
Fences 3'6" and 3'9"	Individual classes may not be entered.	Section Fee: \$300
23, 24, 25, 26H	\$400 Green Hunter 3'6" O/F	27 - \$100 U/S
18, 19, 20, 21H	\$400 Green Hunter 3'9" O/F	22 - \$100 U/S



## USHJA GREEN HUNTER INCENTIVE STAKE

Horses must be enrolled in the USHJA Green Incentive Program and pay the annual enrollment fee to participate in the Green Stake classes. Additionally, horses must be registered with USHJA and recorded with USEF to participate. Horses must be enrolled in the Green Incentive Program prior to competing in a Green Stake class.

\$50 will be added to the prize money awarded per entrant.

430, 431	\$1,000 USHJA Green Hunter Incentive Stake 3'-3'3" Entry Fee: \$100 + \$20 USHJA fee Classes 30 & 35 will be used for results and placings.	(Total \$120)
432	\$1,000 USHJA Green Hunter Incentive Stake 3'6"-3'9" Entry Fee: \$100 + \$20 USHJA fee Classes 20 & 55 will be used for results and placings.	(Total \$120)

## HIGH PERFORMANCE HUNTER

Fences 4'	Open to any horse. No cross entry restrictions.	Section Fee: \$330/Entry Fee: \$75/class
13, 14, 15, 16H	\$410 High Performance Hunter O/F	17 - \$100 U/S

## YOUNG HUNTER

Young Hunters must be age verified with USEF. Individual classes may not be entered.		Section Fee: \$225
48, 49, 50, 51	\$175 Young Hunter 2'9" - 5 Years and Under	52 - \$50 U/S
53, 54, 55, 56	\$175 Young Hunter 3'0" - 6 Years and Under	57 - \$50 U/S
58, 59, 60, 61	\$175 Young Hunter 3'3" - 5 Years and Under	62 - \$50 U/S

## PERFORMANCE HUNTER 3'3"

Fences 3'3"	Open to any horse. No cross entry restrictions.	Entry Fee: \$55/Class
43, 44, 45, 46H	\$250 Performance Hunter 3'3" O/F	47 - \$75 U/S

## PERFORMANCE HUNTER 3'6"

Fences 3'6"	Open to any horse. No cross entry restrictions.	Entry Fee: \$60/Class
38, 39, 40, 41H	\$300 Performance Hunter 3'6" O/F	47- \$75 U/S

## AMATEUR OWNER HUNTER

Horses to be ridden by an Amateur Owner or an Amateur member of the owner's family. Horse/Rider combination cannot show in both Adult Amateur and Amateur Owner Hunter divisions at the same show.

Fences 3'6"	Individual classes may not be entered.	Section Fee: \$350
80, 81CL, 82, 83H	\$400 A/O Hunter 3'6" 18-35 O/F	84 - \$175 U/S
85, 86CL, 87, 88H	\$400 A/O Hunter 3'6" 36/O O/F	89 - \$175 U/S
416	\$1,750 Amateur Owner Hunter Classic 3'6"	Entry Fee: \$175
Fences 3'3"	Individual classes may not be entered.	Section Fee: \$300
90, 91CL, 92, 93H	\$300 A/O Hunter 3'3" 18-35 O/F	94 - \$100 U/S
95, 96CL, 97, 98H	\$300 A/O Hunter 3'3" 36/O O/F	99 - \$100 U/S
415	\$1,500 Amateur Owner Hunter Classic 3'3"	Entry Fee: \$150

## JUNIOR WORKING HUNTER

Open to horses of any age and ridden by a junior exhibitor. Horse/Rider combination cannot show in both Children's and Junior Hunter divisions at the same show.

Fences 3'6"	Individual classes may not be entered.	Section Fee: \$350
100, 101CL, 102, 103H	\$400 Small Junior Hunter 3'6" 15 & under O/F	104 - \$175 U/S
105, 106CL, 107, 108H	\$400 Small Junior Hunter 3'6" 16-17 O/F	109 - \$175 U/S
110, 111CL, 112, 113H	\$400 Large Junior Hunter 3'6" 15 & under O/F	114 - \$175 U/S
115, 116CL, 117, 118H	\$400 Large Junior Hunter 3'6" 16-17 O/F	119 - \$175 U/S
413	\$1,750 Junior Hunter Classic 3'6"	Entry Fee: \$175
Fences 3'3"	Individual classes may not be entered.	Section Fee: \$300
120, 121CL, 122, 123H	\$300 Junior Hunter 3'3" 15 & under O/F	124 - 1200 U/S
125, 126CL, 127, 128H	\$300 Junior Hunter 3'3" 16-17 O/F	129 - 1200 U/S
414	\$1,500 Junior Hunter Classic 3'3"	Entry Fee: \$150

## GREEN PONY HUNTER

Fences 2'3"(Small)/2'6"(Medium)/2'9"(Large)	Individual classes may not be entered.	Section Fee: \$275
The first class over fences shall count 75% performance and 25% conformation.		
*156, 157CL, 158, 159	\$250 Green Pony Hunter O/F	160 - \$100 U/S
421	\$1,000 Green Pony Hunter Classic	Entry Fee: \$100

## PONY HUNTER

Open to ponies not exceeding 14.2. All ponies must have a current measurement card. To be ridden by a junior exhibitor.

Manners and suitability of a pony for the rider shall be emphasized in all classes. Extreme speed shall be penalized.

Fences 2'3"(Small)/2'6"(Medium)/2'9"(Large)	Individual classes may not be entered.	Section Fee: \$275
The first class over fences shall count 75% performance and 25% conformation.		
*170, 171CL, 172, 173H	\$300 Small Pony Hunter O/F	174 - \$100 U/S
*176, 177CL, 178, 179H	\$300 Medium Pony Hunter O/F	180 - \$100 U/S
*182, 183CL, 184, 185H	\$300 Small Pony Hunter O/F	186 - \$100 U/S
418	\$1,500 Pony Hunter Classic	Entry Fee: \$150

## CHILDREN'S HUNTER PONY

Open to ponies ridden by a junior exhibitor. All ponies must have a current measurement. No jog.

Fences 2'(Sm/Med)/2'6"(Large)		Entry Fee: \$60/class
210, 211CL, 212, 213	\$100 Children's Hunter Pony	214 - \$50 U/S
424	\$500 Children's Hunter Pony Classic	Entry Fee: \$50

## USHJA LOW CHILDREN'S HUNTER PONY

Open to ponies ridden by a junior exhibitor. Stallions prohibited. Riders may not cross enter into any class at the same competition where fences exceed 3'3"(exception: all equitation classes). Low Children's Hunter pony/rider combinations may not cross enter into any classes or section where fences exceed 2'9".

Fences 2'		Entry Fee: \$50/class
315, 316, 317, 318	Low Children's Hunter Pony O/F	319 - U/S



## CHILDREN'S HUNTER

Fences 3', spreads not to exceed fence height. No jog.

Entry Fee: \$55/class

200, 201CL, 202, 203

\$200 Children's Hunter 14 & under

204 - \$100 U/S

205, 206CL, 207, 208

\$200 Children's Hunter 15-17

209 - \$100 U/S

423

\$1,500 NAL/WIHS Children's Hunter Classic

Entry Fee: \$150

## ADULT AMATEUR HUNTER

Fences 3', spreads not to exceed fence height. No jog.

Entry Fee: \$55/class

220, 221CL, 222, 223

\$200 Adult Hunter 18-54

224 - \$100 U/S

230, 231CL, 232, 233

\$200 Adult Hunter 55+

234 - \$100 U/S

426

\$1,500 NAL/WIHS Adult Hunter Classic 36 & over

Entry Fee: \$150

## USHJA LOW CHILDREN'S HUNTER HORSE

Open to horses ridden by a junior exhibitor. Riders may not cross enter into any class at the same competition where fences exceed 3'3" (exception: all equitation classes). Riders who compete in the 3' Children's Hunter Horse, regular Pony Sections and/or Junior Hunters 3'3" may show one horse in the Low Children's Hunter. Low Children's Hunter horse/rider combinations may not cross enter into any classes or section where fences exceed 2'9".

Fences 2'6"

Entry Fee: \$50/class

310, 311CL, 312, 313

Low Children's Hunter Horse O/F

314 - U/S

427

\$750 Low Children's Hunter Horse Classic

Entry Fee: \$75

## USHJA LOW ADULT AMATEUR HORSE

Open to horses ridden by an amateur exhibitor. Riders may not cross enter into any class at the same competition where fences exceed 3'3" (exception: all equitation classes). Riders who compete in the 3' Adult Hunter and/or 3'3" Amateur Owner Hunters may show horses they own and one that they do not own in the Low Adult Hunters. Low Adult Hunter horse/rider combinations may not cross enter into any classes or section where fences exceed 2'9".

Fences 2'6"

Entry Fee: \$50/class

315, 316CL, 317, 318

Low Adult Hunter 18-49 O/F

319 - U/S

330, 331CL, 332, 334

Low Adult Hunter 50+ O/F

334 - U/S

428

\$750 Low Adult Amateur Hunter Classic 18-35

Entry Fee: \$75

## THOROUGHBRED HUNTER

Open to all Thoroughbred (Jockey Club Registered or equivalent) horses, proof must be provided.

Fences 3'

Entry Fee: \$55/class

235, 236, 237, 238

Thoroughbred Hunter O/F

239 - U/S

## RATED HUNTER DIVISIONS, SEASON OPENER

All hunter classes that require a jog will be run with an open numerical score announced at the end of each round.

**Hunter Courses:** Courses will consist of at least eight fences with changes of direction. Fences will simulate obstacles found in the hunt field, such as brush, post and rails, walls, in and outs, gates, etc.. No bank or water jumps. Course diagrams will be posted no later than 30 minutes before the class. In some cases, the area of the courtesy circle may be restricted by a dotted line. Under Saddle classes to be shown at a walk, trot and canter both ways of the ring. No martingales permitted. In High Performance, A/O and Junior classes, entries may be asked to hand gallop collectively one way of the ring, at the Judge's discretion. No more than eight shall be asked to hand gallop at one time. Minimum entry require-

ments: Management reserves the right to combine Sections with less than six entries. No split Section will be held with less than four entries. Handy Hunter Courses and jumps to simulate those found in trappy hunt country, and may include natural obstacles, a trot fence and a fence to lead over. Jogging - The traditional manner of jogging for soundness in hunter classes is waived, and horses and ponies will job for soundness under saddle by trotting a circle on a loose rein at the end of each over-fences performance.

H - Indicates Handy Hunter Class

CL - Denotes first round score for Classic. Be sure you are entered in the Classic the night before denoted class for first round score

\* Indicated Conformation Class

### GREEN HUNTER

	Individual classes may be entered.	Entry Fee: \$60/class
23, 24, 25, 26	\$300 Green 3'6" & 3'9" O/F	27- U/S
28, 29, 30, 31	\$250 Green 3' O/F	32- U/S
33, 34, 35, 36	\$250 Green 3'3" O/F	37- U/S

### YOUNG HUNTER

Young Hunters must be age verified with USEF.	Individual classes may be entered.	Entry Fee: \$50/class
48, 49, 50, 51	Young Hunter 2'9" - 5 Years and Under	52- U/S
53, 54, 55, 56	Young Hunter 3'0" - 6 Years and Under	57 - U/S
58, 59, 60, 61	Young Hunter 3'3" - 7 Years and Under	62 - U/S

### PERFORMANCE HUNTER 3'3"

Fences 3'3"	Open to any horse. No cross entry restrictions.	Entry Fee: \$55/class
43, 44, 45, 46H	\$250 Performance Hunter 3'3" O/F	47- U/S

### PERFORMANCE HUNTER 3'6"

Fences 3'6"	Open to any horse. No cross entry restrictions.	Entry Fee: \$55/class
38, 39, 40, 41H	\$250 Performance Hunter 3'6 O/F	42- U/S



## AMATEUR OWNER HUNTER

Horses to be ridden by an Amateur Owner or an Amateur member of the owner's family. Horse/Rider combination cannot show in both Adult Amateur and Amateur Owner Hunter divisions at the same show. Entry Fee: \$60/class

80, 81CL, 82, 83H	\$275 A/O Hunter 3'6" O/F	84-U/S
90, 91CL, 92, 93H	\$275 A/O Hunter 3'3" O/F	94- U/S
415	\$1,500 A/O Hunter Classic 3'3"/3'6"	Entry Fee: \$150

## JUNIOR HUNTER

Open to horses of any age and ridden by a junior exhibitor. Horse/Rider combination cannot show in both Children's and Junior Hunter Sections at the same show. Entry Fee: \$60/class

100, 101CL, 102, 103H	\$275 Junior Hunter 3'6" O/F	104- U/S
120, 121CL, 122, 123H	\$275 Junior Hunter 3'3" O/F	124- U/S
414	\$1,500 Junior Hunter Classic 3'3"/3'6"	Entry Fee: \$150

## GREEN PONY HUNTER

**All Ponies must have a current measurement card issued by the USEF.**

Fences 2'3"(Small)/2'6"(Medium)/2'9"(Large) Individual classes may not be entered. Entry Fee: \$50/class  
The first class over fences shall count 75% performance and 25% conformation.

*150, 151CL, 152, 153	Green Pony Hunter O/F	154 - U/S
421	\$750 Green Pony Hunter Classic	Entry Fee: \$75

## PONY HUNTER

Open to ponies not exceeding 14.2. All ponies must have a current measurement card. To be ridden by a junior exhibitor. Manners and suitability of a pony for the rider shall be emphasized in all classes. Extreme speed shall be penalized.

Fences 2'3"(Small)/2'6"(Medium)/2'9"(Large) Individual classes may not be entered. Entry Fee: \$55/class  
The first class over fences shall count 75% performance and 25% conformation.

*170, 171CL, 172, 173H		\$200 Small/Medium
Pony Hunter O/F		174- U/S
*182, 183CL, 184, 185H	\$200 Large Pony Hunter O/F	186- U/S
418	\$1,000 Pony Hunter Classic	Entry Fee: \$100

## CHILDREN'S HUNTER PONY

Open to ponies ridden by a junior exhibitor. All ponies must have a current measurement. No jog.

Fences 2'(Sm/Med)/2'6"(Large)		Entry Fee: \$50/class
210, 211CL, 212, 213	Children's Pony	214 - U/S
424	\$500 Children's Pony Hunter Classic	Entry Fee: \$50

## CHILD/ADULT HUNTER

Fences 3'	Spreads not to exceed fence height. No jog.	Entry Fee: \$50/class
200, 201CL, 202, 203	\$175 Children's Hunter	204 - U/S
220, 221CL, 222, 223	\$175 Adult Hunter	224- U/S
422	\$1,000 NAL/WIHS Children's Hunter Classic	Entry Fee: \$100
425	\$1,000 NAL/WIHS Adult Hunter Classic	Entry Fee: \$100

## THOROUGHBRED HUNTER

Open to all Thoroughbred (Jockey Club Registered or equivalent) horses, proof must be provided.

Fences 3'		Entry Fee: \$50/class
235, 236, 237, 238	Thoroughbred Hunter O/F	239-U/S

## USHJA LOW CHILDREN'S HUNTER HORSE

Open to horses ridden by a junior exhibitor. Riders may not cross enter into any class at the same competition where fences exceed 3'3" (exception: all equitation classes). Riders who compete in the 3' Children's Hunter Horse, regular Pony Sections and/or Junior Hunters 3'3" may show one horse in the Low Children's Hunter. Low Children's Hunter horse/rider combinations may not cross enter into any classes or section where fences exceed 2'9".

Fences 2'6".		Entry Fee: \$50/class
310, 311CL, 312, 313	Low Children's Hunter Horse O/F	314 - U/S
426	\$750 Low Children's Hunter Horse Classic	Entry Fee: \$75

## USHJA LOW CHILDREN'S HUNTER PONY

Open to ponies ridden by a junior exhibitor. Stallions prohibited. Riders may not cross enter into any class at the same competition where fences exceed 3'3" (exception: all equitation classes). Low Children's Hunter pony/rider combinations may not cross enter into any classes or section where fences exceed 2'9".

Fences 2'.		Entry Fee: \$50/class
3101, 3111, 3121, 313	Low Children's Hunter Pony O/F	3141 - U/S

## USHJA LOW ADULT AMATEUR HUNTER

Open to horses ridden by an amateur exhibitor. Riders may not cross enter into any class at the same competition where fences exceed 3'3" (exception: all equitation classes). Riders who compete in the 3' Adult Hunters and/or the 3'3" Amateur Owner Hunter classes may show horses that they own in the Low Adult Hunters and one that they do not own in the Low Adult Hunters.

Fences 2'6".		Entry Fee: \$50/class
315, 316CL, 317, 318	Low Adult Hunter O/F	319 - U/S
429	\$750 Low Adult Amateur Hunter Classic	Entry Fee: \$75



## RATED HUNTER DIVISIONS ALL WEEKS

### 2'0" USHJA HUNTER

Fences 2'	Open to all horses, ponies, and riders.	Entry Fee: \$55/class
255, 256, 257, 258	2' 0" USHJA Hunter	259 - U/S

### 2'3" USHJA HUNTER

Fences 2'3"	Open to all horses, ponies, and riders.	Entry Fee: \$55/class
260, 261, 262, 263	2'3" USHJA Hunter	264 - U/S

### 2'6" USHJA HUNTER

Fences 2'6"	Open to all horses, ponies, and riders.	Entry Fee: \$55/class
265, 266, 267, 268	2' USHJA Hunter	269 - U/S

### 2'9" USHJA HUNTER

Fences 2'9"	Open to all horses, ponies, and riders.	Entry Fee: \$55/class
270, 271, 272, 273	2'9" USHJA Hunter	274 - U/S

### 3' USHJA HUNTER

Fences 3'	Open to all horses, ponies, and riders.	Entry Fee: \$55/class
275, 276, 277, 278	3' USHJA Hunter	279 - U/S

### 3'3" USHJA HUNTER

Fences 3'3"	Open to all horses, ponies, and riders.	Entry Fee: \$55/class
245, 246, 247, 248	3'3" USHJA Hunter	249 - U/S

## NON RATED HUNTER DIVISIONS ALL WEEKS

### FUTURE HUNTER

Open to all horses and ponies that have never competed above 2' and all riders. Horse/pony may not compete in any other class higher than 2' at this show.

Fences 2'		Entry Fee: \$50/class
250, 251, 252, 253	Future Hunter O/F	245 - U/S

### BABY GREEN HUNTER

This division is designed for the horse or pony in their first year of showing. Horses and ponies may not show in any classes in which fences exceed 2'9" at the same show.

Fences 2'6"		Entry Fee: \$55/class
280, 281, 282, 283	Baby Green Hunter O/F	284 - U/S

### SHORT STIRRUP HUNTER

Open to riders 11 years of age and under who have never shown over 2'6". No In and Out. No Oxers.

Fences 2'0"		Entry Fee: \$50/class
900, 901, 902, 903CL	Short Stirrup Hunter O/F	904 - U/S
926	Short/Long Stirrup Hunter Classic	Entry Fee: \$50

### LONG STIRRUP HUNTER

Open to riders 12 years of age and over who have never shown over 2'6". No In and Out, No Oxers.

Fences 2'0"		Entry Fee: \$50/class
905, 906, 907, 908CL	Long Stirrup Hunter O/F	909 - U/S
926	Short/Long Stirrup Hunter Classic	Entry Fee: \$50

### SHORT/LONG STIRRUP EQUITATION

Open to riders who have never shown over 2'6".

Fences 2'0"		Entry Fee: \$50/class
910	Short Stirrup Eq. O/F	912 - Flat
913	Long Stirrup Eq. O/F	915 - Flat

### WALK, TROT

Open to riders who have never shown over 2'6". May cross enter into Crossrails only

921, 922, 923, 924	Walk, Trot Ground Rails	Entry Fee: \$50/class
		925 - Flat

### CROSSRAILS

May cross enter Short or Long Stirrup

916, 917, 918, 919	Crossrails - Child O/F	Entry Fee: \$50/class
9161, 9171, 9181, 9191	Crossrails - Adult O/F	920 - Flat
		9201 - Flat



## FEATURED HUNTER CLASSES, WEEKS I-III, V-VIII

**Hunter Derby horses may only show in one derby.**

Prize money to be distributed: 30%-22%-13%-8%-6%-5%-4%-3%-3%-2%-2%-2%

- |            |   |                                   |
|------------|---|-----------------------------------|
| <b>404</b> | <b>\$10,000 USHJA National 3' Hunter Derby - Open</b><br>Fences 3' with 3'5" options. Top 12 MUST ride for ribbons or forfeit prize money.        | Entry Fee: \$425 + \$35 USHJA fee |
| <b>405</b> | <b>\$10,000 USHJA National 3' Hunter Derby - Jr/Am</b><br>Fences 3' with 3'5" options. Top 12 MUST ride for ribbons or forfeit prize money.       | Entry Fee: \$425 + \$35 USHJA fee |
| <b>406</b> | <b>\$12,500 World Equestrian Center Hunter Derby</b><br>Fences 3'6"-3'9" with 4' options. Top 12 MUST ride for ribbons or forfeit prize money.    | Entry Fee: \$450                  |
| <b>407</b> | <b>\$2,000 USHJA Pony Hunter Derby</b><br>Fences 2'3"/2'6"/2'9". Top 12 MUST ride for ribbons or forfeit prize money.                             | Entry Fee: \$200 + \$35 USHJA fee |
| <b>408</b> | <b>\$2,500 World Equestrian Center Non-Pro Hunter Derby 2'6"</b><br>Open to horse/rider combinations that have not shown above 2'9" at this show. | Entry Fee: \$225                  |

## STANDLEE/USHJA NATIONAL HUNTER DERBY REGIONAL CHAMPIONSHIP (week II only)

**Hunter Derby horses may only show in one derby.**

Prize money to be distributed: 30%-22%-13%-8%-6%-5%-4%-3%-3%-2%-2%-2%

- |            |   |                  |
|------------|---|------------------|
| <b>404</b> | <b>\$12,500 Standlee/USHJA National Hunter Derby Regional Championship - Open</b><br>Fences 3' with 3'5" options. Top 12 MUST ride for ribbons or forfeit prize money.    | Entry Fee: \$475 |
| <b>407</b> | <b>\$12,500 Standlee/USHJA National Hunter Derby Regional Championship - Junior</b><br>Fences 3' with 3'5" options. Top 12 MUST ride for ribbons or forfeit prize money.  | Entry Fee: \$475 |
| <b>408</b> | <b>\$12,500 Standlee/USHJA National Hunter Derby Regional Championship - Amateur</b><br>Fences 3' with 3'5" options. Top 12 MUST ride for ribbons or forfeit prize money. | Entry Fee: \$475 |

## USHJA INTERNATIONAL HUNTER DERBY (week V only)

- |            |   |                                   |
|------------|---|-----------------------------------|
| <b>409</b> | <b>\$40,000 USHJA International Hunter Derby - Week V</b><br>Fences 3'6"-3'9" with 4' options. Top 12 MUST ride for ribbons or forfeit prize money. 24 hour check-in required.<br>Prize money to be distributed: 30%-22%-13%-8%-6%-5%-4%-3%-3%-2%-2%-2% | Entry Fee: \$700 + \$50 USHJA fee |
|------------|---|-----------------------------------|

## FEATURED HUNTER CLASSES, WEEKS IV & IX

**Hunter Derby horses may only show in one derby.**

Prize money to be distributed: 30%-22%-13%-8%-6%-5%-4%-3%-3%-2%-2%-2%

- |            |   |                                   |
|------------|---|-----------------------------------|
| <b>404</b> | <b>\$5,000 USHJA National 3' Hunter Derby - Open</b><br>Fences 3' with 3'5" options. Top 12 MUST ride for ribbons or forfeit prize money.         | Entry Fee: \$225 + \$35 USHJA fee |
| <b>405</b> | <b>\$5,000 USHJA National 3' Hunter Derby - Jr/Am</b><br>Fences 3' with 3'5" options. Top 12 MUST ride for ribbons or forfeit prize money.        | Entry Fee: \$225 + \$35 USHJA fee |
| <b>406</b> | <b>\$7,500 World Equestrian Center Hunter Derby</b><br>Fences 3'6"-3'9" with 4' options. Top 12 MUST ride for ribbons or forfeit prize money.     | Entry Fee: \$325                  |
| <b>407</b> | <b>\$1,000 USHJA Pony Hunter Derby</b><br>Fences 2'3"/2'6"/2'9". Top 12 MUST ride for ribbons or forfeit prize money.                             | Entry Fee: \$100 + \$35 USHJA fee |
| <b>408</b> | <b>\$1,500 World Equestrian Center Non-Pro Hunter Derby 2'6"</b><br>Open to horse/rider combinations that have not shown above 2'9" at this show. | Entry Fee: \$150                  |

## FEATURED HUNTER CLASSES, SEASON OPENER

### Hunter Derby horses may only show in one derby.

Prize money to be distributed: 30%-22%-13%-8%-6%-5%-4%-3%-3%-2%-2%-2%

#### 404 \$6,500 USHJA National 3' Hunter Derby - Open

Entry Fee: \$225 + \$35 USHJA Fee

Top 12 must ride for ribbons or forfeit prize money.

#### 408 \$1,000 World Equestrian Center Hunter Derby - Non Pro 2'6"

Entry Fee: \$105

Open to Horse/Rider combinations that have not shown above 2'9" at this show.

## 2025 USHJA INTERNATIONAL HUNTER DERBY SPECIFICATIONS

### Membership and Participation Requirements

- Riders, Owners and Trainers must be current Active Members of USEF and USHJA before the start of the class.
- Horses must be recorded with the Federation and registered with USHJA.
- Horses must be enrolled or pay a non-enrolled horse fee to participate in a USHJA International Hunter Derby.
- The same horse may not compete in the USHJA International Derby and the National Hunter Derby at the same competition.
- Horses entered in this class are not required to show in any other hunter or jumper classes at the horse show.
- Attire: Refer to HU107 in the USEF Rule Book for current specifications.
- In accordance with HU174.14 the same horse-and-rider combination must compete in both rounds of the International Hunter Derby.

### Enrollment Policy

- Horses must be enrolled to participate in the USHJA International Hunter Derby, to be eligible for Regional Awards, to be included on the USHJA IHD Money Won list and to compete in any Derby Championship.
  - Upon enrollment in the Derby Program, horses' earnings, from date of enrollment forward through November 30, 2025, will be included on the USHJA International Hunter Derby Money Won list and count toward Regional Awards. Horses must be enrolled in the program before competing in a Derby, if they wish the money won in that Derby to count toward standings, regardless of the start date of the competition.
  - Money (and points) won by horses not enrolled in the Derby Program will not be included on the USHJA International Hunter Derby Money Won list or Regional Award Standings.
- Year End Regional Award Standings
  - Owners must declare their horse's region upon enrollment of the horse and the region may not be changed during the Derby Series year.
  - Owners may choose one region in which to declare their horse(s); the region declared does not have to be the owner's home region.
- Annual Enrollment Fee
  - \$450 and enrollment begins on December 1 of current year.
  - Horses may only be enrolled online and it is the exhibitor's responsibility to enroll a horse in a timely manner in order to be eligible to receive credit for money won. There will be no exceptions allowed regarding enrollment dates for program eligibility.
- Non-enrolled horse fee
  - \$150 per horse entered in an International Hunter Derby without current enrollment. There is no limit to the number of IHDs a horse may compete in without enrollment. The non-enrolled horse fee applies to every IHD entered unless/until enrolling. Any non-enrolled horse fee paid does not credit towards an enrollment fee for the current competition year.

### Stabling/Schooling

- All horses competing in the Derby class must be on the competition grounds a minimum of 24 hours prior to the start of the first round of the class. All horses will be monitored and must remain on the competition grounds until the horse is finished competing in the Derby class. Any horse that leaves the competition grounds prior to completing its participation in the Derby class is disqualified.

[View all class specifications here.](#)



# FEI EVENTS FOR SUMMER SERIES 2025

## SUMMER SERIES I JUNE 10-15 | FEI CSI2\*

2201	\$1,000 1.40m CSI2* Two Phase Special
2202	\$32,000 1.45m CSI2* Speed
2203	\$32,000 1.45m CSI2* Grand Prix Qualifier
2204	\$75,000 1.45m CSI2* WEC Grand Prix

## SUMMER SERIES II 6/17-22 | FEI CSI3\*

3301	\$1,000 1.40m CSI3* Two Phase Special
3302	\$32,000 1.45m CSI3* Speed
3303	\$32,000 1.50m CSI3* Grand Prix Qualifier
3304	\$130,000 1.50m CSI3* WEC Grand Prix

## SUMMER SERIES III JUNE 24-29 | FEI CSI2\* | FEI CSI4\*

2201	\$1,000 1.40m CSI2* Two Phase Special	4401	\$1,000 1.40m CSI4* Two Phase Special
2202	\$32,000 1.45m CSI2* Speed	4402	\$32,000 1.45m CSI4* Speed
2203	\$32,000 1.45m CSI2* Grand Prix Qualifier	4403	\$63,000 1.50m CSI4* Grand Prix Qualifier
2204	\$65,000 1.45m CSI2* WEC Grand Prix	4404	\$32,000 1.45 CSI4* Winning Round
		4405	\$185,000 1.50m CSI4* WEC Grand Prix

## SUMMER SERIES IV JULY 1-6 | FEI CSI2\*

2201	\$1,000 1.40m CSI2* Two Phase Special
2202	\$32,000 1.45m CSI2* Speed
2203	\$32,000 1.45m CSI2* Grand Prix Qualifier
2204	\$65,000 1.45m CSI2* WEC Grand Prix

## SUMMER SERIES V JULY 8-13 | FEI CSI3\*

3301	\$1,000 1.40m CSI3* Two Phase Special
3302	\$32,000 1.45m CSI3* Speed
3303	\$32,000 1.50m CSI3* Grand Prix Qualifier
3304	\$130,000 1.50m CSI3* WEC Grand Prix

# FEI EVENTS FOR SUMMER SERIES 2025

## SUMMER SERIES VI JULY 15-20 | FEI CSI3\*

3301	\$1,000 1.40m CSI3* Two Phase Special
3302	\$32,000 1.45m CSI3* Speed
3303	\$32,000 1.50m CSI3* Grand Prix Qualifier
3304	\$130,000 1.45m CSI3* WEC Grand Prix

## SUMMER SERIES VII JULY 22-27 | FEI CSI2\*

2201	\$1,000 1.40m CSI2* Two Phase Special
2202	\$32,000 1.45m CSI2* Speed
2203	\$32,000 1.45m CSI2* Grand Prix Qualifier
2204	\$65,000 1.45m CSI2* WEC Grand Prix

## SUMMER SERIES VIII JULY 29-AUG 3 | FEI CSI2\*

2201	\$1,000 1.40m CSI2* Two Phase Special
2202	\$32,000 1.45m CSI2* Speed
2203	\$32,000 1.45m CSI2* Grand Prix Qualifier
2204	\$65,000 1.45m CSI2* WEC Grand Prix

## SUMMER SERIES IX AUG 5-10 | FEI CSI3\*

3301	\$1,000 1.40m CSI3* Two Phase Special
3302	\$32,000 1.45m CSI3* Speed
3303	\$32,000 1.50m CSI3* Grand Prix Qualifier
3304	\$130,000 1.50m CSI3* WEC Grand Prix



## JUMPER DIVISIONS, WEEKS I - IX

**Jumper Nomination Fee:** \$200 for all 1.10m and above except where noted.

**Stabling/Check-in:** All horses competing in classes with \$25,000 or more in prize money MUST check in and remain on the grounds 24 hours prior to the class.

**Attire:** Formal Attire is required for all classes offering \$20,000 or more in prize money and all classics.

Proper Attire - JP111.9B required for all classes in the WEC Grand Arena

Standard Attire in all other classes (JP111.9C)

**Order of Go:** In classes offering \$5,000 or more and where management deems necessary all horses names and positions will be drawn by the computer.

**Ties:** All ties for 1st place will be jumped off as specified; ties for other than 1st place will be decided by the time taken in the first round.

**Declarations:** All horses must be declared (entered) in classes in which they intend to show by 4:00 PM the day previous to the class to ensure entry to the class.

**Championships:** Points will be distributed 10-6-4-2-1-1/2, except bonus class which will be 15-9-6-3-2-1. Bonus class breaks ties. Bonus Classes are always the last class of the section, denoted with an \*.

**Prize Money:** Classes \$1,200 or less, unless otherwise specified: 1st-30%/2nd-22%/3rd-15%/4th-12%/5th-11%/6th-10%

**Prize Money:** Classes over \$1,200 to \$5,000, unless otherwise specified: 1st-25%/2nd-19%/3rd-15%/4th-10%/5th-9%/6th-8%/7th-7%/8th-7%

**Prize Money:** Classes over \$5,000 to \$10,000, unless otherwise specified: 1st-25%/2nd-19%/3rd-14%/4th-9%/5th-8%/6th-7%/7th-6%/8th-5%/9th-4%/10th-3%

**Prize Money:** Classes over \$10,000, unless otherwise specified: 1st-30%/2nd-22%/3rd-13%/4th-8%/5th-6%/6th-5%/7th-4%/8th-3%/9th-3%/10th-12th-2%

**THE TIME ALLOWED IS BASED ON A MINIMUM SPEED OF 382 YARDS (350 m/m) PER MINUTE.** At all heights, to qualify as a spread fence, the fence must be 5cm (2") up to 15cm (6") wider.

## JUMPER DIVISIONS: NO NOMINATION FEE

### .65M JUMPERS

600, 601, *602	\$100 .65m Jumpers Open	Entry Fee: \$55/class
603, 604, *605	\$100 .65m Jumpers Jr/Am	Entry Fee: \$55/class

### .80M JUMPERS

612, 613, *614	.80m Jumpers Open	Entry Fee: \$55/class
615, 616, *617	.80m Jumpers Jr/Am	Entry Fee: \$55/class

### .85M JUMPERS

618, 619, *620	.85m Jumpers Open	Entry Fee: \$55/class
621, 622, *623	.85m Jumpers Jr/Am	Entry Fee: \$55/class

### .95M JUMPERS

624, 625, *626	.95m Jumpers Open	Entry Fee: \$55/class
----------------	-------------------	-----------------------

### 1.0M JUMPERS

627, 628, *629	1.0m Jumpers Open	Entry Fee: \$55/class
----------------	-------------------	-----------------------



## JUMPER DIVISIONS: NO NOMINATION FEE

### 1.10M JUMPERS

630, 631, *632	1.10m Jumpers Open	Entry Fee: \$55/class
----------------	--------------------	-----------------------

### 1.15M JUMPERS

633, 634	1.15m Jumpers Open	Entry Fee: \$55/class
----------	--------------------	-----------------------

### 1.20M JUMPERS

Open to all. No cross entry restrictions. No Jumper Nomination Fee.

636, 637, *638	\$500 1.20m Jumpers Open	Entry Fee: \$55/class
----------------	--------------------------	-----------------------

### THOROUGHBRED JUMPERS (1.0M)

695, 696, *697	\$100 TAKE 2 TB Jumpers 1.0m	Entry Fee: \$55/class
----------------	------------------------------	-----------------------

### YOUNG JUMPER CLASSES

Proof of age required with USEF. No Jumper Nomination Fee.

See schedule for Table and classes offered at each show. Only running martingales permitted.

686, 687, 688	Young Jumper 5 Year Old, 1.10-1.15m, Table II	Entry Fee: \$30/class
689, 690, *691	\$250 Young Jumper 6 Year Old, 1.20-1.25m	Entry Fee: \$40/class
692, 693, *694	\$250 Young Jumper 7 Year Old, 1.30-1.35m	Entry Fee: \$40/class

## OPEN JUMPER NOMINATED DIVISIONS

**Jumper Nomination Fee: \$200**

\*Six entries to fill and hold the class.

### 1.30M JUMPERS

Open to all. No cross entry restrictions.

642, 643, *644	\$1,000 1.30m Jumpers	Entry Fee: \$75/class
----------------	-----------------------	-----------------------

### 1.35M JUMPERS

Open to all. No cross entry restrictions.

645, 646, *647	\$1,000 1.35m Jumpers	Entry Fee: \$75/class
----------------	-----------------------	-----------------------

### 1.40M/1.45M JUMPERS

Open to all. No cross entry restrictions.

648, 649	\$1,500 1.40m Jumpers	Entry Fee: \$95/class
650	\$2,000 1.45m Jumpers	Entry Fee: \$140
*856	\$7,500 1.40m Jumper Classic	Entry Fee: \$150

## JUNIOR/AMATEUR JUMPER NOMINATED DIVISIONS

### Jumper Nomination Fee: \$200

Horse/Rider combinations may compete in only one classic at the same show.

\*Six entries to fill and hold the class.

### 1.40M/1.45M JUNIOR/AMATEUR JUMPERS

781, 782	\$2,500 1.40m Junior/Amateur Jumpers	Entry Fee: \$175/class
*855	\$10,000 1.45m Junior/Amateur Jumper Classic	Entry Fee: \$250

### 1.30M/1.35M JUNIOR/AMATEUR JUMPERS

775, 776	\$2,000 1.30m Junior/Amateur Jumpers	Entry Fee: \$140/class
*853	\$5,000 1.35m Junior/Amateur Jumper Classic	Entry Fee: \$200

### 1.20M/1.25M JUNIOR/AMATEUR JUMPERS

768, 769	\$1,500 1.20m Junior/Amateur Jumpers	Entry Fee: \$105/class
*851	\$5,000 NAL 1.25m Junior/Amateur Jumper Classic	Entry Fee: \$200

### 1.15M JUNIOR/AMATEUR JUMPERS

757, 758	\$600 1.15 Junior/Amateur Jumpers	Entry Fee: \$65/class
*816	\$3,000 1.15 Junior/Amateur Jumper Classic	Entry Fee: \$175

### 1.10M JUNIOR JUMPERS

Horse/Rider combinations may not cross enter in any class offering prize money at 1.20m or above.

Fences 1.10m-1.15m, see Zone 4 specs.

749, 750	\$500 1.10m Junior Jumpers	Entry Fee: \$65/class
*813	\$2,500 NAL/WIHS Junior Jumper Classic	Entry Fee: \$150

### 1.10M AMATEUR JUMPERS

Horse/Rider combinations may not cross enter in any class offering prize money at 1.20m or above.

Fences 1.10m-1.15m, see Zone 4 specs.

755, 756	\$500 1.10m Amateur Jumpers	Entry Fee: \$65/class
*815	\$2,500 NAL/WIHS Amateur Jumper Classic	Entry Fee: \$150

## JUNIOR/AMATEUR JUMPER DIVISIONS: NO NOMINATION FEE

### No Nomination Fee Required

Horse/Rider combinations may compete in only one classic at the same show.

\*Six entries to fill and hold the class.

### 1.00M/1.05M JUNIOR JUMPERS

Fences 1.00m-1.05m, see Zone 4 specs.

737, 738

\$200 1.00m Junior Jumpers

Entry Fee: \$60/class

\*811

\$750 1.05m Junior Jumper Classic

Entry Fee: \$75

### 1.00M/1.05M AMATEUR JUMPERS

Fences 1.00m-1.05m, see Zone 4 specs.

740, 741

\$200 1.00m Amateur Jumpers

Entry Fee: \$60/class

\*812

\$750 1.05m Amateur Jumper Classic

Entry Fee: \$75

### .90M-.95M NOVICE JUNIOR JUMPERS

Fences .90m-.95m

Rider may not compete in any class above 1.00m at the same show.

731, 732

\$150 .90m Novice Junior Jumpers

Entry Fee: \$60/class

\*809

\$500 .95m Novice Junior Jumper Classic

Entry Fee: \$65

### .90M-.95M NOVICE AMATEUR JUMPERS

Fences .90m-.95m

Rider may not compete in any class above 1.00m at the same show.

734, 735

\$150 .90m Novice Amateur Jumpers .90m

Entry Fee: \$60/class

\*810

\$500 .95m Novice Amateur Jumper Classic .95m

Entry Fee: \$65





## JUMPER DIVISIONS, SEASON OPENER

**Attire:** Formal Attire is required for all classes offering \$20,000 or more in prize money and all classics.

Proper Attire - JP111.9B required for all classes in the WEC Grand Arena

Standard Attire in all other classes - see JP111.9C

**Order of Go:** In classes offering \$5000 or more and where management deems necessary all horses names and positions will be drawn by the computer.

**Ties:** All ties for 1st place will be jumped off as specified; ties for other than 1st place will be decided by the time taken in the first round.

**Declarations:** All horses must be declared (entered) in classes in which they intend to show by 4:00 P.M. the day previous to the class to ensure entry to the class.

**Championships:** Points will be distributed 10-6-4-2-1-1/2, except the bonus class which will be 15, 9, 6, 3, 2, 1. Bonus class breaks ties. Bonus Classes are always the last class of the section-denoted with an \*

**Prize Money:** Classes \$1200 or less unless otherwise specified - 1st-30% / 2nd-22% / 3rd-15% / 4th-12% / 5th-11% / 6th-10%

**Prize Money:** Classes over \$1200 to \$5000 unless otherwise specified - 1st-25% / 2nd-19% / 3rd-15% / 4th-10% / 5th-9% / 6th-8% / 7th- 7% / 8th-7%

**Prize Money:** Classes over \$5000 to \$10000 unless specified - 1st-25% / 2nd-19% / 3rd-14% / 4th-9% / 5th-8% / 6th-7% / 7th- 6% / 8th-5% 9th-4%/10th-3%

**Prize Money:** Classes over \$10000 unless specified - 1st-30% / 2nd-22% / 3rd-13% / 4th-8% / 5th-6% / 6th-5% / 7th- 4% / 8th-3% / 9th-3% 10th-12th 2%

**THE TIME ALLOWED IS BASED ON A MINIMUM SPEED OF 382 YARDS (350 m/m) PER MINUTE** At all heights to qualify as a spread fence, the fence must be 5cm (2") up to 15cm (6") wider.

## YOUNG JUMPER CLASSES

Proof of Age Required with USEF.

No Nomination Fee

See schedule for Table and classes offered in each show. Only running martingales permitted.

686, 687, 688  
689, 690, \*691  
692, 693, \*694

Young Jumper 5 Year Old 1.15-1.20m  
Young Jumper 6 Year Old 1.20-1.25m  
Young Jumper 7 Year Old 1.30-1.35m

Entry Fee: \$30/class  
Entry Fee: \$30/class  
Entry Fee: \$30/class

## JUNIOR/AMATEUR JUMPER DIVISIONS

The same horse/rider combination may not compete in both the High and Low Classic at the same show.

Nominating fee \$150 for any classes that offer prize money.

6 Entries to fill and Hold Classics

\* Bonus Points

### 1.40M JUNIOR/AMATEUR JUMPERS

781, 782	1.40m Junior/Amateur Jumpers	Entry Fee: \$55/class
*855	\$1,500 1.40m Junior/Amateur Jumper Classic	Entry Fee: \$105

### 1.30M JUNIOR/AMATEUR JUMPERS

775, 776	1.30m Junior/Amateur Jumpers	Entry Fee: \$55/class
*853	\$1,500 1.35m Junior/Amateur Jumper Classic	Entry Fee: \$105

### 1.20M JUNIOR/AMATEUR JUMPERS

768, 769	1.20m Junior/Amateur Jumpers	Entry Fee: \$55/class
*851	\$1,500 1.25m Junior/Amateur Jumper Classic	Entry Fee: \$105

### 1.15M JUNIOR/AMATEUR JUMPERS

See Zone 4 Specs. Horse/Rider combination may not cross enter in any class offering prize money at 1.20m or above.  
Fences 1.10m-1.15m

757, 758	1.15m Junior/Amateur Jumper	Entry Fee: \$55/class
*816	\$750 1.15m Junior/Amateur Jumper Classic	Entry Fee: \$75

### 1.10M JUNIOR/AMATEUR JUMPERS

See Zone 4 Specs. Horse/Rider combination may not cross enter in any class offering prize money at 1.20m or above.  
Fences 1.10m-1.15m

749, 750	1.10m Junior/Amateur Jumper	Entry Fee: \$55/class
*813	\$500 NAL/WIHS 1.10m Junior/Amateur Jumper Classic	Entry Fee: \$60

### 1.00M JUNIOR/AMATEUR JUMPERS

See Zone 4 Specs. Horse/Rider combination may not cross enter in any class offering prize money at 1.20m or above.  
Fences 1.00m-1.05m

737, 738	1.00m Junior/Amateur Jumper	Entry Fee: \$55/class
*811	\$500 NAL/WIHS 1.00m/1.05m Jr/Am Jumper Classic	Entry Fee: \$60

### NOVICE JUNIOR/AMATEUR JUMPERS (.90M)

Fences .90-.95m Rider may not compete in any class above 1.00m at the same show.

731, 732	Novice Junior/Amateur Jumper .90m	Entry Fee: \$55/class
*809	Novice Junior Jumper Classic .95m	Entry Fee: \$55

## JUMPER DIVISIONS, NO NOMINATION FEE

### .65M JUMPERS

600, 601, \*602

.65 Jumpers Open

Entry Fee: \$55/class

### .75M JUMPERS

606, 607, \*608

.70m Jumpers Open

Entry Fee: \$55/class

### .80M JUMPERS

612, 613, \*614

.80m Jumpers Open

Entry Fee: \$55/class

### .85M JUMPERS

618, 619, \*620

.85m Jumpers Open

Entry Fee: \$55 /class

### .90M JUMPERS

624, 625, \*626

.90m Jumpers Open

Entry Fee: \$55/class

### 1.0M JUMPERS

627, 628, \*629

1.0m Jumpers Open

Entry Fee: \$55/class

### 1.10M JUMPERS

630, 631, \*632

1.10m Jumpers Open

Entry Fee: \$55/class

### 1.15M JUMPERS

633, 634, \*635

1.15m Jumpers Open

Entry Fee: \$55/class

### THOROUGHBRED JUMPERS (1.0M)

695, 696, \*697

1.0m Take 2 Thoroughbred Jumper

Entry Fee: \$55/class

### 1.20M JUMPERS

636, 637, \*638

1.20m Jumpers

Entry Fee: \$50/class

### 1.25M JUMPERS

639, 640, \*641

1.25m Jumpers

Entry Fee: \$55/class

### 1.30M JUMPERS

642, 643, \*644

1.30m Jumpers

Entry Fee: \$55/class

### 1.40M JUMPERS

648, 649, \*650

1.40m Jumpers

Entry Fee: \$55/class



## FEATURED JUMPER CLASSES, WEEKS I - IX

- 804 \$24,000 World Equestrian Center Welcome Prix II.2a** (weeks 1, 2, 4-9) Entry Fee: \$375  
1.40m, Formal Attire Required
- 805 \$50,000 World Equestrian Center Grand Prix II.2a** (weeks 1, 2, 4-9) Entry Fee: \$600  
National Standard/1.45m, Formal Attire Required.  
Included in Rolex/USEF Ranking list. 24 hour check-in required.
- 803 \$10,000 Futures Prix II.2b** Entry Fee: \$250  
1.35m-1.40m, Formal Attire Required.  
Open to all horses that will not compete in the Grand Prix at this show.

## FEATURED JUMPER CLASSES, SEASON OPENER

- 804 \$3,500 World Equestrian Center Welcome Prix II.2a** Entry Fee: \$225  
1.30m Formal Attire Required.
- 802 \$20,000 Regional Standard Grand Prix II.2a** Entry Fee: \$400  
1.35m/1.40m. Formal Attire Required.



Please visit [ryegate.com/usef/php](https://ryegate.com/usef/php) upcoming classes to determine which classes will be included in the Rolex Computer Ranking List.



## EQUITATION

### HUNTER SEAT EQUITATION CLASSES, ALL WEEKS - \$50 EACH

Championships will be awarded in all divisions that hold 3 classes.

500, 501	<b>Equitation 11 &amp; U O/F 2'</b>	502	<b>Equitation 11 &amp; U - Flat</b>
503, 504	<b>Equitation 12-14 O/F 2'9"</b>	505	<b>Equitation 12-14 - Flat</b>
506, 507	<b>Equitation 15-17 O/F 3'3"</b>	508	<b>Equitation 15-17 - Flat</b>
509, 510	<b>Adult Equitation O/F 3'</b>	511	<b>Adult Equitation - Flat</b>
512, 513	<b>Children's Equitation O/F 3'</b>	514	<b>Children's Equitation - Flat</b>
515, 516	<b>Low Child Equitation O/F 2'6"</b>	517	<b>Low Child Equitation - Flat</b>
518, 519	<b>Low Adult Equitation O/F 2'6"</b>	520	<b>Low Adult Equitation - Flat</b>
521, 522	<b>Pony Equitation O/F 2'3"/2'6"/2'9"</b>	523	<b>Pony Equitation - Flat</b>
524, 525	<b>Children's Pony Equitation O/F 2'/2'6"</b>	526	<b>Children's Pony Equitation - Flat</b>

### HUNTER SEAT MEDAL CLASSES, ALL WEEKS - \$65 EACH

- 534 **Ariat Adult Medal 3'** - No Minimum to fill. Open to all Amateur members of USEF and Equine Canada. Riders may not show in the jumpers set above 1.20m.
- 538 **USHJA 3'3" Jumping Seat Medal** - A minimum of 3 riders must complete.
- 537 **USHJA Amateur Jumping Seat Medal** - A minimum of 3 riders must complete.
- 539 **USHJA 3'3" Hunter Seat Medal** - A minimum of 3 riders must complete.
- 546 **WIHS Pony Equitation** - A minimum of 3 riders must complete for the class to be included in the National Ranking.
- 535 **THIS Children's Medal 3' 14 and under**      536 **THIS Children's Medal 3' 15-17**  
Open to all Junior members of the USEF and Equine Canada who have never competed in the USEF Hunter Seat Medal Finals, ASPCA Maclay Finals, USEF Talent Search Medal Finals, Jump Canada Medal Finals, WIHS Junior Equitation Medal Finals of North American Equitation Championships.
- 529 **WIHS Equitation** - Hunter Phase
- 530 **WIHS Equitation** - Jumper Phase
- 531 **WHIS Overall** - No entry fee - Must do both phases
- 532 **ASPCA Horsemanship Class 3'6"** (rider and trainer must be NHS members)
- 533 **Hamel Foundation NHS Equitation 3'3"** (rider and trainer must be NHS members)  
Open to all Junior members of the USEF and Equine Canada who have never competed in the USEF Hunter Seat Medal Finals, ASPCA Maclay Finals, USEF Talent Search Medal Finals, Jump Canada Medal Finals, WIHS Junior Equitation Medal Finals of North American Equitation Championships.
- 547 **NHS THIS Adult Equitation 3'** (rider and trainer must be NHS members)
- 548 **WEC Premier Cup Equitation Qualifier 3'6"** - current WEC Equitation Cup specs on next page.
- 549 **NCEA Medal** - Open to Junior active Members of the Federation or Equine Canada. Riders must apply for NCEA Medal Membership in order for points to count. For full class specifications and additional information at [www.collegiateequestrian.com](http://www.collegiateequestrian.com).

### USEF MEDAL CLASSES, ALL WEEKS - \$65 EACH

- 528 **Dover Saddlery/USEF Hunter Seat Medal 3'6"** - Must have 3 riders complete.
- 545 **Marshall & Sterling/USEF Pony Medal** - Must have 3 riders complete.
- 527 **Platinum Performance/USEF Show Jumping Talent Search**  
1\* - Must have 3 riders complete. For a 1\* & 2\* both the Jumping and Flat phases of the class must be held in a jumper or equitation ring. For a 3\*, the Jumping phase of the class MUST be held in one of the Main Grand Prix competition rings.



## WORLD EQUESTRIAN CENTER PREMIER EQUITATION CUP SPECIFICATIONS

Open to all Junior members of the USEF/USHJA and Equine Canada. To be shown over a minimum of eight fences 3'6" in height, spreads not to exceed 4' (exception: triple bar type obstacles, maximum spread of 5'). The course may be either a Jumper or Hunter type course and must include at least two changes of direction, a combination and two of the following: bending line, narrow jump (5'6"-8'), roll back turn, fences at end of ring, long approach to a single jump. Water obstacles (i.e.; water jump, liverpool) are not permitted. A minimum of twelve riders, if available, are required to show at a walk, trot and canter. To be judged on seat, hands, guidance and control of horse. The Under Saddle performance of those riders selected to show under saddle shall count 50%. A rider must complete both phases to be eligible for a placing. Only one rider per horse. The same horse must be used in all phases. Class to be judged in accordance with the current USEF Standards for equitation. USEF tests EQ113 permitted. Three riders must complete the course for the class to count.

Qualifying Period: All classes held at shows starting on or after February 1 of the previous year, through shows starting on or before January 31 of the current year will be counted toward current year finals.



©ANDREW RYBACK 2025



# 2025 ZONE 4 HUNTER, JUMPER, AND EQUITATION SPECIFICATIONS

(AL, FL, GA, MS, SC, TN)

In accordance with GR 1111.4: **Contiguous states are:** AR, KY, LA, MO, NC, VA

## **Judging for all Hunter Sections:**

- To be judged on performance and soundness, suitability to count.
- Horses and Ponies are not required to jog for soundness.

## **Eligibility for Adult Amateurs: Hunter, Jumper, and Equitation:**

- To be ridden by exhibitors who have reached their 18th birthday as of December 1 of the current competition year and who hold a current USEF Amateur certification. Open to horses and ponies.

## **Eligibility for Children's Sections: Hunter, Jumper, and Equitation:**

- To be ridden by exhibitors who have not reached their 18th birthday as of December 1 of the current competition year.

## ADULT AMATEUR HUNTER

**Sections offered and requirements:** Adult Amateurs may be split into three (3) sections.

### **Cross Entry:**

**Rider:** Riders in this sections may enter any Equitation class and any class where otherwise eligible. Riders who compete in the Amateur Owner Hunter and/or Jumper classes may show other horses that they own in the Adult Amateur Hunters. Riders competing in the Amateur Owner 3'3" section (but not competing in the Amateur Owner 3'6" section) may ride one horse that they do not own in the Adult Amateur Hunter section.

**Horse:** Horses and ponies exhibiting in this section may cross enter multiple sections of Adult Amateur Hunter and any classes where eligible.

### **Fence Height:**

3'0" with spreads not to exceed the fence height.

Courses will not be adjusted for ponies.

In and outs will be permitted.

### **Combining/Dividing Sections:**

May be split into three sections:

Adult Amateurs 18-35

Adult Amateurs 36-54

Adult Amateurs 55 & Over

The Adult Amateur Hunter section may be divided by age of rider and/or height of fences. If there are fewer than three (3) entries in a section, that section must be combined with another Adult Amateur section. The Adult Amateur Hunter section may be combined with the Children's Hunter section when there are fewer than three (3) entries in either section. When sections are combined and there are more than 24 total entries, the sections must be divided utilizing a Floating split, or a California split to create an even division of entries.

### **Classics: Adult Amateur Hunter Classics**

Four (4) entries are required to conduct an Adult Amateur Hunter Classic. If there are fewer than Four (4) entries in any one Adult Amateur Hunter Classic, it may combine with other sections of Adult Amateur Hunters or Children's Hunter Horse. If Adult Amateur Hunter Classics are combined and a horse is show in more than one section qualifying for the Adult Amateur Hunter Classic, the exhibitor must declare their point section to the Competition Secretary on a declaration form at the time of entry into the classic.

Adult Amateur Hunter Classics cannot be divided in any manner and held by section if there are fewer than six (6) entries in each divided section.

**Awards:** Zone Horse of the Year Awards will be presented annually to the following sections:

Adult Amateur Hunter 18-35

Adult Amateur Hunter 36-54

Adult Amateur Hunter 55 & Over

## LOW ADULT AMATEUR HUNTER

**Eligibility:** Open to exhibitors who have reached their 18th birthday as of December 1 of the current competition year.

**Cross Entry:**

**Rider:** Riders may not cross enter into any class or section at the same competition where fences exceed 3'3" (Exception: All equitation classes and Jumper classes 1.15m and below). Riders who compete in the 3' Adult Hunters and/or the 3'3" Amateur Owner Hunter classes may show horses that they own in the Low Adult Hunters and one that they do not own in the Low Adult Hunters.

**Horse and Rider Combination:** Low Adult Amateur Hunter horse/rider combinations may not cross enter into any classes or section where fences exceed 2'9".

**Fence Height:**

2'6"

**Combining/Dividing Sections:**

The Low Adult Amateur Hunter section may be combined with the Low Children's Hunter section when there are fewer than four (4) entries in either section. If sections are combined and there are more than 24 total entries, the sections must be divided utilizing a Floating split, or a California split to create an even division of entries.

**Awards:** Zone Horse of the Year Awards will be presented annually to the following sections:

Low Adult Amateur Hunter

## ADULT AMATEUR JUMPER

**Sections offered and requirements:**

1.00m/1.05m Amateur Jumpers

1.10m/1.15m Amateur Jumpers

**Cross Entry:**

Competition Management may restrict cross entries between 1.10m/1.15m and 1.00m/1.05m sections at the same competition if stated in the prize list.

**Rider:** Any competitor that competes in any class set at over 1.25m is ineligible to compete in an Amateur Jumper class set below 1.20m at that competition.

**Horse and Rider Combinations:** 1.00m/1.05m Amateur Jumper horse/rider combinations may not cross enter into any classes held above 1.15m at the same show. 1.00m/1.05m Amateur Jumper horse/rider combinations may enter only one classic, if both 1.00m/1.05m and 1.10m/1.15m are offered.

1.10m/1.15m Amateur Jumper horse/rider combinations are not permitted to cross enter into Amateur Owner Jumper classes or any class at 1.20m and above, that offers prize money, at the same competition. 1.10m/1.15m Amateur Jumper horse/rider combinations may enter only one classic, if both 1.00m/1.05m and 1.10m/1.15m are offered.

**Fence Height:**

Amateur Jumper 1.00m to 1.05m

Amateur Jumper 1.10m to 1.15m

**Combining/Dividing Sections:**

Junior Jumper sections may be divided by or combined with Amateur Jumper sections, at management's discretion, if so stated in the prize list.

**Awards:** Zone Horse of the Year Awards will be presented annually to the following sections:

1.00m/1.05m Amateur Jumper

1.10m/1.15m Amateur Jumper

## AGE GROUP EQUITATION: ADULT SECTION

**Sections offered:** Adult Equitation 18-35 and Adult Equitation 36 & Over

**Cross Entry:** No cross-entry restrictions

**Fence Height:**

Minimum 2'9", maximum 3'3" - management must state height at which class will be offered.

Management may offer multiple height options if stated in the prize list, but each course must be set at the same height throughout.

Course design must comply with EQ108.11 except combination is optional.

Spreads not to exceed fence height.

**Combining/Dividing Sections:**

Age-Group Equitation Sections may be combined as necessary, jumping at their respective heights, to meet the three (3) entry minimum requirement for points to be awarded. Stallions are prohibited when adult equitation sections are combined with children's/junior equitation sections. EQ101.3.

**Awards:** Zone Horse of the Year Awards will be presented annually to the following sections:

Adult Equitation 18-35

Adult Equitation 36 & Over

## CHILDREN'S HUNTER HORSE

**Sections offered and requirements:** Children's Hunter Horse 14 & Under and Children's Hunter Horse 15-17

**Cross Entry:**

**Rider:** Riders in this sections may enter any Equitation class and may compete with one different horse in the Junior 3'3" Hunter section but may not cross-enter into any Junior 3'6" Hunter or any Jumper class above 1.20m that offers prize money at the same show.

**Horse:** Horses and ponies exhibiting in this section may cross enter multiple sections of Children's Hunter and any classes where eligible.

**Fence Height:**

3'0" with spreads not to exceed the fence height.

In and outs will be permitted.

**Combining/Dividing Sections:**

The Children's Hunter Horse section may be divided by age of rider. When the Children's Hunter Horse section is divided by age it will be divided: Children's Hunter Horse 14 & Under and Children's Hunter Horse 15-17. If there are fewer than three (3) entries in either age section, the two sections must be combined. The Children's Hunter Horse section may be combined with the Children's Hunter Pony section when there are fewer than three (3) entries in either section. Alternatively, the Children's Hunter Horse section may be combined with the Adult Amateur section when there are fewer than three (3) entries in either section. The Children's Hunter (Horse & Pony) section may be combined with the Adult Amateur section when there are fewer than three (2) entries in either section. When sections are combined and there are more than 24 total entries, the sections must be divided utilizing a Floating split, or a California split to create an even division of entries.

**Classics: Children's Hunter Horse Classics**

Four (4) entries are required to conduct a Children's Hunter Horse Classic. If there are fewer than Four (4) entries an any one Children's Hunter Horse Classic, it may combine with other sections of Children's Hunter Horse or Adult Amateur Hunters. If Children's Hunter Horse Classics are combined and a horse is show in more than one section qualifying for the Children's Hunter Horse Classic, the exhibitor must declare their point section to the Competition Secretary on a declaration form at the time of entry into the classic.

Children's Hunter Horse Classics cannot be divided in any manner and held by section if there are fewer than six (6) entries in each divided section.

**Awards:** Zone Horse of the Year Awards will be presented annually to the following sections:

Children's Hunter Horse 14 & Under

Children's Hunter Horse 15-17



## LOW CHILDREN'S HUNTER HORSE

### Eligibility:

Open to exhibitors who have not yet reached their 18th birthday as of December 1 of the current competition year.

### Cross Entry:

**Rider:** Riders may not cross enter into any class or section at the same competition where fences exceed 3'3" (Exception: All equitation classes and Jumper classes 1.15m and below). Riders who compete in the 3' Children's Hunter Horse, Regular A Rated Pony Sections, and/or the 3'3" Junior Hunter classes may show one horse in the Low Children's Hunter.

**Horse and Rider Combination:** Low Children's Hunter horse/rider combinations may not cross enter into any classes or section where fences exceed 2'9".

### Fence Height:

2'6"

### Combining/Dividing Sections:

The Low Children's Hunter section may be combined with the Low Adult Amateur Hunter section when there are fewer than four (4) entries in either section. When sections are combined and there are more than 24 total entries, the sections must be divided utilizing a Floating split, or a California split to create an even division of entries.

**Awards:** Zone Horse of the Year Awards will be presented annually to the following section:

Low Children's Hunter Horse

## CHILDREN'S HUNTER PONY

**Sections offered and requirements:** Small/Medium Children's Pony and Large Children's Pony

### Cross Entry:

**Rider:** Rider age restrictions as found in Regular Pony sections do not apply. Riders may show only one pony in either the 2'0" or the 2'6" height of the Children's Hunter Pony section when also competing in the Regular Small, Medium or Large Pony and/or Green Pony Hunter sections. Riders cannot cross enter into any class where fences exceed 3'3" (exception: Riders may show in Pony Jumpers).

**Horse/Pony:** Ponies exhibited in the Children's Hunter Pony may cross enter into any class where otherwise eligible.

**Horse and Rider Combination:** The rider may not show the same pony in the Regular Pony or the Green Pony Divisions. *Note: The pony may only be shown by one rider in the Children's Hunter Pony Classic and that rider must be declared prior to the first round of the Classic.*

### Fence Height:

Small/Medium Ponies: 2'0" with spreads not to exceed height of fence.

Large Ponies: 2'6" with spreads not to exceed height of fence

In and outs will not be permitted.

### Combining/Dividing Sections:

The Children's Hunter Pony section may be divided by size. If the Children's Hunter Pony is divided by size it will be divided: Children's Hunter Pony Small/Medium and Children's Hunter Pony Large. If there are fewer than three (3) entries in either height section, the two sections must be combined. The Children's Hunter Pony section may be combined with the Low Children's Hunter Pony when there are fewer than three (3) entries in either section. When sections are combined and there are more than 24 total entries, the sections must be divided utilizing a Floating split, or a California split to create an even division of entries.

**Awards:** Zone Horse of the Year Awards will be presented annually to the following sections:

Children's Hunter Pony - Small/Medium

Children's Hunter Pony - Large

## LOW CHILDREN'S HUNTER PONY

### Eligibility:

Open to exhibitors who have not yet reached their 18th birthday as of December 1 of the current competition year. Stallions are prohibited from all Low Children's Pony Hunter classes. Individual classes may be entered. (Exception: Under Saddle classes. See HU 129.2)

Low Children's Hunter Ponies are not required to jog for soundness.

### Cross Entry:

**Rider:** Low Children's Pony Hunter Riders may not cross enter into any class with fence heights that exceed 2'9" or into the Children's Hunter Pony, Pony Hunter, or Green Pony Hunter Section at the same competition.

**Pony:** Ponies exhibiting in the Low Children's Hunter Pony may cross enter into any class where otherwise eligible.

**Horse and Rider Combination:** The Rider may not show the same pony in the Regular Small, Medium or Large Pony, Green Pony Hunter and/or Children's Hunter Pony sections. A pony may only be shown by one rider in the Low Children's Hunter Pony Division. In the Low Children's Hunter Pony Classic, the Classic rider must be declared prior to the first round of the Classic.

### Fence Height:

2'0"

### Combining/Dividing Sections:

**Combining:** If there are fewer than three (3) ponies in the Low Children's Hunter Pony section, they may combine with the Children's Hunter Pony Section.

**Dividing:** Low Children's Hunter Pony may be divided if there are more than 20 entries in the Division.

**Awards:** Zone Horse of the Year Awards will be presented annually to the following sections:

Low Children's Hunter Pony

## JUNIOR JUMPER

### Sections offered and requirements:

1.00m/1.05m Junior Jumpers

1.10m/1.15m Junior Jumpers

### Cross Entry:

Competition Management may restrict cross entries between 1.10m/1.15m and 1.00m/1.05m sections at the same competition if stated in the prize list.

**Rider:** Any competitor that competes in any class set at over 1.25m is ineligible to compete in an Junior Jumper class set below 1.20m at that competition.

**Horse and Rider Combinations:** 1.00m/1.05m Junior Jumper horse/rider combinations may not cross enter into any classes held above 1.15m at the same show. 1.00m/1.05m Junior Jumper horse/rider combinations may enter only one classic, if both 1.00m/1.05m and 1.10m/1.15m are offered.

1.10m/1.15m Junior Jumper horse/rider combinations are not permitted to cross enter into Junior Jumper classes or any class at 1.20m and above, that offers prize money, at the same competition. 1.10m/1.15m Junior Jumper horse/rider combinations may enter only one classic, if both 1.00m/1.05m and 1.10m/1.15m are offered.

### Fence Height:

Junior Jumper 1.00m to 1.05m

Junior Jumper 1.10m to 1.15m

### Combining/Dividing Sections:

1.00m/1.05m Junior and 1.10m/1.15m Junior Jumper sections may be divided or combined with 1.00m/1.05m Amateur Jumper and the 1.10m/1.15m Amateur Jumper sections, at management's discretion, if so stated in the prize list.

**Awards:** Zone Horse of the Year Awards will be presented annually to the following sections:

1.00m/1.05m Junior Jumper

1.10m/1.15m Junior Jumper

## AGE GROUP EQUITATION: CHILDREN'S/JUNIOR SECTION

### Sections offered:

- Equitation 11 & Under
- Equitation 12-14
- Equitation 15-17

### Cross Entry:

No cross entry restrictions.

### Fence Height:

#### Equitation 11 & Under

- Minimum 2'0", maximum 2'6" - management must state height at which class will be offered.
- Management may offer multiple height options if stated in the prize list, but each course must be set at the same height throughout.
- Course design must comply with EQ108 and 109, combinations not permitted.

#### Equitation 12-14

- Minimum 2'9", maximum 3'3" - management must state height at which class will be offered.
- Management may offer multiple height options if stated in the prize list, but each course must be set at the same height throughout.
- Course design must comply with EQ108 and 109, except combination is optional.

#### Equitation 15-17

- Minimum 3'0", maximum 3'6" - management must state height at which class will be offered.
- Management may offer multiple height options if stated in the prize list, but each course must be set at the same height throughout.
- Course design must comply with EQ108 and 109, except combination is required.

Spread not to exceed fence height

### Combining/Dividing Sections:

Age-Group Equitation Sections may be combined as necessary, jumping at their respective heights, to meet the three (3) entry minimum requirement for points to be awarded. Stallions are prohibited when adult equitation sections are combined with children's/junior equitation sections. EQ101.3.

**Awards:** Zone Horse of the Year Awards will be presented annually to the following sections:

- Equitation 11 & Under
- Equitation 12-14
- Equitation 15-17





## FOR MORE INFORMATION REGARDING THE FOLLOWING PROGRAMS, PLEASE CLICK ON THE LINKS BELOW:

### **Green Hunter Incentive:**

Visit [www.ushja.org/competition/hunter/green-hunter-incentive-program](http://www.ushja.org/competition/hunter/green-hunter-incentive-program) for full specifications

### **Hunter Team Challenge:**

Visit [www.ushja.org/competition/hunter/hunter-team-challenge](http://www.ushja.org/competition/hunter/hunter-team-challenge) for full specifications

### **International Hunter Derby:**

Visit [www.ushja.org/competition/hunter/international-hunter-derby](http://www.ushja.org/competition/hunter/international-hunter-derby) for full specifications

### **National Hunter Derby:**

Visit [www.ushja.org/competition/hunter/national-hunter-derby](http://www.ushja.org/competition/hunter/national-hunter-derby) for full specifications

### **Outreach:**

Visit [www.ushja.org/competition/outreach](http://www.ushja.org/competition/outreach) for full specifications

### **Pony Hunter Derby:**

Visit [www.ushja.org/competition/hunter/pony-hunter-derby](http://www.ushja.org/competition/hunter/pony-hunter-derby) for full specifications

### **World Championship Hunter Rider:**

Visit [www.ushja.org/competition/hunter/world-championship-hunter-rider-program](http://www.ushja.org/competition/hunter/world-championship-hunter-rider-program) for full specifications

### **Zone Horse of the Year Championships:**

Please check individual zone pages here: [www.ushja.org/zones-affiliates](http://www.ushja.org/zones-affiliates)

### **Zone Jumper Championships:**

Visit [www.ushja.org/competition/jumper/zone-jumper-team-championships](http://www.ushja.org/competition/jumper/zone-jumper-team-championships) for full specifications

### **1.00m/1.05m Junior/Amateur Zone Jumper Championship:**

Visit [www.ushja.org/competition/jumper/10105m-childadult-zone-jumper-championships](http://www.ushja.org/competition/jumper/10105m-childadult-zone-jumper-championships) for full specifications.

## SPECIAL CLASSES

### **3'3" Jumping Seat Medal**

Visit [www.ushja.org/competition/equitation/33-jumping-seat-medal](http://www.ushja.org/competition/equitation/33-jumping-seat-medal) for full specifications

### **3'3" Hunt Seat Medal**

Visit [www.ushja.org/competition/equitation/33-hunter-seat-medal](http://www.ushja.org/competition/equitation/33-hunter-seat-medal) for full specifications

### **Green Hunter Challenge**

Visit [www.ushja.org/competition/hunter/green-hunter-challenge](http://www.ushja.org/competition/hunter/green-hunter-challenge) for full specifications

### **Gladstone Cup Equitation Classic**

Visit [www.ushja.org/competition/equitation/gladstone-cup](http://www.ushja.org/competition/equitation/gladstone-cup) for full specifications



## WAIVER AND RELEASE OF LIABILITY, ASSUMPTION OF RISK AND INDEMNITY AGREEMENT

For and in consideration of United States Equestrian Federation, Inc. dba US Equestrian ("USEF") allowing me, the undersigned, to participate in any capacity (including as a rider, driver, handler, vaulter, longeur, lessee, owner, agent, coach, official, trainer or volunteer) in a USEF sanctioned, licensed or approved event or activity, including but not limited to equestrian clinics, practices, shows, competitions and related or incidental activities and \_\_\_\_\_ ("USEF Event" or "USEF Events"); I, for myself, and on behalf of my spouse, children, heirs and next of kin, and any legal and personal representatives, executors, administrators, successors, and assigns, hereby agree to and make the following contractual representations pursuant to this Agreement (the "Agreement"):

A. RULES AND REGULATIONS: I hereby agree that I have read, understand, and agree to be bound by all applicable Federation Bylaws, rules, and policies including the USEF Safe Sport Policy and Minor Athlete Abuse Prevention Policies (MAAPP) as published at [www.usef.org](http://www.usef.org), as amended from time to time.

B. ACKNOWLEDGMENT OF RISK: I knowingly, willingly, and voluntarily acknowledge the inherent risks associated with the sport of equestrian and know that horseback riding and related equestrian activities are inherently dangerous, and that participation in any USEF Event involves risks and dangers including, without limitation, the potential for serious bodily injury (including broken bones, head or neck injuries), sickness and disease (including communicable diseases), trauma, pain & suffering, permanent disability, paralysis and death; loss of or damage to personal property (including my mount & equipment) arising out of the unpredictable behavior of horses; exposure to extreme conditions and circumstances; accidents involving other participants, event staff, volunteers or spectators; contact or collision with other participants and horses, natural or manmade objects; adverse weather conditions; facilities issues and premises conditions; failure of protective equipment (including helmets); inadequate safety measures; participants of varying skill levels; situations beyond the immediate control of the USEF Event organizers and competition management; and other undefined, not readily foreseeable and presently unknown risks and dangers ("Risks").

### WARNING:

**Under Florida law, an equine activity sponsor or equine professional is not liable for an injury to, or the death of, a participant in equine activities resulting from the inherent risks of equine activities.**

C. ASSUMPTION OF RISK: I understand that the aforementioned Risks may be caused in whole or in part or result directly or indirectly from the negligence of my own actions or inactions, the actions or inactions of others participating in the USEF Events, or the negligent acts or omissions of the Released Parties defined below, and I hereby voluntarily and knowingly assume all such Risks and responsibility for any damages, liabilities, losses, or expenses that I incur as a result of my participation in any USEF Events. I also agree to be responsible for any injury or damage caused by me, my horse, my employees or contractors under my direction and control at any USEF Event.

D. WAIVER AND RELEASE OF LIABILITY, HOLD HARMLESS AND INDEMNITY: In conjunction with my participation in any USEF Event, I hereby release, waive and covenant not to sue, and further agree to indemnify, defend and hold harmless the following parties: USEF, USEF Recognized Affiliate Associations, the United States Olympic & Paralympic Committee (USOPC), USEF clubs, members, Event participants (including athletes/riders, coaches, trainers, judges/officials, and other personnel), the Event owner, licensee, and competition managers; the promoters, sponsors, or advertisers of any USEF Event; any charity or other beneficiary which may benefit from the USEF Event; the owners, managers, or lessors of any facilities or premises where a USEF Event may be held; and all directors, officers, employees, agents, contractors, and volunteers of any of the aforementioned parties (**Individually and Collectively, the "Released Parties" or "Event Organizers"**), with respect to any liability, claim(s), demand(s), cause(s) of action, damage(s), loss, or expense (including court costs and reasonable attorney fees) of any kind or nature ("**Liability**") which may arise out of, result from, or relate in any way to my participation in the USEF Events, including claims for Liability caused in whole or in part by the negligent acts or omissions of the Released Parties.

E. COMPLETE AGREEMENT AND SEVERABILITY CLAUSE: This Agreement represents the complete understanding between the parties regarding these issues and no oral representations, statements or inducements have been made apart from this Agreement. If any provision of this Agreement is held to be unlawful, void, or for any reason unenforceable, then that provision shall be deemed severable from this Agreement and shall not affect the validity and enforceability of any remaining provisions.

**I HAVE CAREFULLY READ THIS DOCUMENT IN ITS ENTIRETY, UNDERSTAND ALL OF ITS TERMS AND CONDITIONS, AND KNOW IT CONTAINS AN ASSUMPTION OF RISK, RELEASE AND WAIVER FROM LIABILITY, AS WELL AS A HOLD HARMLESS AND INDEMNIFICATION OBLIGATIONS.**

By signing below, that I have read, understand, and agree to be bound by all applicable Federation Bylaws, rules, and policies including the USEF Safe Sport Policy and Minor Athlete Abuse Prevention Policies (MAAPP) as published at [www.usef.org](http://www.usef.org), as amended from time to time, as well as all terms and provisions of this Prize List. If, despite this Agreement, I, or anyone on my behalf or the minor's behalf, makes a claim for Liability against any of the Released Parties, I will indemnify, defend and hold harmless each of the Released Parties from any such Liabilities as the result of such claim.

**The parties agree that this agreement may be electronically signed. The parties agree that the electronic signatures appearing on this agreement are the same as handwritten signatures for the purposes of validity, enforceability, and admissibility.**

☐ RIDER/DRIVER/HANDLER/VAULTER/LONGEUR ☐ OWNER ☐ TRAINER ☐ OFFICIAL ☐ STAFF ☐ VOLUNTEER ☐ COACH (IF APPLICABLE)

Signature: \_\_\_\_\_ Date: \_\_\_\_\_ Print Name: \_\_\_\_\_

Parent/Guardian Signature: (Required if Rider/Driver/Handler/Vaulter/Longeur is a minor) \_\_\_\_\_ Date: \_\_\_\_\_

Print Parent//Guardian Name: \_\_\_\_\_ Emergency Contact Phone No. \_\_\_\_\_

11.16.23

USEF Competition Name: 2025 Summer Series

USEF#s:

340302

340307

Competition Division(s) and Ratings(s):

Weeks 1-3, 5-8: Premier Hunter/Level 6 Jumper

Weeks 4 & 9: National Hunter/Level 6 Jumper

340303

340308

340304

340309

340305

341383

340306



# MAAPP

## MINOR ATHLETE ABUSE PREVENTION

### LEARN ABOUT MAAP POLICIES



Safe Sport Training



Local Travel



One-On-One Interactions



Social Media & Electronic Communications



Read about these & more at [usef.org/MAAPP](https://usef.org/MAAPP)

### REPORT MAAP POLICY VIOLATIONS



[usef.org/safe-sport/reporting](https://usef.org/safe-sport/reporting)

859-225-6915 or Text Anonymously 855-682-8733





# TOP TIPS

FOR KEEPING YOUR HORSE HEALTHY

1

Avoid direct horse-to-horse contact



2

Monitor your horse for clinical signs of disease & report a temperature over 101.5°F to a veterinarian.

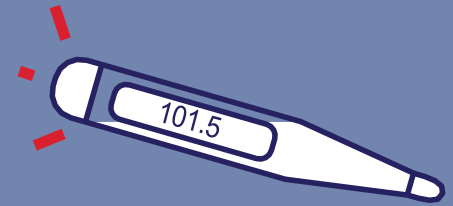

3

Avoid non-essential people touching horses



4

Avoid sharing equipment unless it is thoroughly cleaned & disinfected between uses.



5

Avoid use of communal water sources.



# THANK YOU

## FOR YOUR SUPPORT

### FOUNDING PARTNERS



### PARTNERS



### SPONSORS



TIME  
WORLD'S  
GREATEST  
PLACES

2024

# DISCOVER ONE OF THE WORLD'S GREATEST PLACES

WORLD EQUESTRIAN CENTER - OCALA



Named one of TIME's 2024 World's Greatest Places, the 378-acre World Equestrian Center resort is situated in the heart of Central Florida's rolling horse country. As the largest equestrian complex in the United States, World Equestrian Center - Ocala draws athletes and spectators from around the world to enjoy top-level competition, luxurious accommodations, gourmet dining and shopping. Future development will bring even more allure to this world-class destination. Begin your next adventure at [wec.net](http://wec.net).



**WORLD**  
EQUESTRIAN CENTER®

[equestrianhotel.com](http://equestrianhotel.com) | [wec.net](http://wec.net)  